

F.A.U. RTE.	SECTION	COUNTY	TOTAL SHEETS	SHEET NO.
1230	03-00159-00-PV	LAKE	262	81
STA. 237+00		TO STA. 248+00		
FED. ROAD DIST. NO. 1		ILLINOIS	FED. AID PROJECT	
CONTRACT: 83828				

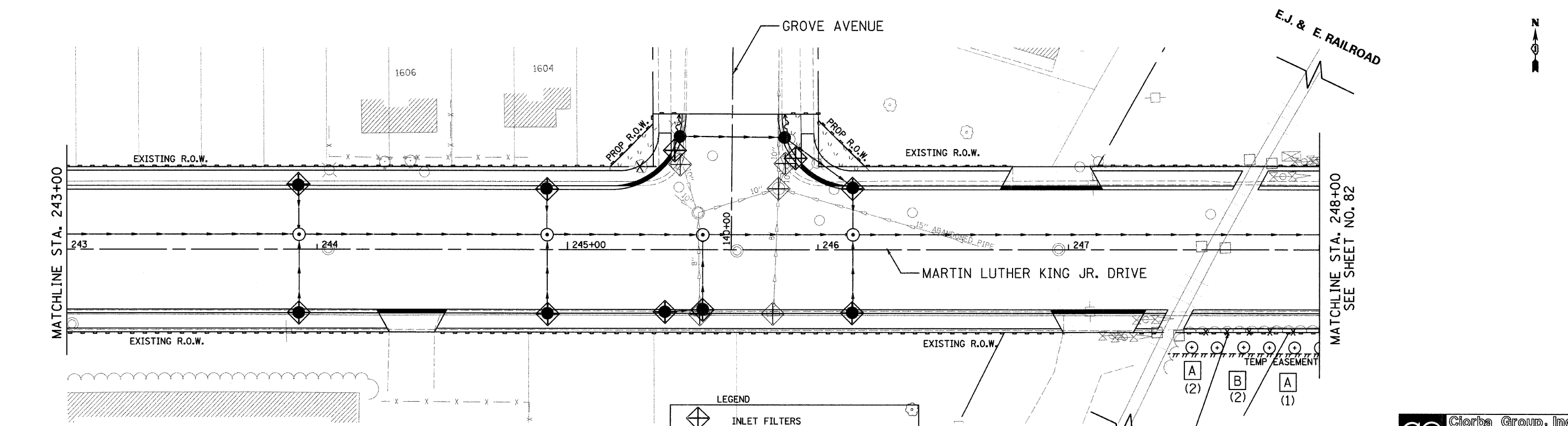
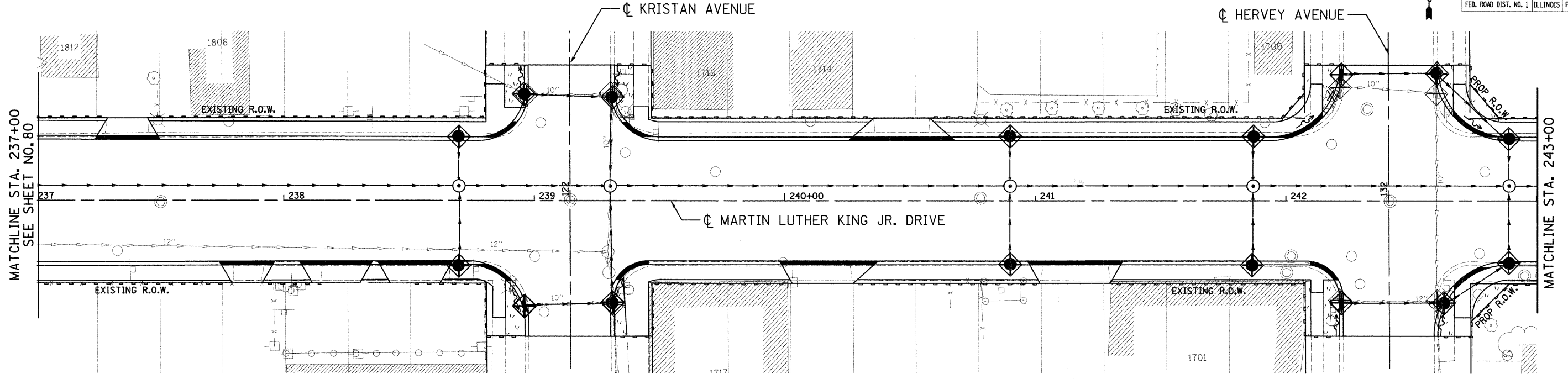

LEGEND

	INLET FILTERS
	TREE TRUNK PROTECTION
	BUSH REMOVAL (CLEARING)
	PERIMETER EROSION BARRIER
	SODDING, SALT TOLERANT

- A** T-OSTRYA VIRG 2
- B** T-QUERCUS MEUH 2

REVISIONS	
NAME	DATE

Clorba Group, Inc.
CONSULTING ENGINEERS
5507 North Cumberland Avenue, Suite 402 Chicago, Illinois 60656
Tel. 773.775.4009 Fax. 773.775.4014 Email. chicago@clorba.com

CITY OF NORTH CHICAGO
MARTIN LUTHER KING JR. DRIVE IMPROVEMENTS
MARTIN LUTHER KING JR. DRIVE
EROSION CONTROL
AND LANDSCAPING
STA. 237+00 TO 248+00

SCALE: 1"=20'
DATE: APRIL, 2008
DRAWN BY: KMS
CHECKED BY: MJL

DATE: 7/11/2008
TIME: 7:36:02 AM
FILENAME: N:\PROJ\5161\Design\Erosion\5161-ERO-04.dgn