

F.A.U. RTE.	SECTION	COUNTY	TOTAL SHEETS	SHEET NO.
1230	03-00159-00-PV	LAKE	262	87
STA. 214+00		TO STA. 219+00		
FED. ROAD DIST. NO. 1		ILLINOIS	FED. AID PROJECT	
CONTRACT: 83828				

- 11 STA. 215+75, 25' LT CB, TYPE C, 2' DIA. TYPE 23 F&G  
R<sub>L</sub> = 709.75  
INV = 705.65 (N)  
INV = 705.55 (S)
- 12 STA. 215+75, 6' LT MH, TYPE A, 4' DIA. TYPE 1 F, CL  
RIM = 710.17  
INV = 704.75 (W)  
INV = 704.45 (E)  
INV = 704.85 (S)  
INV = 705.39 (N)
- 13 STA. 215+77, 25' RT CB, TYPE C, 2' DIA. TYPE 23 F&G  
R<sub>L</sub> = 709.70  
INV = 705.13
- 14 STA. 216+01, 39' LT INLET, TYPE A TYPE 23 F&G  
R<sub>L</sub> = 709.86  
INV = 705.50
- 15 STA. 216+42, 39' LT CB, TYPE A, 4' DIA. TYPE 23 F&G  
R<sub>L</sub> = 708.64  
INV = 705.13 (W)  
INV = 704.84 (S)
- 16 STA. 216+42, 6' LT MH, TYPE A, 4' DIA. TYPE 1 F, CL  
RIM = 708.35  
INV = 702.70 (E)  
INV = 702.80 (W)  
INV = 704.56 (N)
- 17 STA. 217+72, 25' LT CB, TYPE C, 2' DIA. TYPE 23 F&G  
R<sub>L</sub> = 704.48  
INV = 700.48
- 18 STA. 217+72, 6' LT MH, TYPE A, 5' DIA. TYPE 1 F, CL  
RIM = 704.90  
INV = 699.73 (W)  
INV = 698.98 (E)  
INV = 699.83 (S)  
INV = 700.32 (N)
- 19 STA. 217+72, 25' RT CB, TYPE C, 2' DIA. TYPE 23 F&G  
R<sub>L</sub> = 704.48  
INV = 700.11

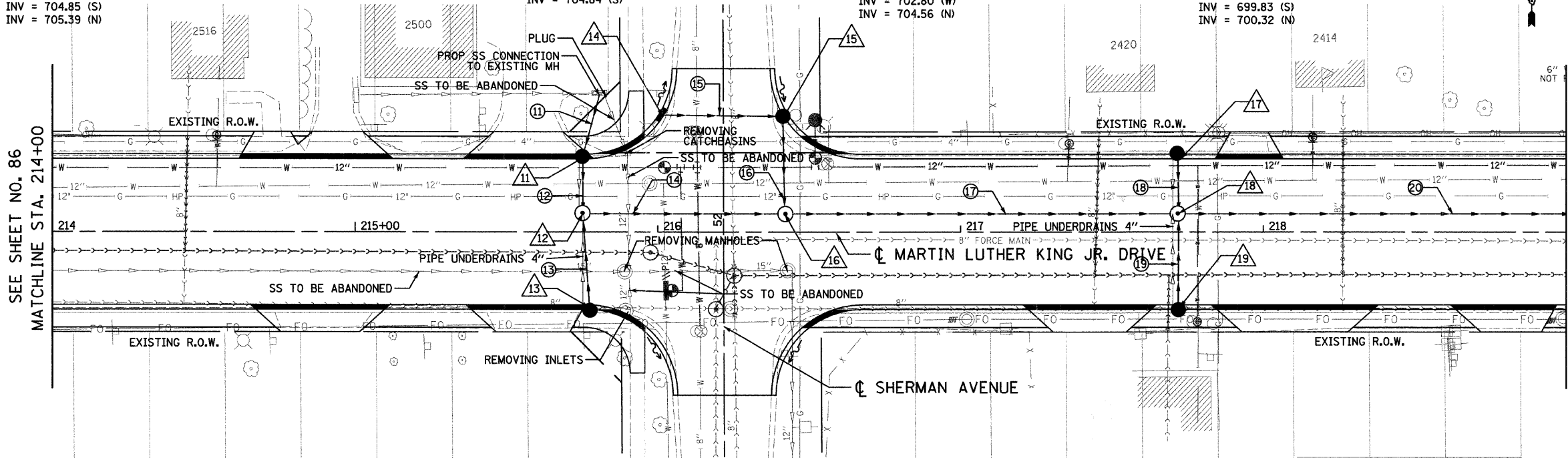

- 11 12" SS 2 RCP CL 3 21' @ 1.00% TBF = 13.1 CY
- 12 12" SS RG CL A 2 16' @ 1.00% TBF = 9.9 CY
- 13 12" SS 2 RCP CL 3 28' @ 1.00% TBF = 10.9 CY
- 14 15" SS RG CL A 2 62' @ 2.66% TBF = 45.5 CY
- 15 12" SS 1 RCP CL 4 37' @ 1.00% TBF = 10.4 CY
- 16 12" SS RG CL A 1 28' @ 1.00% TBF = 7.5 CY
- 17 15" SS 2 RCP CL 3 125' @ 2.38% TBF = 86.9 CY
- 18 12" SS RG CL A 2 16' @ 1.00% TBF = 5.9 CY
- 19 12" SS 2 RCP CL 3 28' @ 1.00% TBF = 10.2 CY
- 20 24" SS 1 RCP CL 4 126' @ 0.52% TBF = 83.3 CY

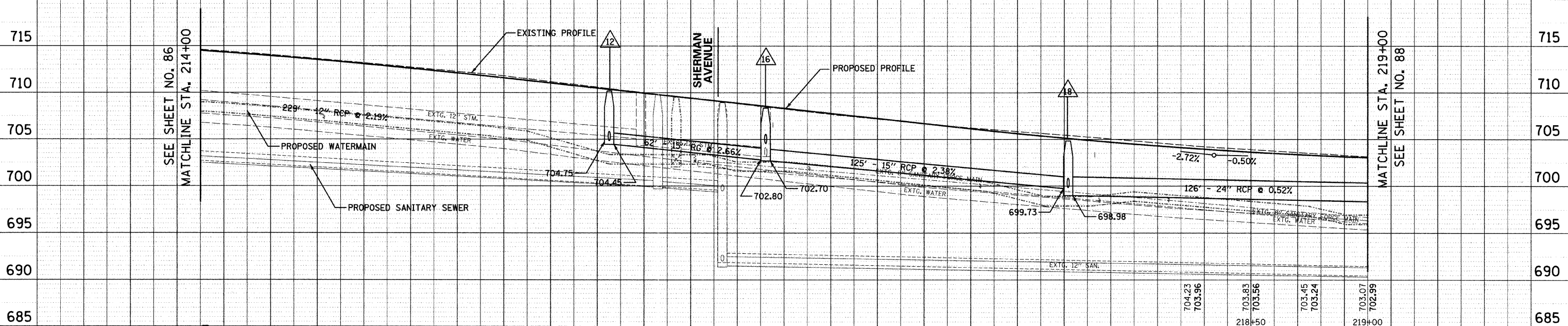
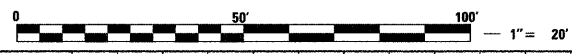

STATION	EXISTING ELEVATION	PROPOSED ELEVATION
214+00	714.53	714.44
214+50	714.09	713.96
215+00	713.54	713.45
215+50	712.99	712.89
216+00	712.43	712.29
216+50	711.87	711.64
217+00	711.12	710.97
217+50	710.37	710.29
218+00	709.64	709.61
218+50	708.90	708.83
219+00	708.19	708.25
219+50	707.49	707.57
220+00	706.88	706.89
220+50	706.27	706.22
221+00	705.78	705.65
221+50	705.30	704.95
222+00	704.77	704.42

REVISIONS	
NAME	DATE

**Clorba Group, Inc.**  
CONSULTING ENGINEERS  
5507 North Cumberland Avenue, Suite 402 Chicago, Illinois 60656  
Tel. 773.775.4009 Fax 773.775.4014 Email chicago@clorba.com

CITY OF NORTH CHICAGO  
MARTIN LUTHER KING JR. DRIVE IMPROVEMENTS  
MARTIN LUTHER KING JR. DRIVE  
PROPOSED STORM SEWER  
PLAN AND PROFILE  
STA. 214+00 TO 219+00

SCALE: 1"=20'  
DATE: APRIL, 2008  
DRAWN BY: KMS  
CHECKED BY: MJL

DATE: 7/1/2008  
FILENAME: N:\PROJ\0518\Design\Drawings\6161-DRN-03.dgn

PLAN: SURVEYED, PLOTTED, CHECKED, ALIGNED, CADD FILE NAME

PROFILE: SURVEYED, PLOTTED, CHECKED, GRADES CHECKED, STRUCTURE NOTATIONS OK'D