

| | | | | |
|-----------------------|----------------|------------------|-----------------|-----------|
| F.A.U. RTE. | SECTION | COUNTY | TOTAL SHEETS | SHEET NO. |
| 1230 | 03-00159-00-PV | LAKE | 262 | 110 |
| STA. 260+00 | TO STA. 266+00 | | | |
| FED. ROAD DIST. NO. 1 | ILLINOIS | FED. AID PROJECT | CONTRACT: 83828 | |

| | |
|------|------|
| PLAN | DATE |
| NO. | BY |
| NO. | DATE |
| NO. | DATE |
| NO. | DATE |

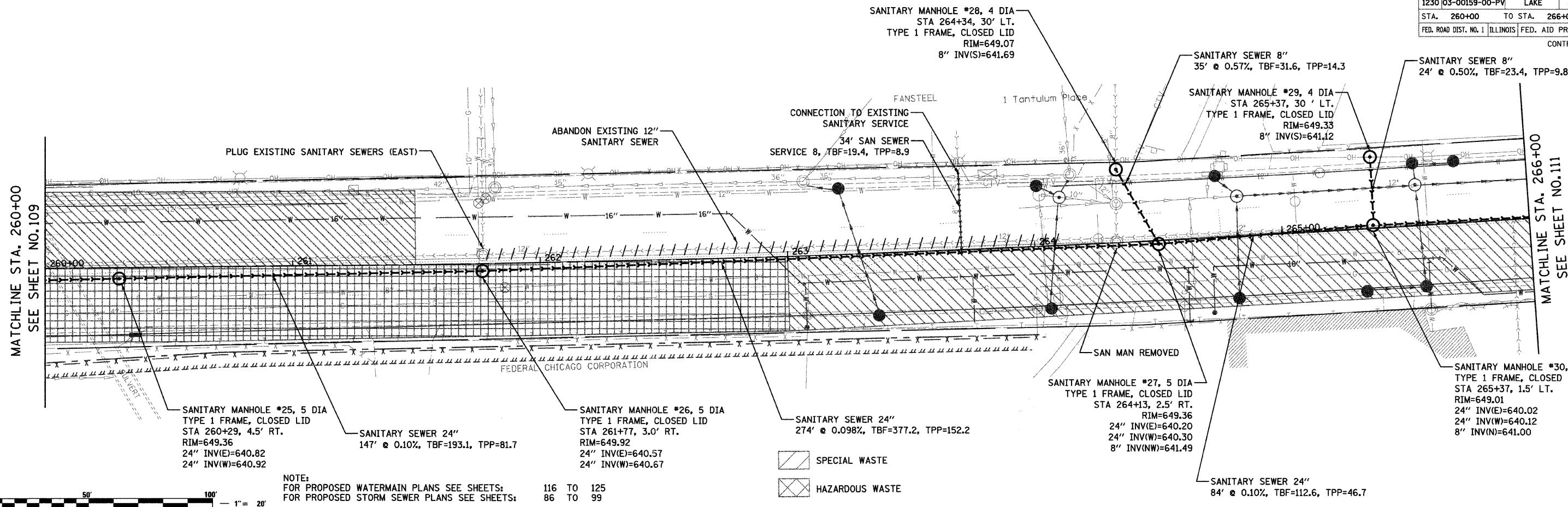

| | |
|---------|------|
| PROFILE | DATE |
| NO. | BY |
| NO. | DATE |
| NO. | DATE |
| NO. | DATE |

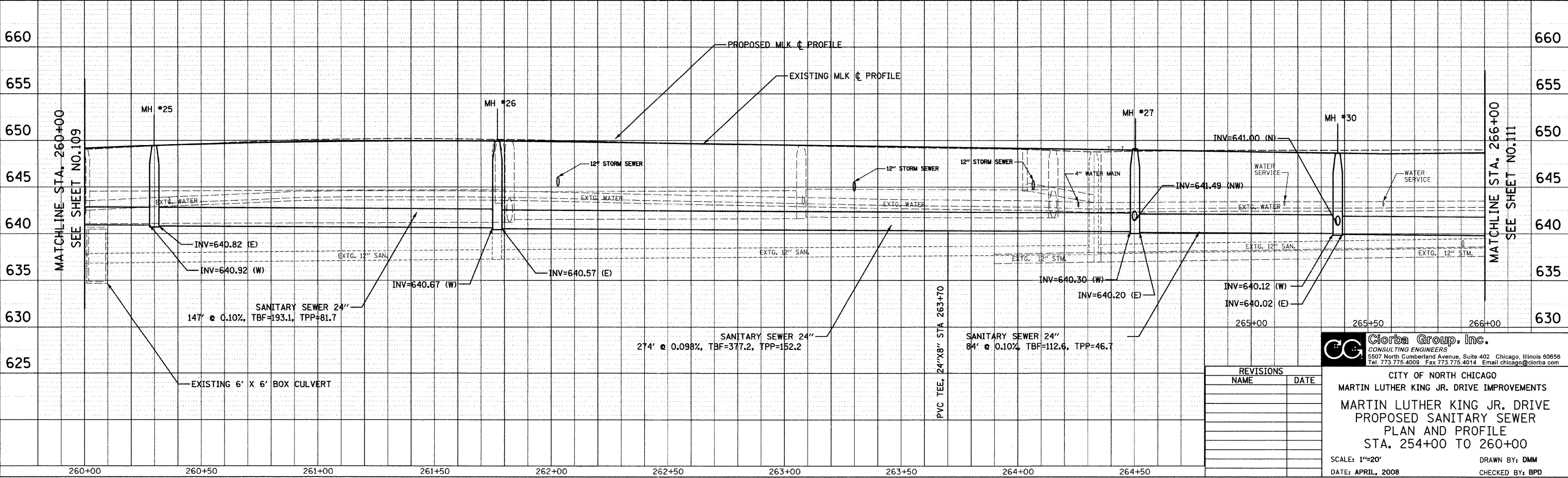

| REVISIONS | |
|-----------|------|
| NAME | DATE |
| | |
| | |
| | |
| | |

Clorba Group, Inc.
 CONSULTING ENGINEERS
 5507 North Cumberland Avenue, Suite 402 Chicago, Illinois 60656
 Tel. 773.775.4009 Fax 773.775.4014 Email chicago@clorba.com

CITY OF NORTH CHICAGO
 MARTIN LUTHER KING JR. DRIVE IMPROVEMENTS
 MARTIN LUTHER KING JR. DRIVE
 PROPOSED SANITARY SEWER
 PLAN AND PROFILE
 STA. 254+00 TO 260+00

SCALE: 1"=20'
 DATE: APRIL, 2008
 DRAWN BY: DMM
 CHECKED BY: BPD

DATE: 7/1/2008
 TIME: 10:09 AM
 FILENAME: N:\PROJ\05161\Design\Sanitary\PSAN11.dgn