

F.A.U. RTE.	SECTION	COUNTY	TOTAL SHEETS	SHEET NO.
1230	03-00159-00-PV	LAKE	262	125
STA. 260+00		TO STA. 266+00		
FED. ROAD DIST. NO. 1		ILLINOIS	FED. AID PROJECT	

CONTRACT: 83828

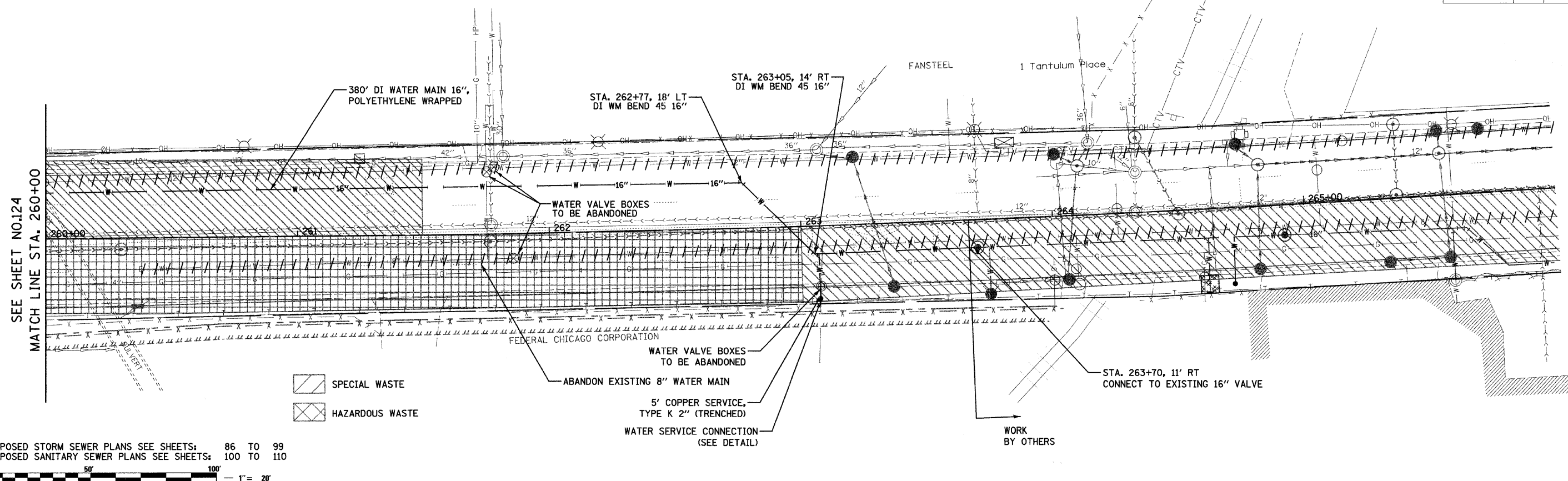

PLAN	REVISIONS	DATE
NO.	NO.	
NO.	NO.	
NO.	NO.	



NOTE:
 FOR PROPOSED STORM SEWER PLANS SEE SHEETS: 86 TO 99
 FOR PROPOSED SANITARY SEWER PLANS SEE SHEETS: 100 TO 110

PROFILE	REVISIONS	DATE
NO.	NO.	
NO.	NO.	
NO.	NO.	

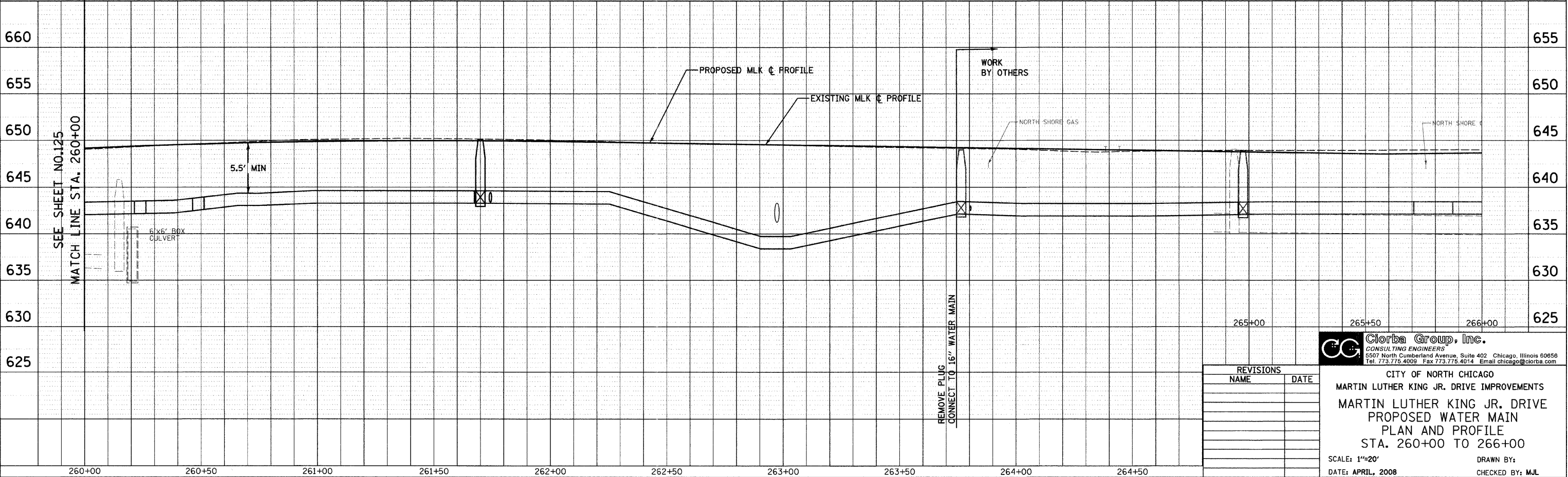

REVISIONS	
NAME	DATE

Clorba Group, Inc.
 CONSULTING ENGINEERS
 5507 North Cumberland Avenue, Suite 402 Chicago, Illinois 60656
 Tel. 773.776.4009 Fax 773.776.4014 Email chicago@clorba.com

CITY OF NORTH CHICAGO
 MARTIN LUTHER KING JR. DRIVE IMPROVEMENTS
 MARTIN LUTHER KING JR. DRIVE
 PROPOSED WATER MAIN
 PLAN AND PROFILE
 STA. 260+00 TO 266+00

SCALE: 1"=20'
 DATE: APRIL, 2008

DRAWN BY:
 CHECKED BY: MJL

DATE: 7/1/2008
 TIME: 8:02:57 AM
 FILENAME: N:\PROJECTS\181\Design\water main\PIWAT11.dgn