

DATE: 7/11/2008 TIME: 3:28:11 PM

FILENAME: N:\PROJ151611\Design\Xsections\15161-mk-sheet.dgn

FINAL SURVEY NO.	SURVEYED	BY	DATE
	PLOTTED		
	TEMPLATE		
	NOTE BOOK		
	AREAS CHECKED		

ORIGINAL SURVEY NO.	SURVEYED	BY	DATE
	PLOTTED		
	TEMPLATE		
	NOTE BOOK		
	AREAS CHECKED		

F.A. RTE.	SECTION	COUNTY	TOTAL SHEETS	SHEET NO.
1230	03-00159-00-PV	LAKE	262	224
STA. 225+59.65		TO STA. 227+00		
FED. ROAD DIST. NO. 1		ILLINOIS		FED. AID PROJECT
		CONTRACT: 83828		

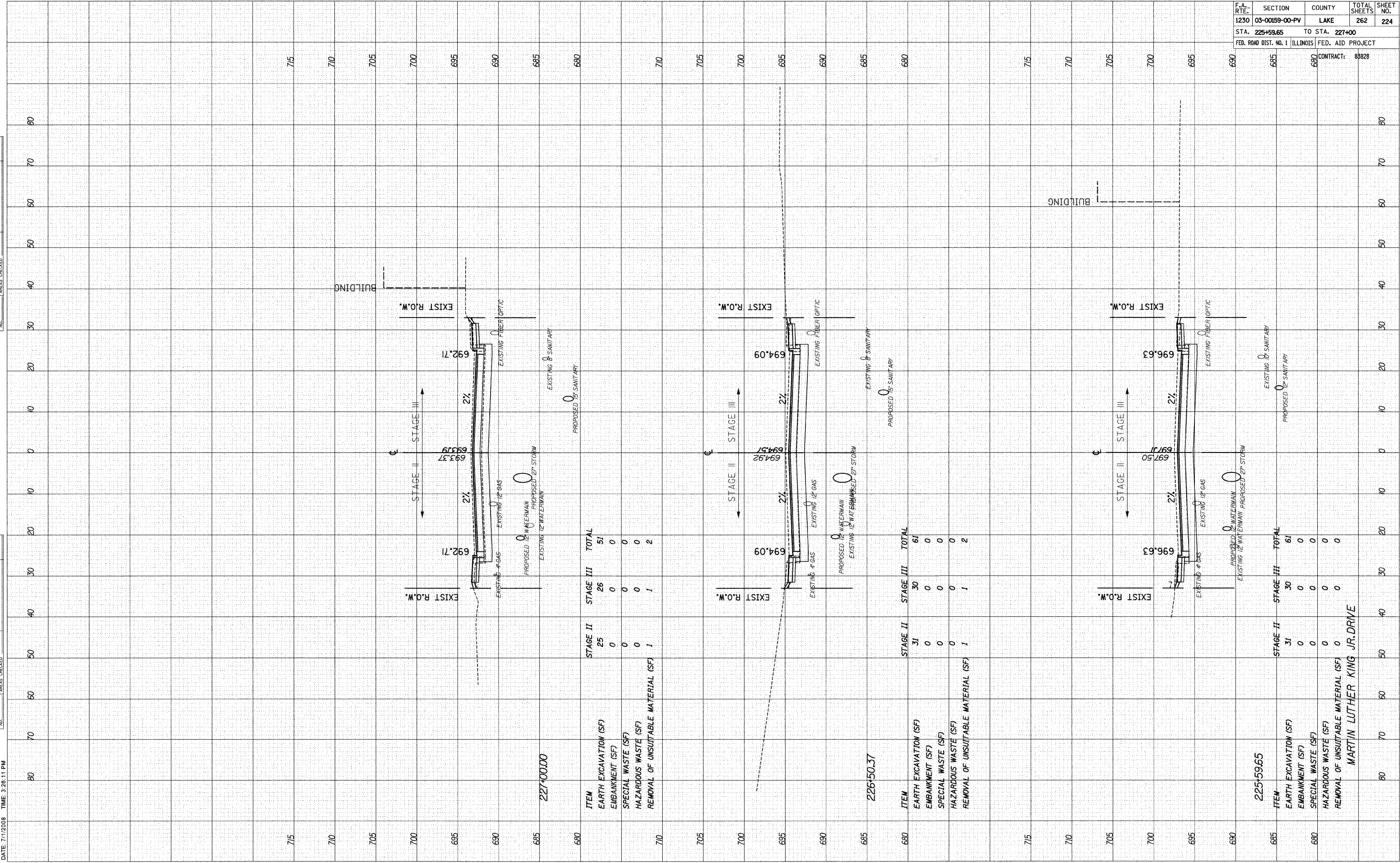

227+00.00

ITEM	STAGE II	STAGE III	TOTAL
EARTH EXCAVATION (SF)	25	26	51
EMBANKMENT (SF)	0	0	0
SPECIAL WASTE (SF)	0	0	0
HAZARDOUS WASTE (SF)	0	0	0
REMOVAL OF UNSUITABLE MATERIAL (SF)	1	1	2

226+50.37

ITEM	STAGE II	STAGE III	TOTAL
EARTH EXCAVATION (SF)	31	30	61
EMBANKMENT (SF)	0	0	0
SPECIAL WASTE (SF)	0	0	0
HAZARDOUS WASTE (SF)	0	0	0
REMOVAL OF UNSUITABLE MATERIAL (SF)	1	1	2

225+59.65

ITEM	STAGE II	STAGE III	TOTAL
EARTH EXCAVATION (SF)	31	30	61
EMBANKMENT (SF)	0	0	0
SPECIAL WASTE (SF)	0	0	0
HAZARDOUS WASTE (SF)	0	0	0
REMOVAL OF UNSUITABLE MATERIAL (SF)	0	0	0

MARTIN LUTHER KING JR. DRIVE