

DATE: 7/1/2008 TIME: 3:29:11 PM

FILENAME: N:\PROJ\5161\Design\Xsections\5161-mik-sheet.dgn

FINAL SURVEY	SURVEYED	DATE
NOTE BOOK	PLOTTED	
NO.	DATE	
	AREAS CHECKED	

ORIGINAL SURVEY	SURVEYED	DATE
NOTE BOOK	PLOTTED	
NO.	DATE	
	AREAS CHECKED	

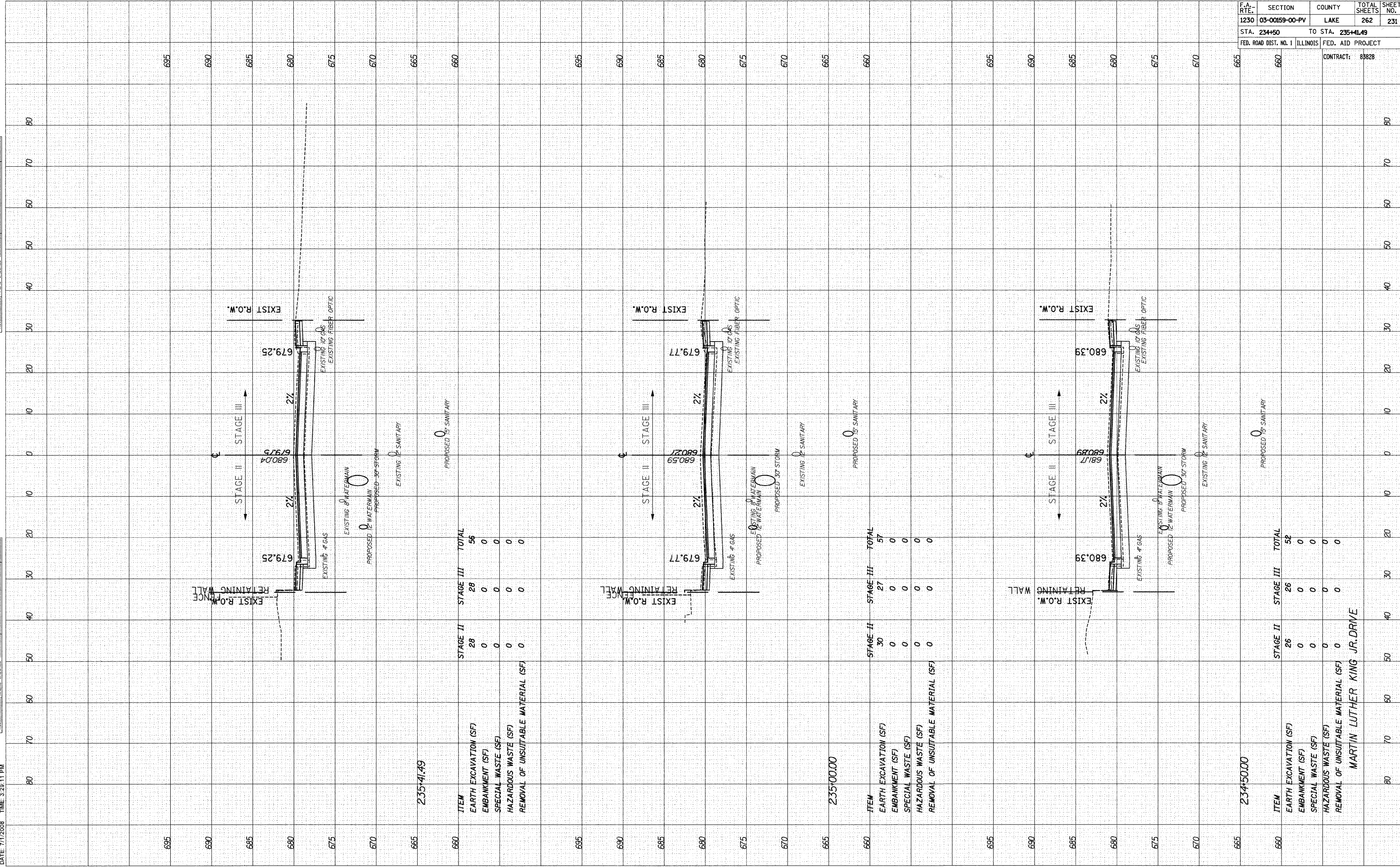

665	235+41.49								
660	ITEM	STAGE II	STAGE III	TOTAL					
	EARTH EXCAVATION (SF)	28	28	56					
	EMBANKMENT (SF)	0	0	0					
	SPECIAL WASTE (SF)	0	0	0					
	HAZARDOUS WASTE (SF)	0	0	0					
	REMOVAL OF UNSUITABLE MATERIAL (SF)	0	0	0					

665	235+00.00								
660	ITEM	STAGE II	STAGE III	TOTAL					
	EARTH EXCAVATION (SF)	30	27	57					
	EMBANKMENT (SF)	0	0	0					
	SPECIAL WASTE (SF)	0	0	0					
	HAZARDOUS WASTE (SF)	0	0	0					
	REMOVAL OF UNSUITABLE MATERIAL (SF)	0	0	0					

665	234+50.00								
660	ITEM	STAGE II	STAGE III	TOTAL					
	EARTH EXCAVATION (SF)	26	26	52					
	EMBANKMENT (SF)	0	0	0					
	SPECIAL WASTE (SF)	0	0	0					
	HAZARDOUS WASTE (SF)	0	0	0					
	REMOVAL OF UNSUITABLE MATERIAL (SF)	0	0	0					

F.A. RTE.	SECTION	COUNTY	TOTAL SHEETS	SHEET NO.
1230	03-00159-00-PV	LAKE	262	231
STA. 234+50		TO STA. 235+41.49		
FED. ROAD DIST. NO. 1		ILLINOIS		FED. AID PROJECT
				CONTRACT: 85828

MARTIN LUTHER KING JR. DRIVE