

DATE: 7/1/2008 TIME: 3:29:58 PM

FILENAME: N:\PROJ\15161\Design\Xsections\15161-mk-sheet.dgn

BY: _____
 DATE: _____
 SURVEYED: _____
 PLOTTED: _____
 NOTE BOOK: _____
 AREAS CHECKED: _____

BY: _____
 DATE: _____
 ORIGINAL SURVEY: _____
 PLOTTED: _____
 NOTE BOOK: _____
 AREAS CHECKED: _____

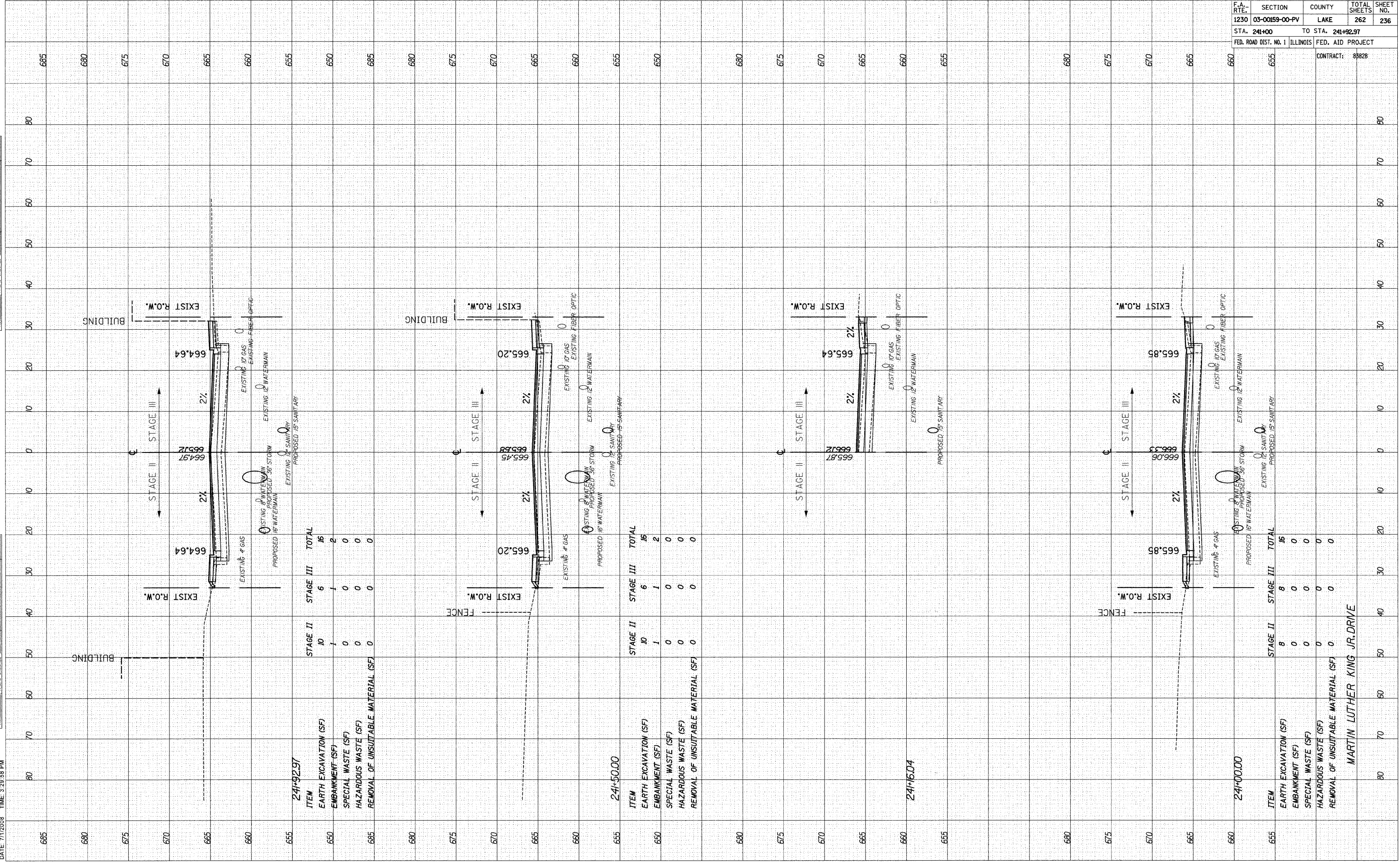

241+92.97

ITEM	STAGE II	STAGE III	TOTAL
EARTH EXCAVATION (SF)	10	6	16
EMBANKMENT (SF)	1	1	2
SPECIAL WASTE (SF)	0	0	0
HAZARDOUS WASTE (SF)	0	0	0
REMOVAL OF UNSUITABLE MATERIAL (SF)	0	0	0

241+50.00

ITEM	STAGE II	STAGE III	TOTAL
EARTH EXCAVATION (SF)	10	6	16
EMBANKMENT (SF)	1	1	2
SPECIAL WASTE (SF)	0	0	0
HAZARDOUS WASTE (SF)	0	0	0
REMOVAL OF UNSUITABLE MATERIAL (SF)	0	0	0

241+00.00

ITEM	STAGE II	STAGE III	TOTAL
EARTH EXCAVATION (SF)	8	8	16
EMBANKMENT (SF)	0	0	0
SPECIAL WASTE (SF)	0	0	0
HAZARDOUS WASTE (SF)	0	0	0
REMOVAL OF UNSUITABLE MATERIAL (SF)	0	0	0

MARTIN LUTHER KING JR. DRIVE

F.A. RTE.	SECTION	COUNTY	TOTAL SHEETS	SHEET NO.
1230	03-00159-00-PV	LAKE	262	236
STA. 241+00		TO STA. 241+92.97		
FED. ROAD DIST. NO. 1		ILLINOIS		FED. AID PROJECT
CONTRACT: 88828				