

DATE: 6/15/2008 TIME: 3:30:09 PM

BY: _____ DATE: _____
 SURVEYED _____
 PLOTTED _____
 NOTE BOOK _____
 AREAS CHECKED _____

BY: _____ DATE: _____
 SURVEYED _____
 PLOTTED _____
 NOTE BOOK _____
 AREAS CHECKED _____

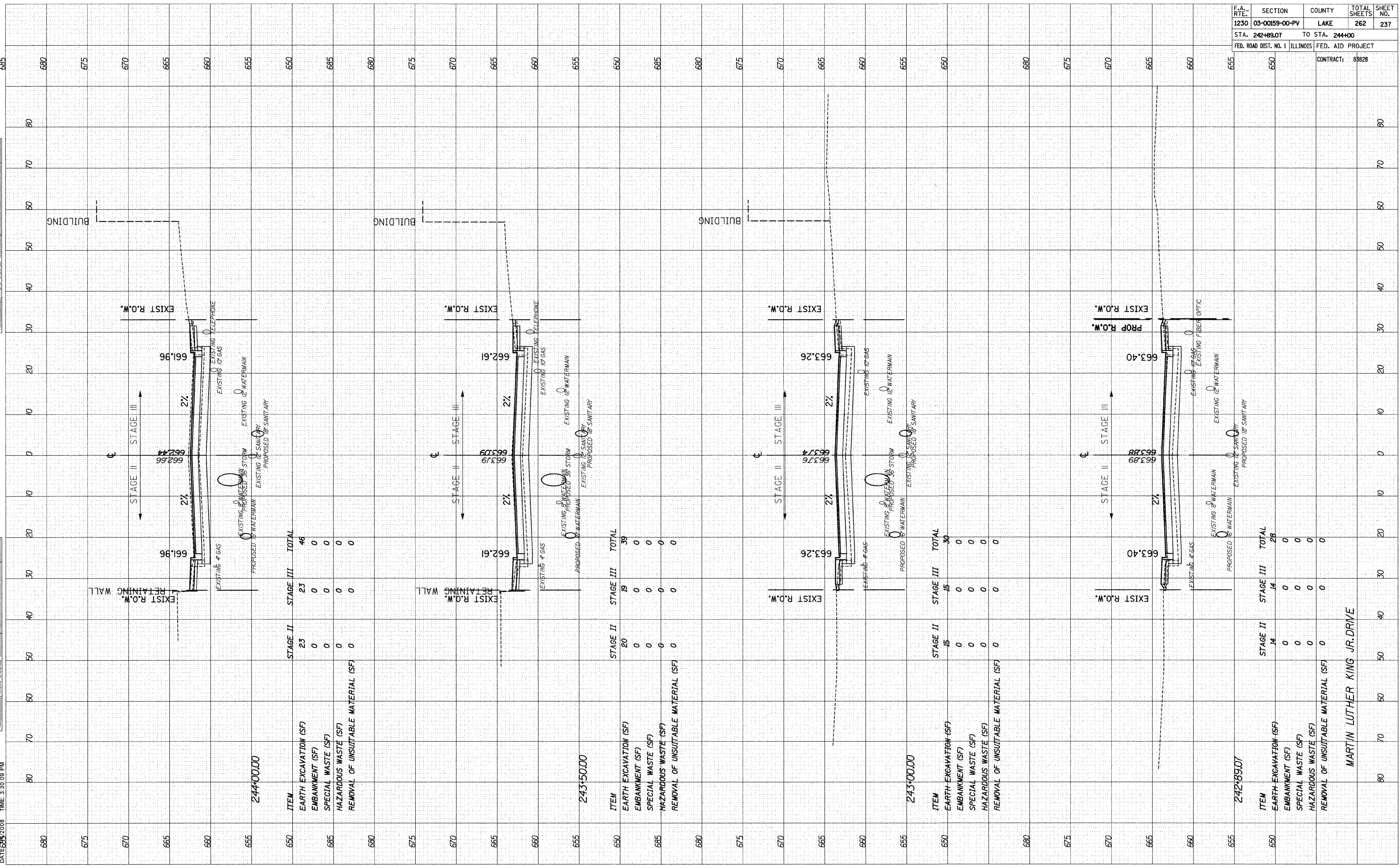

244+00.00

ITEM	STAGE II	STAGE III	TOTAL
EARTH EXCAVATION (SF)	23	23	46
EMBANKMENT (SF)	0	0	0
SPECIAL WASTE (SF)	0	0	0
HAZARDOUS WASTE (SF)	0	0	0
REMOVAL OF UNSUITABLE MATERIAL (SF)	0	0	0

243+50.00

ITEM	STAGE II	STAGE III	TOTAL
EARTH EXCAVATION (SF)	20	19	39
EMBANKMENT (SF)	0	0	0
SPECIAL WASTE (SF)	0	0	0
HAZARDOUS WASTE (SF)	0	0	0
REMOVAL OF UNSUITABLE MATERIAL (SF)	0	0	0

243+00.00

ITEM	STAGE II	STAGE III	TOTAL
EARTH EXCAVATION (SF)	15	15	30
EMBANKMENT (SF)	0	0	0
SPECIAL WASTE (SF)	0	0	0
HAZARDOUS WASTE (SF)	0	0	0
REMOVAL OF UNSUITABLE MATERIAL (SF)	0	0	0

242+99.07

ITEM	STAGE II	STAGE III	TOTAL
EARTH EXCAVATION (SF)	14	14	28
EMBANKMENT (SF)	0	0	0
SPECIAL WASTE (SF)	0	0	0
HAZARDOUS WASTE (SF)	0	0	0
REMOVAL OF UNSUITABLE MATERIAL (SF)	0	0	0

MARTIN LUTHER KING JR. DRIVE

F.A. RTE.	SECTION	COUNTY	TOTAL SHEETS	SHEET NO.
1230	03-00159-00-PV	LAKE	262	237
STA. 242+89.07		TO STA. 244+00		
FED. ROAD DIST. NO. 1		ILLINOIS FED. AID PROJECT		
		CONTRACT: 88828		