

ORIGINAL SURVEY	SURVEYED	DATE
NOTE BOOK	PLOTTED	
NO.	AREAS	CHECKED

FINAL SURVEY	SURVEYED	DATE
NOTE BOOK	PLOTTED	
NO.	AREAS	CHECKED

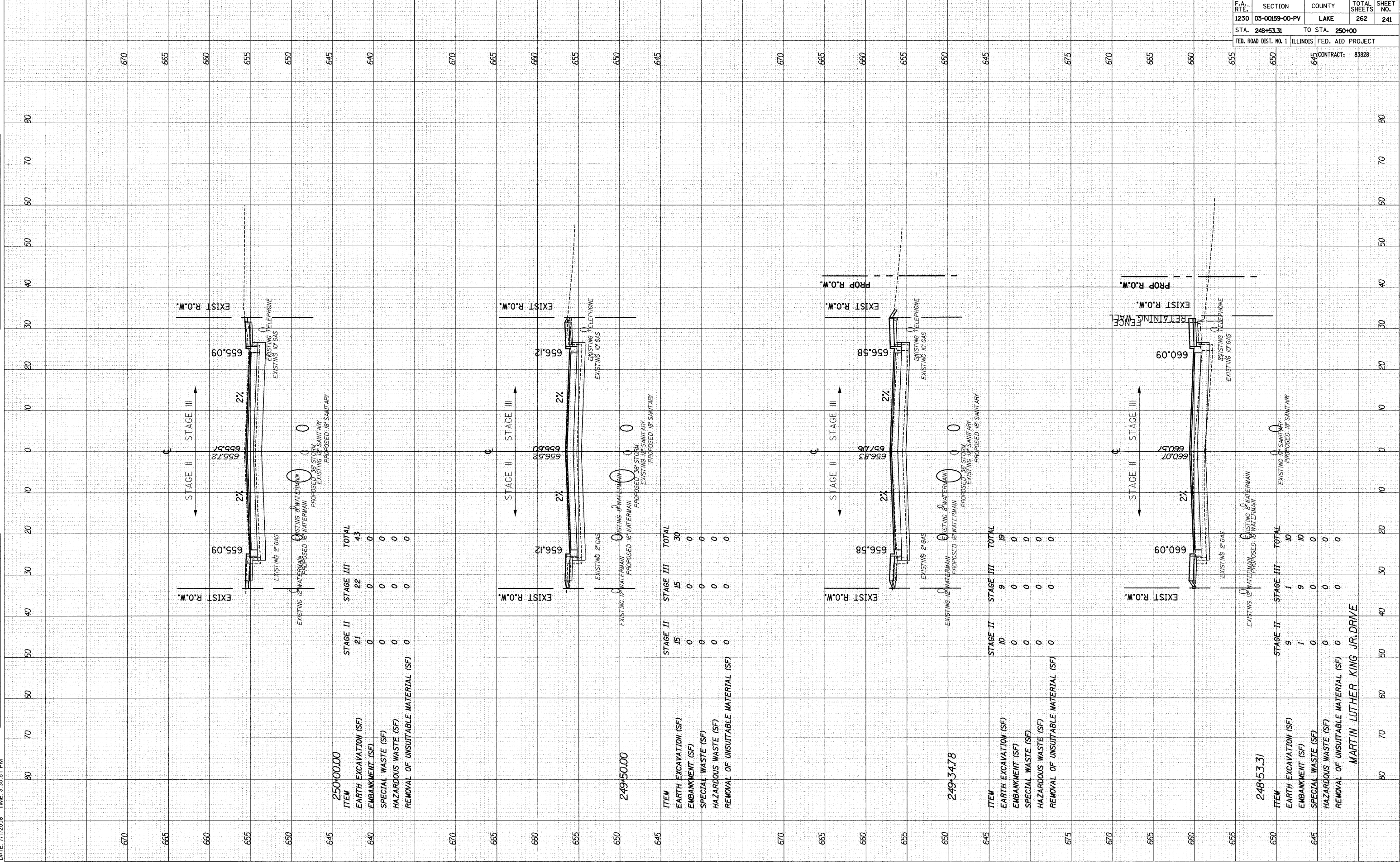

250+00.00	STAGE II	STAGE III	TOTAL
EARTH EXCAVATION (SF)	21	22	43
EMBANKMENT (SF)	0	0	0
SPECIAL WASTE (SF)	0	0	0
HAZARDOUS WASTE (SF)	0	0	0
REMOVAL OF UNSUITABLE MATERIAL (SF)	0	0	0

249+50.00	STAGE II	STAGE III	TOTAL
EARTH EXCAVATION (SF)	15	15	30
EMBANKMENT (SF)	0	0	0
SPECIAL WASTE (SF)	0	0	0
HAZARDOUS WASTE (SF)	0	0	0
REMOVAL OF UNSUITABLE MATERIAL (SF)	0	0	0

249+34.78	STAGE II	STAGE III	TOTAL
EARTH EXCAVATION (SF)	10	9	19
EMBANKMENT (SF)	0	0	0
SPECIAL WASTE (SF)	0	0	0
HAZARDOUS WASTE (SF)	0	0	0
REMOVAL OF UNSUITABLE MATERIAL (SF)	0	0	0

248+53.31	STAGE II	STAGE III	TOTAL
EARTH EXCAVATION (SF)	9	1	10
EMBANKMENT (SF)	1	9	10
SPECIAL WASTE (SF)	0	0	0
HAZARDOUS WASTE (SF)	0	0	0
REMOVAL OF UNSUITABLE MATERIAL (SF)	0	0	0

MARTIN LUTHER KING JR. DRIVE

F.A. RT.:	SECTION	COUNTY	TOTAL SHEETS	SHEET NO.
1230	03-00159-00-PV	LAKE	262	241
STA. 248+53.31	TO STA. 250+00			
FED. ROAD DIST. NO. 1	ILLINOIS	FED. AID PROJECT		
CONTRACT:			85828	