

DATE: 7/11/2008 TIME: 4:24:58 PM

FILENAME: N:\PROJ\61611\Design\Xsections\61611-comm-sheet.dgn

FINAL SURVEY	SURVEYED	BY	DATE
NOTE BOOK	PLOTTED		
NO.	DATE		
	AREAS		
	CHECKED		

ORIGINAL SURVEY	SURVEYED	BY	DATE
NOTE BOOK	PLOTTED		
NO.	DATE		
	AREAS		
	CHECKED		

F.A. STA.	SECTION	COUNTY	TOTAL SHEETS	SHEET NO.
1230	03-00159-00-PV	LAKE	262	257
TO STA.		FED. AID PROJECT		
FED. ROAD DIST. NO. 1 ILLINOIS		CONTRACT: 85828		

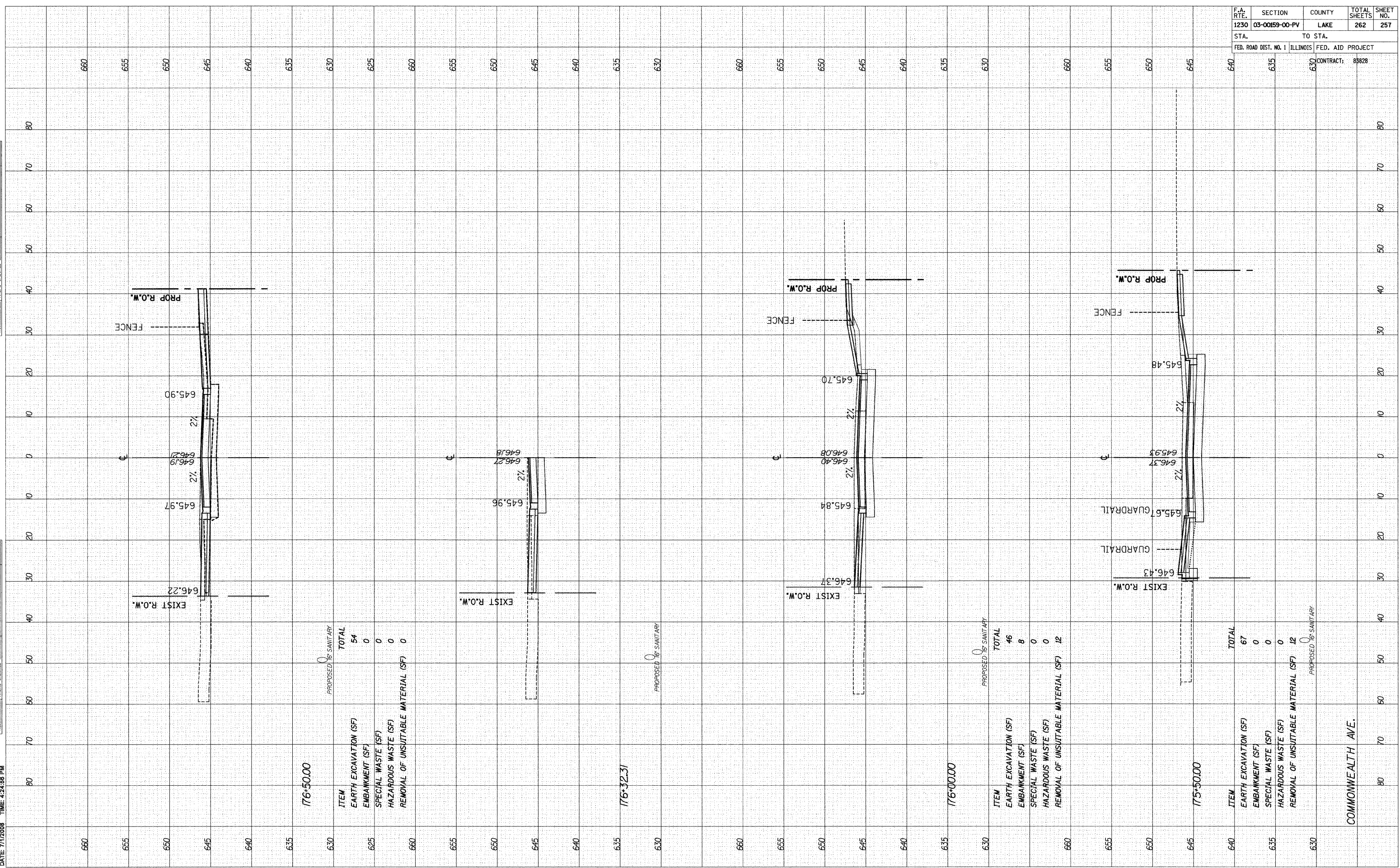

776+50.00

ITEM	PROPOSED 'B' SANITARY	TOTAL
EARTH EXCAVATION (SF)	54	54
EMBANKMENT (SF)	0	0
SPECIAL WASTE (SF)	0	0
HAZARDOUS WASTE (SF)	0	0
REMOVAL OF UNSUITABLE MATERIAL (SF)	0	0

776+32.31

ITEM	PROPOSED 'B' SANITARY	TOTAL
EARTH EXCAVATION (SF)	46	46
EMBANKMENT (SF)	8	8
SPECIAL WASTE (SF)	0	0
HAZARDOUS WASTE (SF)	0	0
REMOVAL OF UNSUITABLE MATERIAL (SF)	12	12

775+50.00

ITEM	PROPOSED 'B' SANITARY	TOTAL
EARTH EXCAVATION (SF)	67	67
EMBANKMENT (SF)	0	0
SPECIAL WASTE (SF)	0	0
HAZARDOUS WASTE (SF)	0	0
REMOVAL OF UNSUITABLE MATERIAL (SF)	12	12

COMMONWEALTH AVE.