

F.A. RTE.	SECTION	COUNTY	TOTAL SHEETS	SHEET NO.
1230	03-00159-00-PV	LAKE	262	258
STA.	TO STA.		FED. ROAD DIST. NO. 1 ILLINOIS	
	635		FED. AID PROJECT	
	CONTRACT: 88828			

BY	DATE
FINAL SURVEY	SURVEYED
NOTE BOOK	PLOTTED
NO.	TEMPLATE
	AREAS CHECKED

BY	DATE
ORIGINAL SURVEY	SURVEYED
NOTE BOOK	PLOTTED
NO.	TEMPLATE
	AREAS CHECKED

DATE: 7/12/08 TIME: 4:25:07 PM

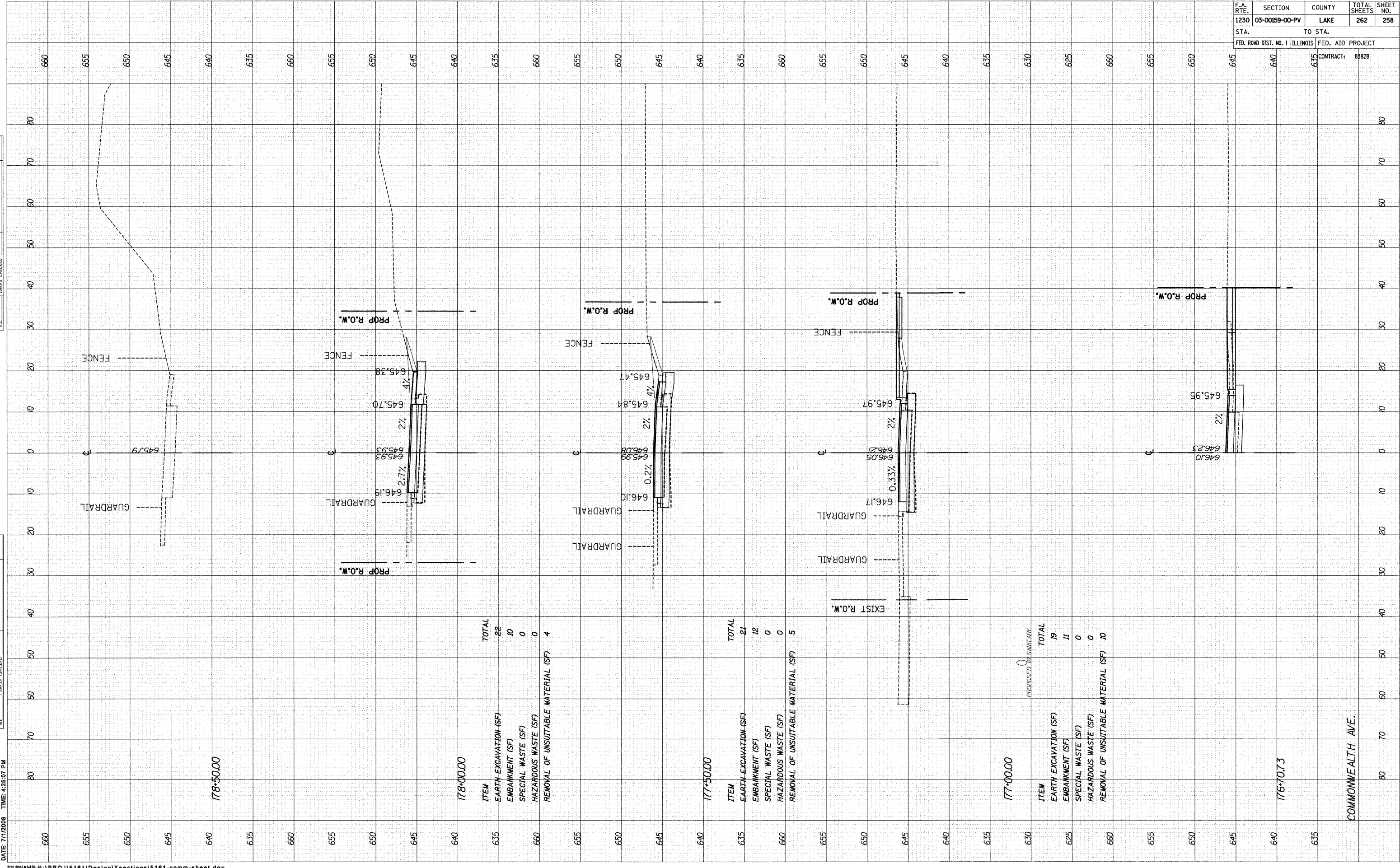

778+00.00

ITEM	TOTAL
EARTH EXCAVATION (SF)	22
EMBANKMENT (SF)	10
SPECIAL WASTE (SF)	0
HAZARDOUS WASTE (SF)	0
REMOVAL OF UNSUITABLE MATERIAL (SF)	4

777+50.00

ITEM	TOTAL
EARTH EXCAVATION (SF)	21
EMBANKMENT (SF)	12
SPECIAL WASTE (SF)	0
HAZARDOUS WASTE (SF)	0
REMOVAL OF UNSUITABLE MATERIAL (SF)	5

777+00.00

PROPOSED 16 SANITARY

ITEM	TOTAL
EARTH EXCAVATION (SF)	19
EMBANKMENT (SF)	11
SPECIAL WASTE (SF)	0
HAZARDOUS WASTE (SF)	0
REMOVAL OF UNSUITABLE MATERIAL (SF)	10

776+00.00

COMMONWEALTH AVE.