

DATE	
BY	
PLANNED	
DESIGNED	
CHECKED	
NO. OF WAY CHECKED	
NO. OF FILE NAME	

DATE	
BY	
PROFILE	
DESIGNED	
CHECKED	
NO. OF WAY CHECKED	
NO. OF FILE NAME	

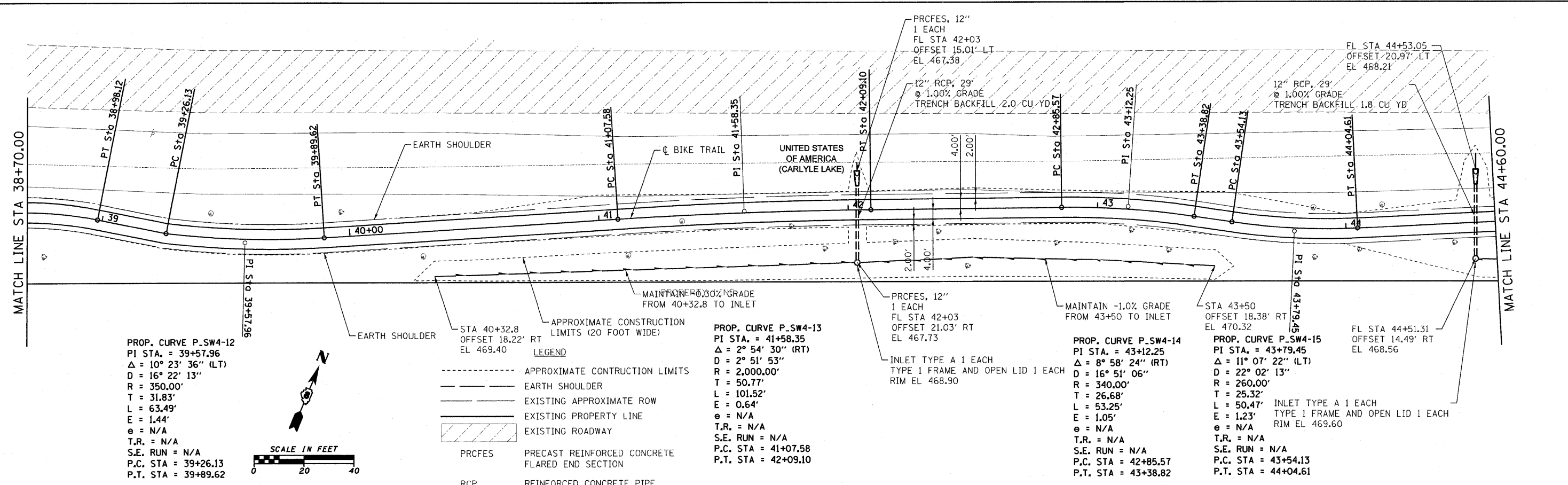

PROP. CURVE P.SW4-12  
 PI STA. = 39+57.96  
 $\Delta = 10^\circ 23' 36''$  (LT)  
 $D = 16^\circ 22' 13''$   
 $R = 350.00'$   
 $T = 31.83'$   
 $L = 63.49'$   
 $E = 1.44'$   
 $e = N/A$   
 T.R. = N/A  
 S.E. RUN = N/A  
 P.C. STA = 39+26.13  
 P.T. STA = 39+89.62

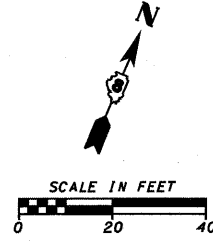

LEGEND  
 - - - - - APPROXIMATE CONSTRUCTION LIMITS  
 - - - - - EARTH SHOULDER  
 - - - - - EXISTING APPROXIMATE ROW  
 - - - - - EXISTING PROPERTY LINE  
 - - - - - EXISTING ROADWAY  
 PRCFES PRECAST REINFORCED CONCRETE FLARED END SECTION  
 RCP REINFORCED CONCRETE PIPE

PROP. CURVE P.SW4-13  
 PI STA. = 41+58.35  
 $\Delta = 2^\circ 54' 30''$  (RT)  
 $D = 2^\circ 51' 53''$   
 $R = 2,000.00'$   
 $T = 50.77'$   
 $L = 101.52'$   
 $E = 0.64'$   
 $e = N/A$   
 T.R. = N/A  
 S.E. RUN = N/A  
 P.C. STA = 41+07.58  
 P.T. STA = 42+09.10

PROP. CURVE P.SW4-14  
 PI STA. = 43+12.25  
 $\Delta = 8^\circ 58' 24''$  (RT)  
 $D = 16^\circ 51' 06''$   
 $R = 340.00'$   
 $T = 26.68'$   
 $L = 53.25'$   
 $E = 1.05'$   
 $e = N/A$   
 T.R. = N/A  
 S.E. RUN = N/A  
 P.C. STA = 42+85.57  
 P.T. STA = 43+38.82

PROP. CURVE P.SW4-15  
 PI STA. = 43+79.45  
 $\Delta = 11^\circ 07' 22''$  (LT)  
 $D = 22^\circ 02' 13''$   
 $R = 260.00'$   
 $T = 25.32'$   
 $L = 50.47'$   
 $E = 1.23'$   
 $e = N/A$   
 T.R. = N/A  
 S.E. RUN = N/A  
 P.C. STA = 43+54.13  
 P.T. STA = 44+04.61

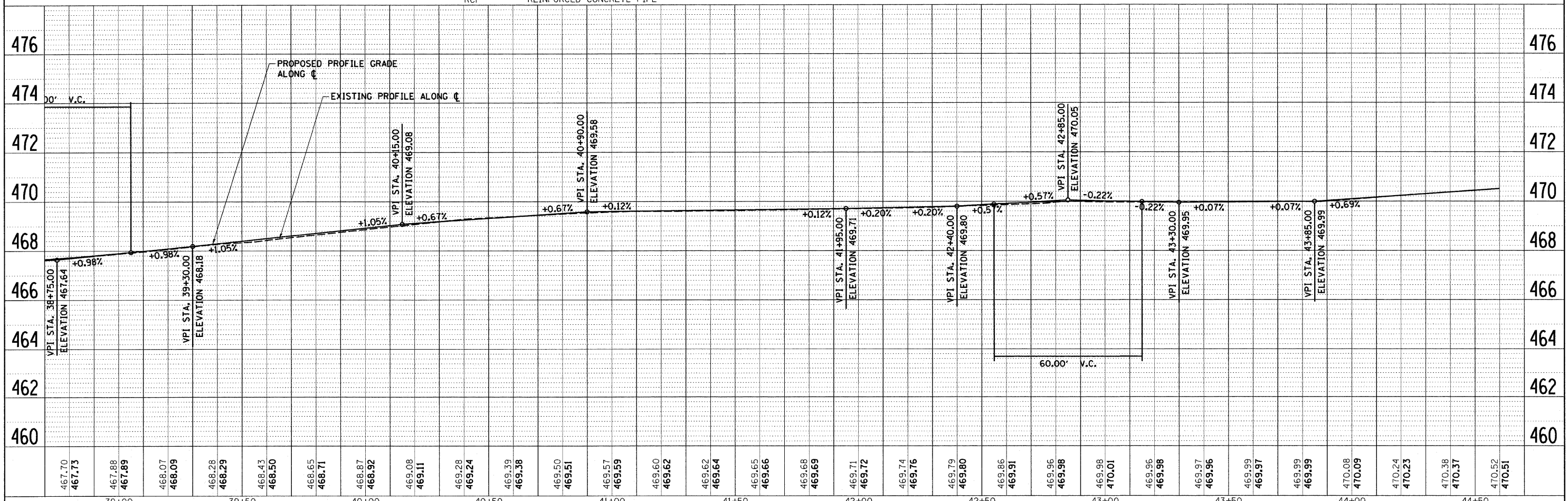

FILE NAME = H:\5819\NC_PP_5819_6.dgn	USER NAME = _USERDESCR_	DESIGNED - DLD	REVISED -	<b>STATE OF ILLINOIS DEPARTMENT OF TRANSPORTATION</b>	<b>BIKE TRAIL - PLAN AND PROFILE</b>	F.A. RTE.	SECTION	COUNTY	TOTAL SHEETS	SHEET NO.
PLOT SCALE = 20,0000' / IN.	CHECKED -	DRAWN - KOJ	REVISED -			06-00025-00-BT	CLINTON	54	13	
PLOT DATE = 7/14/2008	DATE -	CHECKED -	REVISED -			CONTRACT NO. 97357				
		DATE -	REVISED -			FED. ROAD DIST. NO.	ILLINOIS FED. AID PROJECT			

HMG JOB NO 5819