

SCHEDULE OF SIGNS

| SIGN NUMBER | SIGN TYPE | TYPE |
|-------------|-------------------------|----------------|
| 1 | DETOUR AHEAD | W20-2 (0) 48 |
| 2 | EXIT CLOSED | E5-2a-4836 |
| 3 | ROAD CLOSED | R11-4 6030 |
| 4 | DETOUR | M4-10 (0) 4818 |
| 5 | DETOUR | M4-10 (0) 4818 |
| 6 | END DETOUR | M4-8a (0) 2418 |
| 7 | UP | M6-3 2115 |
| 8 | RIGHT | M5-1R 2115 |
| 8A | RIGHT | M5-2R 2115 |
| 9 | RIGHT | M6-1R 2115 |
| 9A | RIGHT | M6-2R 2115 |
| 10 | LEFT | M5-1L 2115 |
| 11 | LEFT | M6-1L 2115 |
| 12 | NO LEFT TURN | R3-2 30"x30" |
| 13 | NO RIGHT TURN | R3-2 30"x30" |
| 14 | NORTH | M3-2 (0) 2412 |
| 15 | SOUTH | M3-4 (0) 2412 |
| 16 | DETOUR | M1-7 2412 |
| 17 | TO | R2-1-1212 |
| 18 | ILLINOIS 171 | M1-5-4536 |
| 19 | SHIELD 55 | M1-1-3636 |
| 20 | ONLY | M4-5-3618 |
| 21 | ROAD CONSTRUCTION AHEAD | W20-1103-48 |

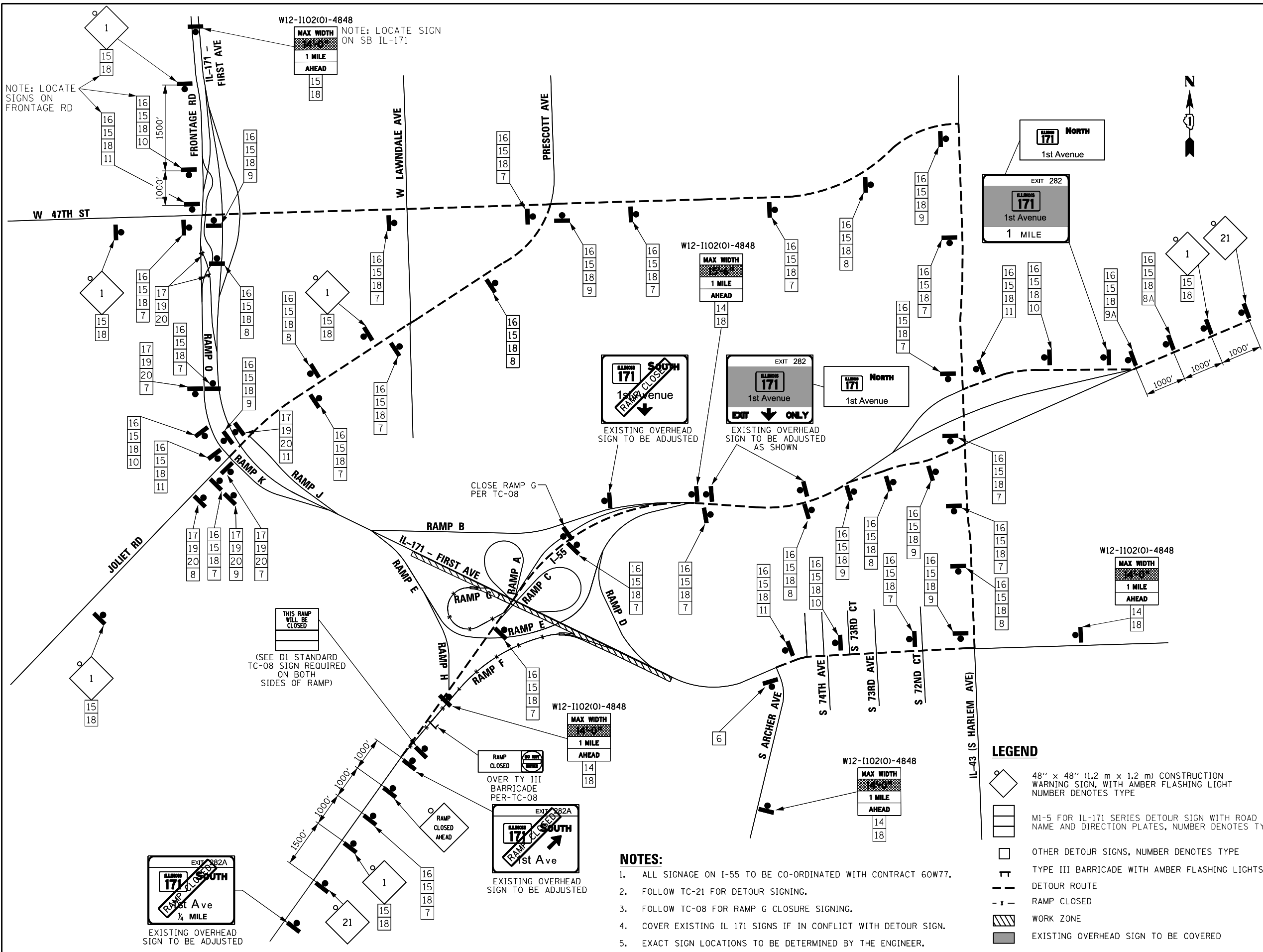

- NOTES:**
1. ALL SIGNAGE ON I-55 TO BE CO-ORDINATED WITH CONTRACT 60W77.
 2. FOLLOW TC-21 FOR DETOUR SIGNING.
 3. FOLLOW TC-08 FOR RAMP G CLOSURE SIGNING.
 4. COVER EXISTING IL 171 SIGNS IF IN CONFLICT WITH DETOUR SIGN.
 5. EXACT SIGN LOCATIONS TO BE DETERMINED BY THE ENGINEER.



| | | |
|--------------------------------|------------------|-----------|
| FILE NAME = | DESIGNED - AAA | REVISED - |
| ... \MOT\DI60J16-Detour-1b.dgn | DRAWN - TMB | REVISED - |
| USER NAME = agibson | CHECKED - JMM | REVISED - |
| PLOT DATE = 8/20/2014 | DATE - 6/23/2014 | REVISED - |



**STATE OF ILLINOIS
DEPARTMENT OF TRANSPORTATION**

**MAINTENANCE OF TRAFFIC
DETOUR 1B**

SHEET 26 OF 50 SHEETS STA. TO STA.

| | | | | |
|--------------------|-------------|--------|---------------------------|-----------|
| F.A.P. RFE. | SECTION | COUNTY | TOTAL SHEETS | SHEET NO. |
| 372/373 | 2013-038B-R | COOK | 821 | 87 |
| CONTRACT NO. 60J16 | | | ILLINOIS FED. AID PROJECT | |