

NOTE:
PEDESTRIAN PUSH BUTTON AND SIGNAGE SHALL BE INSTALLED PER
STANDARD 816001-03. DETAIL IS INCLUDED.

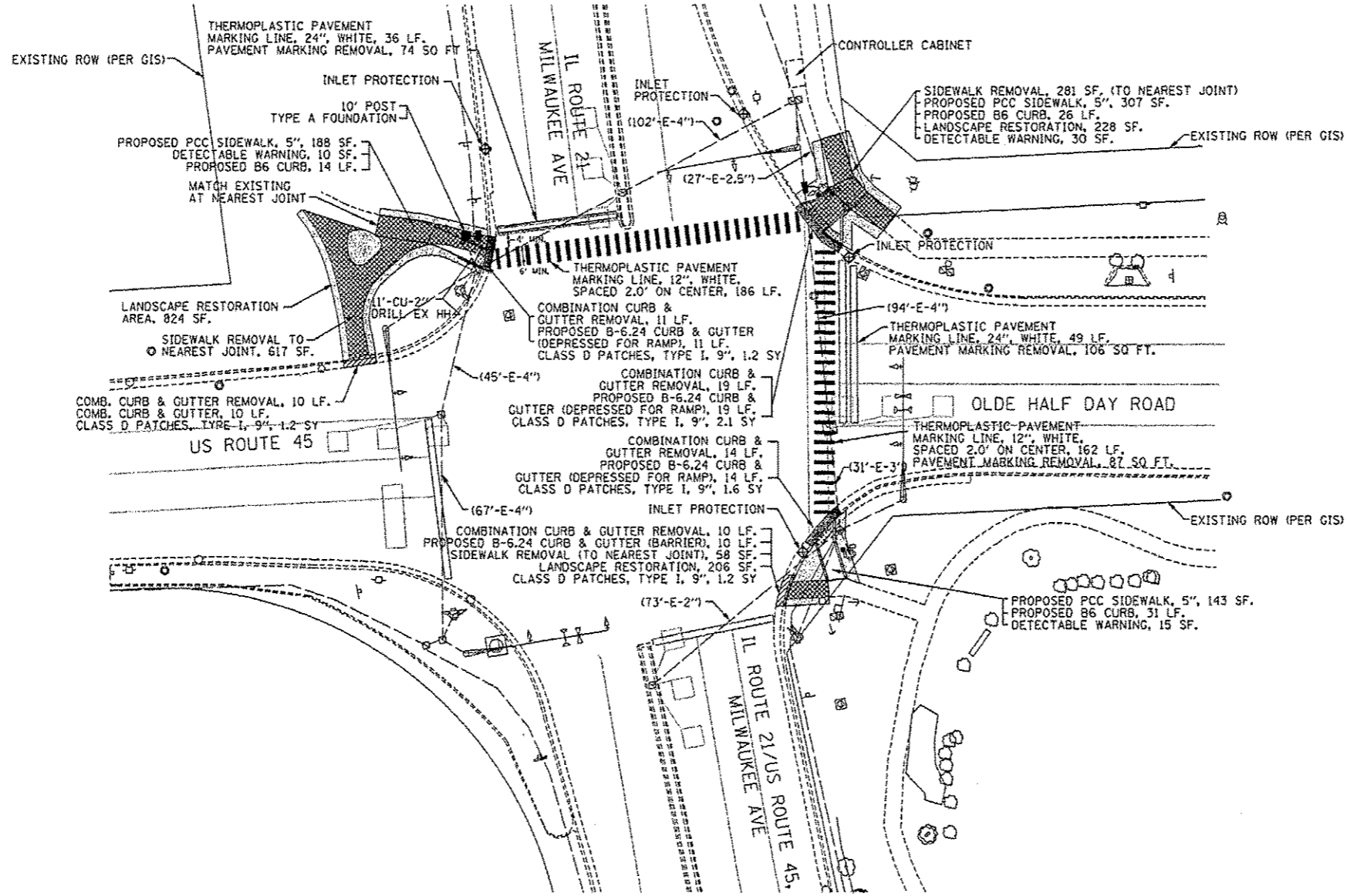

LEGEND

- COMBINATION CURB AND GUTTER REMOVAL
- TOPSOIL FURNISH AND PLACE, 6" SODDING, SALT TOLERANT AND FERTILIZER
- SIDEWALK REMOVAL
- REMOVE AND REPLACE CURB AND GUTTER WITH BARRIER B-6.24
- REMOVE AND REPLACE CURB AND GUTTER WITH DEPRESSED BARRIER B-6.24
- DETECTABLE WARNING
- INLET FILTERS

ITEM	QTY
NITROGEN FERTILIZER NUTRIENT	60X0.02=1.74LB
PHOSPHORUS FERTILIZER NUTRIENT	60X0.02=1.74LB
POTASSIUM FERTILIZER NUTRIENT	60X0.02=1.74LB

TS6595
Rev. Sheet 9-4-14

FILE NAME =	USER NAME = hardnetbr	DESIGNED -	REVISED -	STATE OF ILLINOIS DEPARTMENT OF TRANSPORTATION	OLDE HALF DAY RD AT IL RTE 21/US ROUTE 45 (MILWAUKEE AVE) TRAFFIC SIGNAL MODIFICATION PLAN	F.A.P. RTE.	SECTION	COUNTY	TOTAL SHEETS	SHEET NO.	
ci:\pw\work\awidot\hardnetbr\08337694\0	SIB12-shr-plan.dgn	DRAWN -	REVISED -			330	(1&1)RS-3	LAKE	60	21	
Default	PLOT SCALE = 1/8"=1'-0"	CHECKED -	REVISED -			SCALE: SHEET 1 OF 1 SHEETS STA. TO STA.					
	PLOT DATE = 6/22/2014	DATE -	REVISED -			ILLINOIS FED. AID PROJECT CONTRACT NO. 60V03					