

CONTROL POINT 107
 STA. 805+63.41 79.44' RT
 1/2" IRON PIN WITH RED CAP ON SOUTH EAST QUADRANT OF INTERSECTION OF WEBER ROAD & RAMP TO I-55 NORTHBOUND
 N 1816520.51
 E 1041298.20
 ELEV. = 657.89

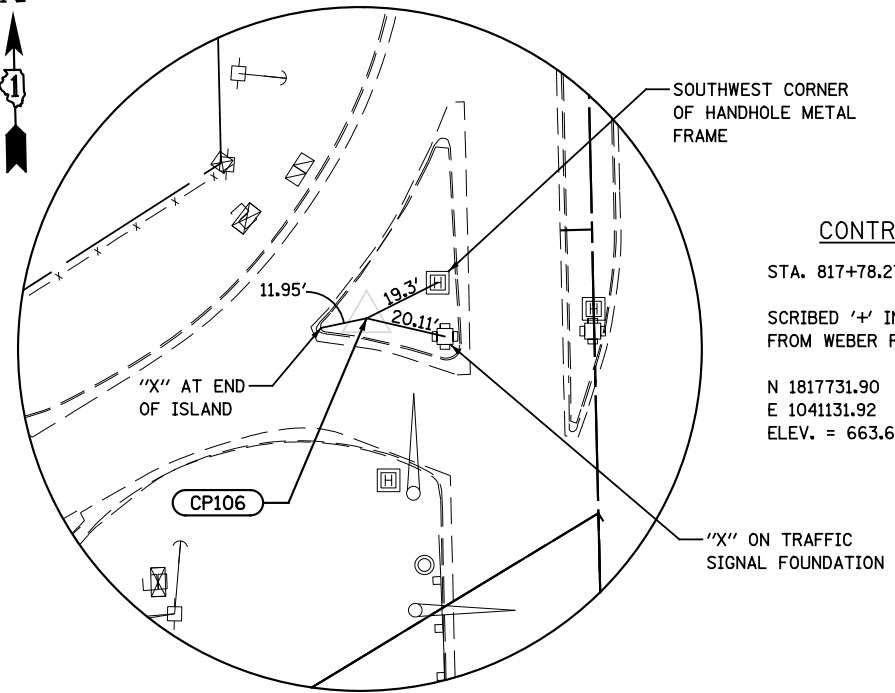

CONTROL POINT 106
 STA. 817+78.27 59.19' RT
 SCRIBED '+' IN CONCRETE ISLAND OF RAMP FROM WEBER ROAD TO I-55 SOUTHBOUND
 N 1817731.90
 E 1041131.92
 ELEV. = 663.66

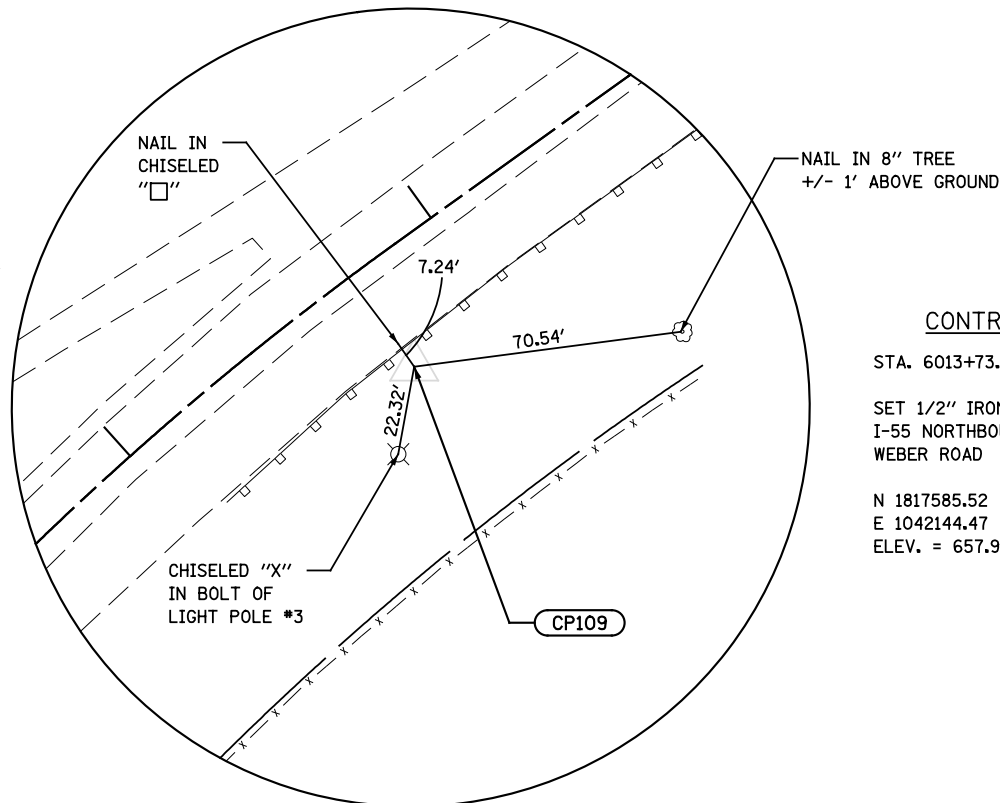

CONTROL POINT 109
 STA. 6013+73.28 28.76' RT
 SET 1/2" IRON PIN WITH RED CAP ON SOUTH SIDE I-55 NORTHBOUND @ GORE AREA OF RAMP FROM WEBER ROAD
 N 1817585.52
 E 1042144.47
 ELEV. = 657.90

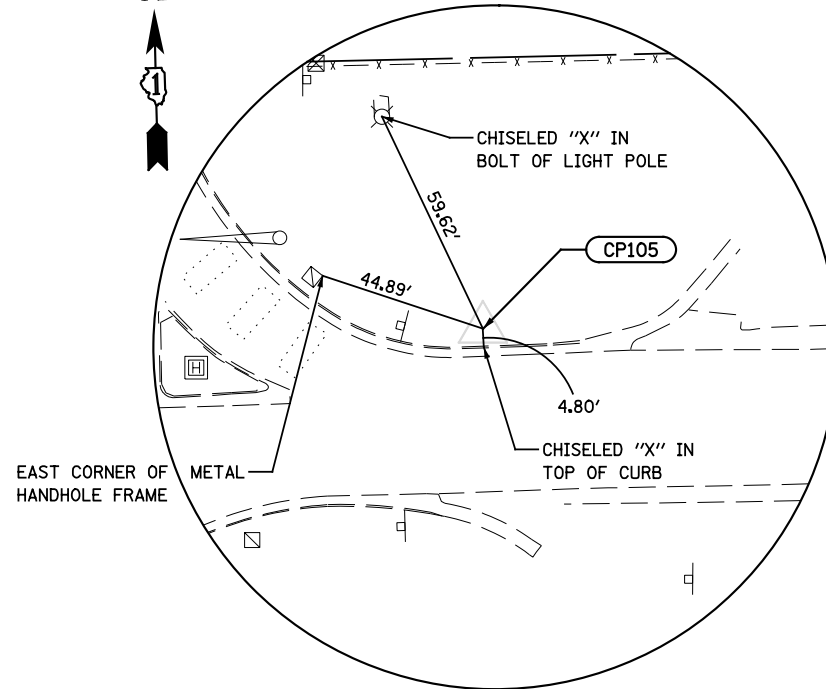

CONTROL POINT 105
 STA. 8998+71.00 12.84' LT
 SET 1/2" IRON PIN WITH RED CAP ON NORTH SIDE OFF RAMP I-55 SOUTHBOUND TO WEBER ROAD
 N: 1817737.18
 E: 1041309.17
 ELEV. = 662.45

FILE NAME = D:\6053-sh-04-ATB.dgn

USER NAME = 11ugo	DESIGNED LL	REVISED -
DRAWN KES	REVISIONS	REVISED -
PLOT SCALE = 1:50.0003	CHECKED PJO	REVISED -
PLOT DATE = 7/16/2014	DATE 7/16/2014	REVISED -

**STATE OF ILLINOIS
 DEPARTMENT OF TRANSPORTATION**

BENCHMARK & TIES

SCALE: NONE SHEET NO. 1 OF 1 SHEETS STA. TO STA.

F.A.I. RTE.	SECTION	COUNTY	TOTAL SHEETS	SHEET NO.
55	(99-1HB-1)A	WILL	33	13
CONTRACT NO. 60Y53				
ILLINOIS FED. AID PROJECT				