

MAINTENANCE OF TRAFFIC GENERAL NOTES

1. THE CONTRACTOR SHALL COORDINATE WITH THE ENGINEER IN REGARDS TO THE REQUIRED ADVANCE NOTICE TO IDOT DISTRICT 1 EXPRESSWAY TRAFFIC CONTROL SUPERVISOR.
2. THE CONTRACTOR SHALL PROVIDE ALL SIGNS, VERTICAL PANELS, TYPE III BARRICADES, CHANNELIZATION DRUMS, TYPE II BARRICADES, ALL TEMPORARY CONCRETE BARRIERS AND PROTECTION NECESSARY FOR WORK ZONE TRAFFIC CONTROL AND PROTECTION, OR AS DIRECTED BY THE ENGINEER.
3. THE CONTRACTOR SHALL INSTALL AND MAINTAIN PROPOSED EROSION CONTROL MEASURES DURING STAGE CONSTRUCTION THROUGHOUT THE DURATION OF THE PROJECT. THIS WORK SHALL BE INCLUDED IN THE COST OF THE PAY ITEMS ASSOCIATED WITH THE APPLICABLE EROSION CONTROL MEASURES.
4. ALL DRUMS, VERTICAL PANELS, AND TYPE II BARRICADES (IF REQUIRED) SHALL BE EQUIPPED WITH MONO-DIRECTIONAL STEADY BURNING LIGHTS ON MULTILANE ROADWAYS, WHILE BI-DIRECTIONAL LIGHTS ARE REQUIRED ON ALL, TWO-WAY, TWO-LANE ROADWAYS.
5. ALL DRUMS, VERTICAL PANELS, AND TYPE II BARRICADES SHALL BE SPACED AT 50 FEET CENTER TO CENTER THROUGHOUT THE WORK ZONE, EXCEPT IN TAPER AREAS, GORE AREAS, AND ALONG CORNER RADII, WHERE THEY SHALL BE SPACED AT 25 FEET CENTER TO CENTER EXCEPT AS OTHERWISE INDICATED ON THE PLANS.
6. TYPE II BARRICADES SHALL BE USED IN LIEU OF DRUMS IN LOCATIONS WHERE TYPE II MUST BE PLACED IN EXCAVATED AREAS DUE TO LIMITED SPACE. THESE BARRICADES SHALL HAVE LEG EXTENSIONS INSTALLED SUCH THAT THE TOP OF THE BARRICADE IS IN COMPLIANCE WITH IDOT HIGHWAY STANDARD 701901. DRUMS AND BARRICADES SHALL NOT BE PLACED TOGETHER WITHIN AN INDIVIDUAL RUN OF DEVICES.

7. ALL CONSTRUCTION WARNING SIGNS SHALL BE BLACK LEGEND ON ORANGE BACKGROUND.
8. ALL CONSTRUCTION WARNING SIGN DIMENSIONS SHALL BE 48" X 48", EXCEPT AS OTHERWISE STATED ON THE PLANS.
9. ALL "ROAD CONSTRUCTION AHEAD" WARNING SIGNS SHALL BE EQUIPPED WITH HIGH INTENSITY MONO-DIRECTIONAL FLASHING LIGHTS.
10. THE CONTRACTOR SHALL INSTALL AND COVER ALL TEMPORARY SIGNING BEFORE EXISTING SIGNS ARE REMOVED. THE CONTRACTOR SHALL RELOCATE EXISTING SIGNS AS INDICATED ON THE PLANS.
11. ALL EXISTING GUIDE SIGNS (I.E. STREET NAME SIGNS, ADVANCE STREET NAME SIGNS, ROUTE MARKERS, ETC.) SHALL BE MAINTAINED AND VISIBLE TO TRAFFIC DURING CONSTRUCTION.
12. EXISTING TRAFFIC SIGNS IN CONFLICT WITH STAGING SHALL BE REMOVED, RELOCATED OR COVERED AS DIRECTED BY THE ENGINEER. THE COST OF THIS WORK SHALL BE INCLUDED IN THE COST FOR TRAFFIC CONTROL AND PROTECTION (SPECIAL).
13. WARNING SIGNS ARE REQUIRED AT ALL CONSTRUCTION ENTRANCES TO ALERT MOTORISTS.
14. THE MOUNTING HEIGHT OF MAINTENANCE OF TRAFFIC SIGNS SHALL BE IN ACCORDANCE WITH IDOT HIGHWAY STANDARD 720006-04.

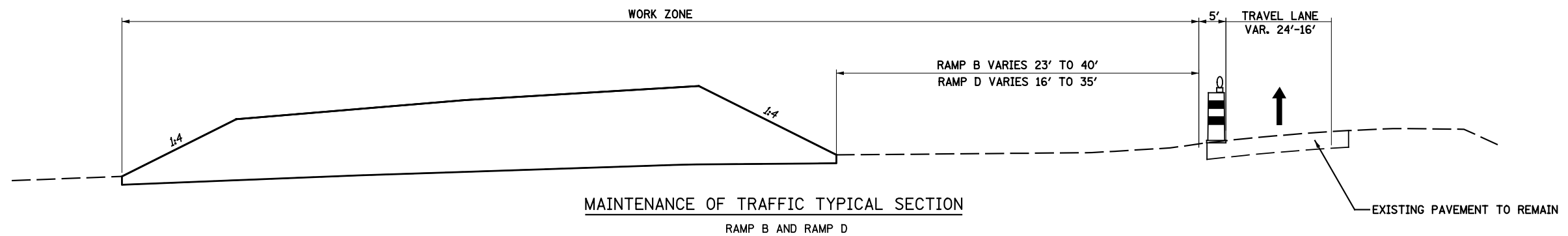

FILE NAME : D:\60Y53\sh-typical-001.MDT.dgn

USER NAME = mmaestra	DESIGNED PAW	REVISED -
	DRAWN PAW	REVISED -
PLOT SCALE = 1:15.0001	CHECKED PJO	REVISED -
PLOT DATE = 7/31/2014	DATE 7/31/2014	REVISED -

**STATE OF ILLINOIS
DEPARTMENT OF TRANSPORTATION**

**MAINTENANCE OF TRAFFIC -
GENERAL NOTES AND TYPICAL SECTION RAMP B AND RAMP D**

F.A.I. RTE.	SECTION	COUNTY	TOTAL SHEETS	SHEET NO.
55	(99-1HB-1)A	WILL	33	14
CONTRACT NO. 60Y53			ILLINOIS FED. AID PROJECT	

SCALE: NONE SHEET NO. 1 OF 1 SHEETS STA. TO STA.