

F.A.P. RTE.	SECTION	COUNTY	TOTAL SHEETS	SHEET NO.
685	39-1-2	FULTON	10	1
		ILLINOIS	CONTRACT NO. 68C18	

STATE OF ILLINOIS  
DEPARTMENT OF TRANSPORTATION

DIVISION OF HIGHWAYS

**PROPOSED  
HIGHWAY PLANS**

FAP ROUTE 685 (IL 9)  
SECTION 39-1-2

PATCHING  
FULTON COUNTY

C-94-130-14

INDEX OF SHEETS

1. COVER SHEET
2. GENERAL NOTES
3. STATUS OF UTILITIES
4. SUMMARY OF QUANTITIES
5. TYPICAL SECTIONS
6. SCHEDULES OF QUANTITIES
7. LINE DIAGRAM
8. ROW, UTILITY, BENCHMARK INFORMATION
- 9.-10. DISTRICT STANDARDS  
HIGHWAY STANDARDS

HIGHWAY STANDARDS

- 442201-03
- 701336-06
- 701316-08
- 701901-03

DISTRICT STANDARDS

780001-D4

- ADT = 725 (2013)
- MU = 5.5% (2013)
- SU = 6.9% (2013)

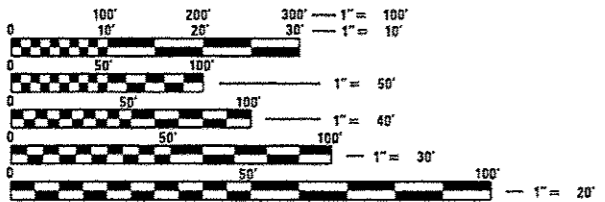

FULL SIZE PLANS HAVE BEEN PREPARED USING STANDARD ENGINEERING SCALES. REDUCED SIZED PLANS WILL NOT CONFORM TO STANDARD SCALES. IN MAKING MEASUREMENTS ON REDUCED PLANS, THE ABOVE SCALES MAY BE USED.

J.U.L.I.E.  
JOINT UTILITY LOCATION INFORMATION FOR EXCAVATION  
1-800-892-0123  
OR 811

PROJECT ENGINEER CHRISTOPHER MAUSHARD (309)671-3453  
PROJECT MANAGER MIKE MOHAMED (309)671-3462

CONTRACT NO. 68C18

GROSS LENGTH = 4,598 FT = 0.87 MI  
NET LENGTH = 3,522 FT = 0.67 MI

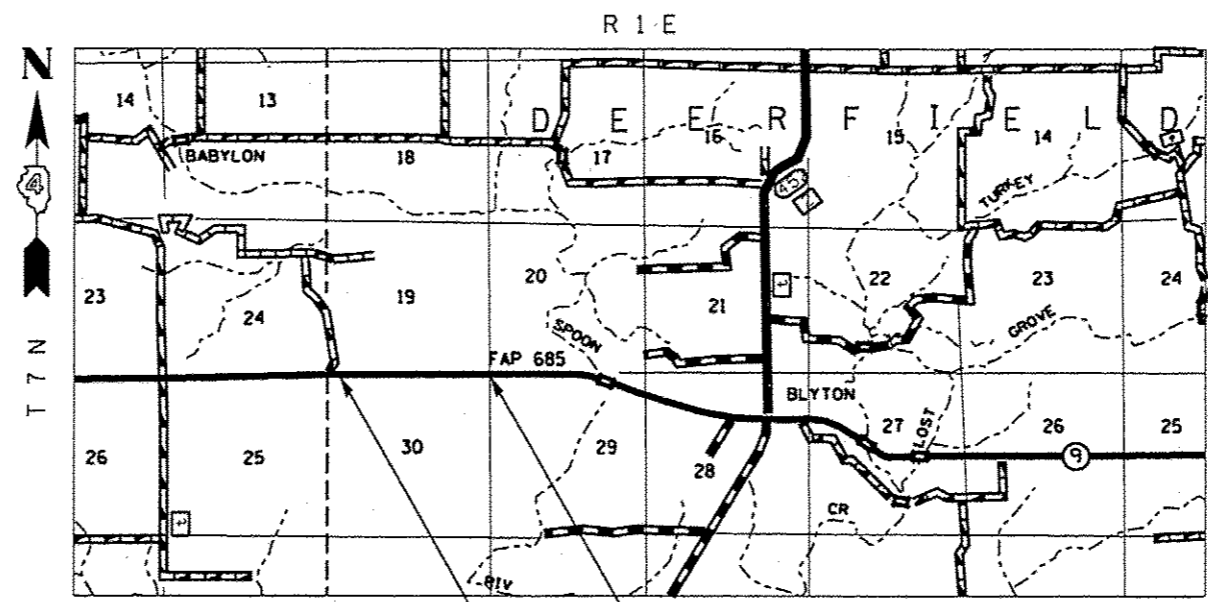

PROJECT BEGINS  
STA. 128+00

PROJECT ENDS  
STA. 173+98

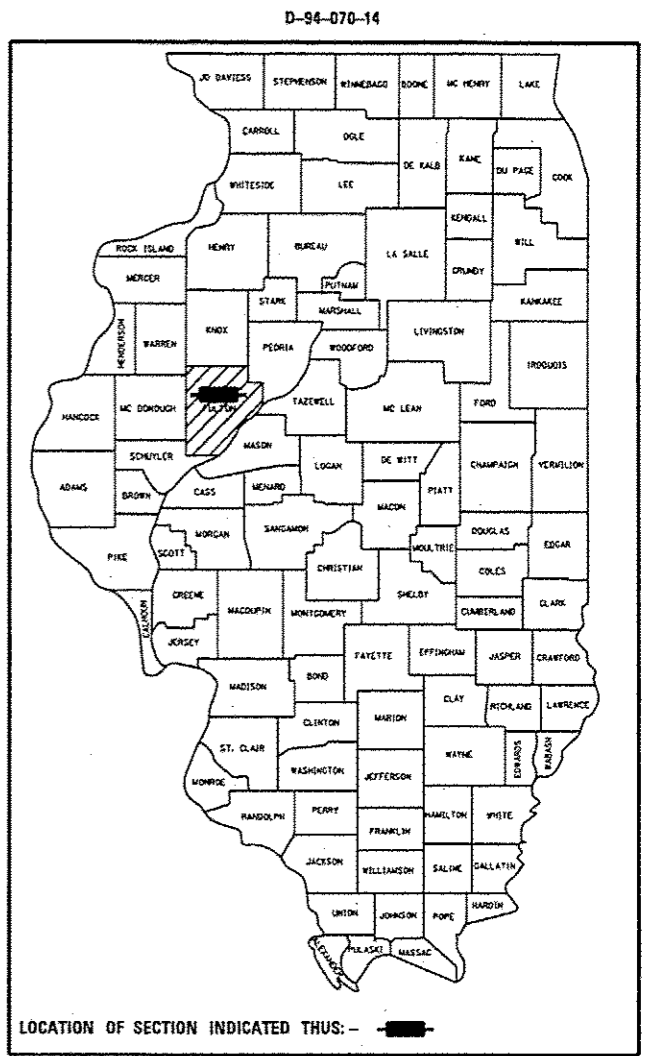

PROJECT DESCRIPTION:  
THE WORK ON THIS PROJECT  
CONSISTS OF PAVEMENT PATCHING

STATE OF ILLINOIS  
DEPARTMENT OF TRANSPORTATION  
DIVISION OF HIGHWAYS

SUBMITTED June 27 2014  
Kensil A. Garnett  
DEPUTY DIRECTOR OF HIGHWAYS, REGION ENGINEER

Aug 15 2014  
John D. Baranowski P.E.  
ENGINEER OF DESIGN AND ENVIRONMENT

Aug 15 2014  
Chris Osman P.E.  
DIRECTOR OF HIGHWAYS, CHIEF ENGINEER

PRINTED BY THE AUTHORITY  
OF THE STATE OF ILLINOIS