

PTZ CAMERA INSTALLATION

UNIVERSITY AVE.
&
I-74

(NOT TO SCALE)

CAMERA & CONDUIT /CABLE LAYOUT

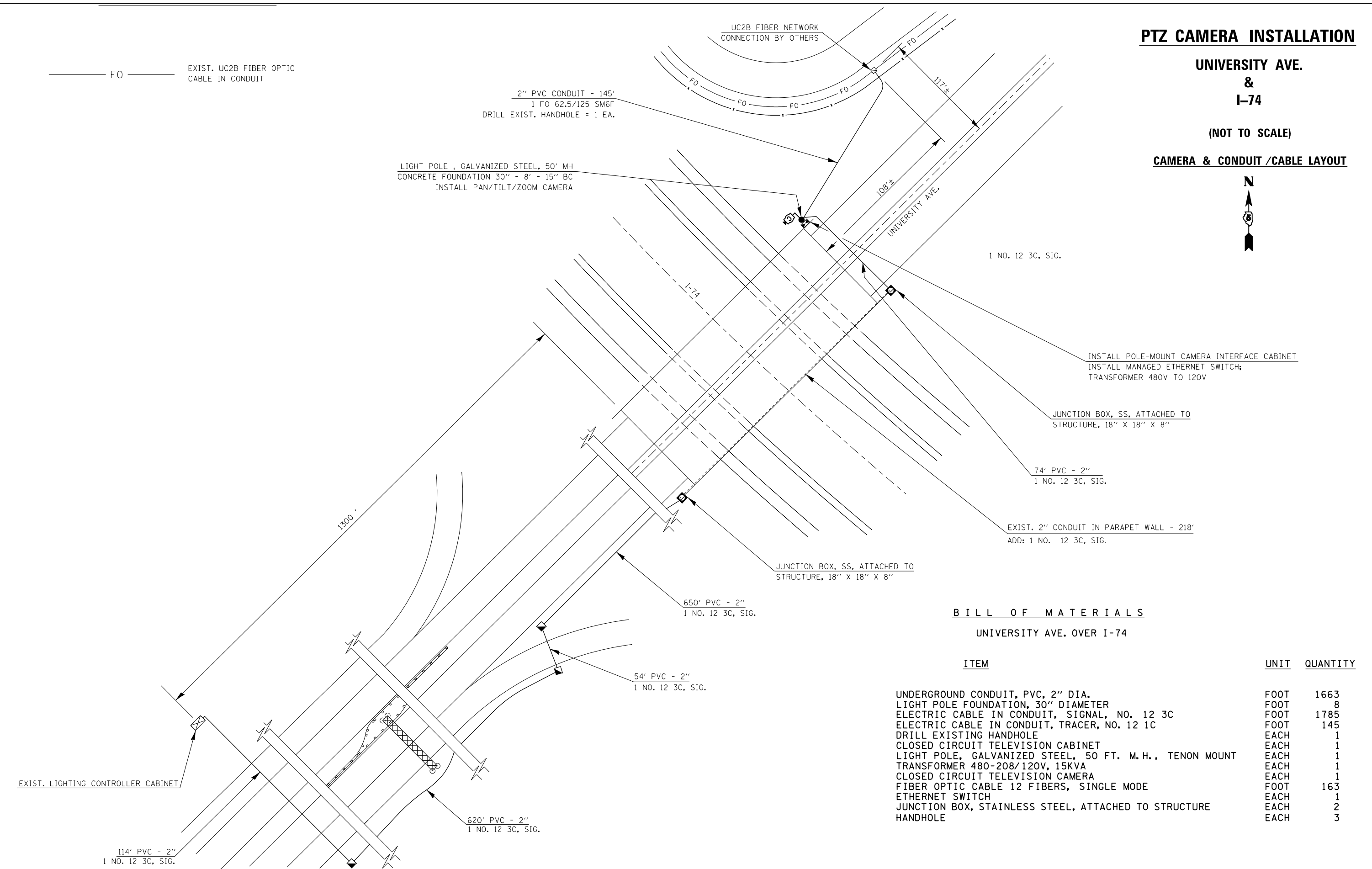

BILL OF MATERIALS

UNIVERSITY AVE. OVER I-74

ITEM	UNIT	QUANTITY
UNDERGROUND CONDUIT, PVC, 2" DIA.	FOOT	1663
LIGHT POLE FOUNDATION, 30" DIAMETER	FOOT	8
ELECTRIC CABLE IN CONDUIT, SIGNAL, NO. 12 3C	FOOT	1785
ELECTRIC CABLE IN CONDUIT, TRACER, NO. 12 1C	FOOT	145
DRILL EXISTING HANDHOLE	EACH	1
CLOSED CIRCUIT TELEVISION CABINET	EACH	1
LIGHT POLE, GALVANIZED STEEL, 50 FT. M. H., TENON MOUNT	EACH	1
TRANSFORMER 480-208/120V, 15KVA	EACH	1
CLOSED CIRCUIT TELEVISION CAMERA	EACH	1
FIBER OPTIC CABLE 12 FIBERS, SINGLE MODE	FOOT	163
ETHERNET SWITCH	EACH	1
JUNCTION BOX, STAINLESS STEEL, ATTACHED TO STRUCTURE	EACH	2
HANDHOLE	EACH	3

FILE NAME =	USER NAME = ceerlockjd	DESIGNED -	REVISED -
ei:\pw\work\p1dot\ceerlockjd\0340463\PTZ camera plans.dgn		DRAWN -	REVISED -
	PLOT SCALE = 100.0000' / in.	CHECKED -	REVISED -
\$MODELNAME\$	PLOT DATE = 6/26/2014	DATE -	REVISED -

STATE OF ILLINOIS
DEPARTMENT OF TRANSPORTATION

SCALE:	SHEET	OF	SHEETS	STA.	TO	STA.			
F.A.P. RTE.						SECTION	COUNTY	TOTAL SHEETS	SHEET NO.
VAR.						FY2014 ITS-1	CHAMPAIGN	71	42
CONTRACT NO. 70A26								ILLINOIS FED. AID PROJECT	