

PTZ CAMERA INSTALLATION & FIBER OPTIC CONNECTION

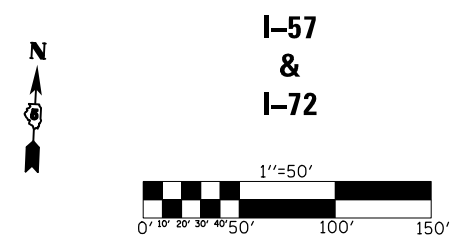

**I-57
&
I-72**

CAMERA & CONDUIT /CABLE LAYOUT

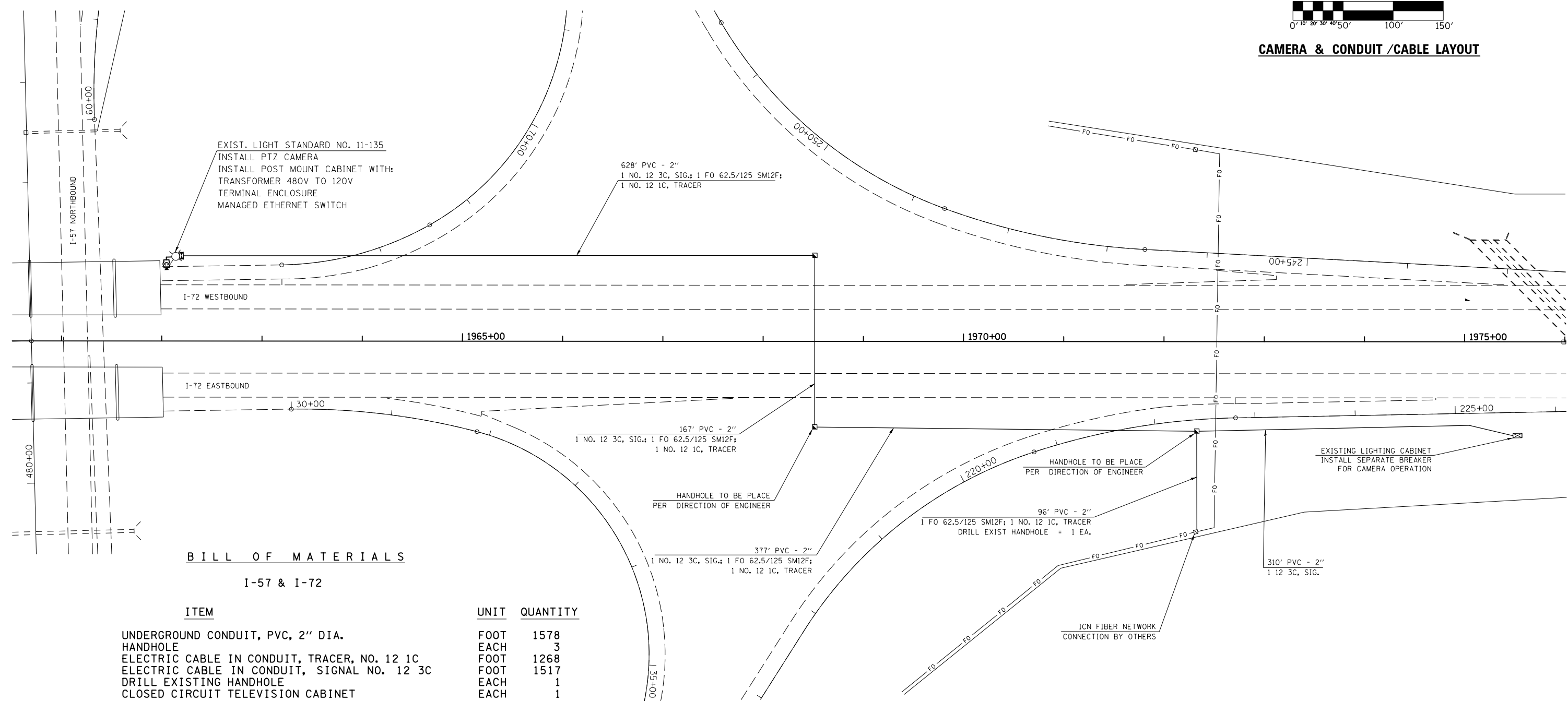

BILL OF MATERIALS

I-57 & I-72

ITEM	UNIT	QUANTITY
UNDERGROUND CONDUIT, PVC, 2" DIA.	FOOT	1578
HANDHOLE	EACH	3
ELECTRIC CABLE IN CONDUIT, TRACER, NO. 12 1C	FOOT	1268
ELECTRIC CABLE IN CONDUIT, SIGNAL NO. 12 3C	FOOT	1517
DRILL EXISTING HANDHOLE	EACH	1
CLOSED CIRCUIT TELEVISION CABINET	EACH	1
ETHERNET SWITCH	EACH	1
TRANSFORMER 480-208/120V, 15KVA	EACH	1
CLOSED CIRCUIT TELEVISION CAMERA	EACH	1
FIBER OPTIC CABLE 12 FIBERS, SINGLE MODE	FOOT	1303

FILE NAME =	USER NAME = ceerlockjd	DESIGNED -	REVISED -
c:\pwork\work\pwork\ceerlockjd\0340463\PTZ camera plans.dgn		DRAWN -	REVISED -
\$MODELNAME\$	PLOT SCALE = 100.0000' / 1".	CHECKED -	REVISED -
	PLOT DATE = 6/26/2014	DATE -	REVISED -

**STATE OF ILLINOIS
DEPARTMENT OF TRANSPORTATION**

SCALE:	SHEET	OF	SHEETS	STA.	TO	STA.																				
<table border="1" style="width: 100%; border-collapse: collapse;"> <tr> <td>F.A.P. RTE.</td> <td>SECTION</td> <td>COUNTY</td> <td>TOTAL SHEETS</td> <td>SHEET NO.</td> </tr> <tr> <td>VAR.</td> <td>FY2014 ITS-1</td> <td>CHAMPAIGN</td> <td>71</td> <td>53</td> </tr> <tr> <td colspan="5" style="text-align: right;">CONTRACT NO. 70A26</td> </tr> <tr> <td colspan="5" style="text-align: right;">ILLINOIS FED. AID PROJECT</td> </tr> </table>							F.A.P. RTE.	SECTION	COUNTY	TOTAL SHEETS	SHEET NO.	VAR.	FY2014 ITS-1	CHAMPAIGN	71	53	CONTRACT NO. 70A26					ILLINOIS FED. AID PROJECT				
F.A.P. RTE.	SECTION	COUNTY	TOTAL SHEETS	SHEET NO.																						
VAR.	FY2014 ITS-1	CHAMPAIGN	71	53																						
CONTRACT NO. 70A26																										
ILLINOIS FED. AID PROJECT																										