

F.A.P. RTE.	SECTION	COUNTY	TOTAL SHEETS	SHEET NO.
662	(1-2) RS-1,N	SANGAMON	89	1
		ILLINOIS	CONTRACT NO. 72F96	

**INDEX OF SHEETS**

- 1 COVER SHEET
- 2 GENERAL NOTES
- 3-8 SUMMARY OF QUANTITIES
- 9-15 SCHEDULES OF QUANTITIES
- 16-18 TYPICAL SECTIONS
- 19 ALIGNMENTS, TIES & BENCHMARKS
- 20-39 PLAN SHEETS
- 40-41 INTERSECTION DETAILS
- 42-58 PAVEMENT MARKINGS SHEETS
- 59-69 TRAFFIC SIGNAL PLAN SHEETS
- 70-71 LIGHTING PLAN SHEETS
- 72-76 DETAIL SHEETS
- 77-89 CROSS SECTION SHEETS

**STATE OF ILLINOIS**  
**DEPARTMENT OF TRANSPORTATION**  
**DIVISION OF HIGHWAYS**

**PROPOSED**  
**HIGHWAY PLANS**

**FAP ROUTE 662 (IL 4)**  
**SECTION (1-2) RS-1,N**

**3P RESURFACING**  
**SANGAMON COUNTY**

C-96-029-13

D-96-029-13

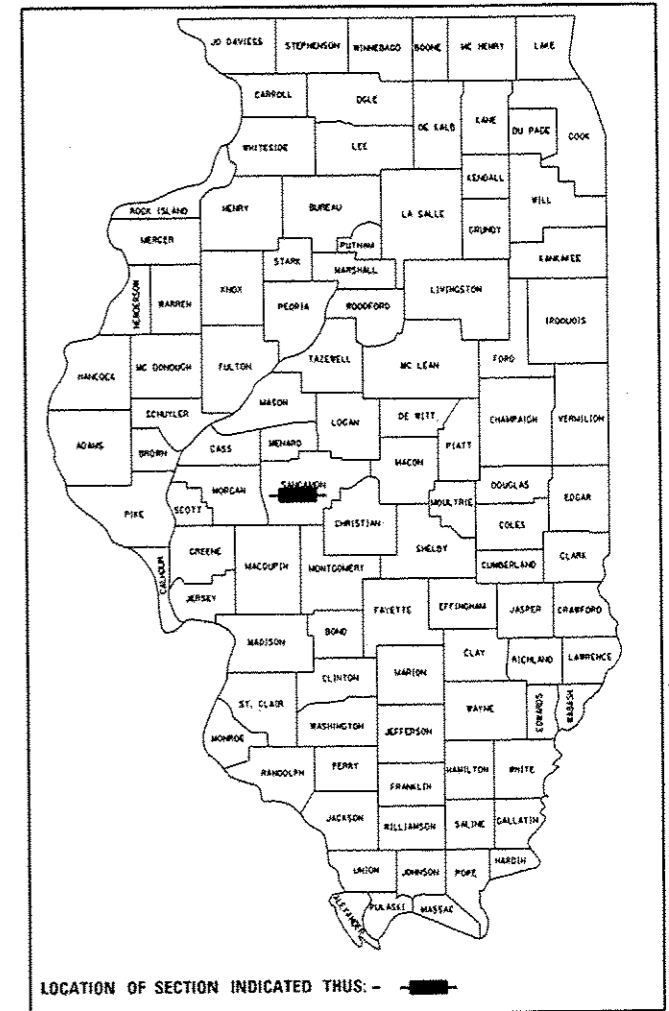

ADT = 16,200 (2014)  
PV = 92.4%  
SU = 5.6%  
MU = 2%

**STANDARDS**

000001-06	701901-03
280001-07	780001-04
420001-07	781001-03
442001-04	782001
482006-03	836001-02
606001-05	838001
606201-02	873001-02
606301-04	878001-09
701101-04	880006-01
701421-06	886001-01
701422-06	886006-01
701426-06	821101
701701-09	

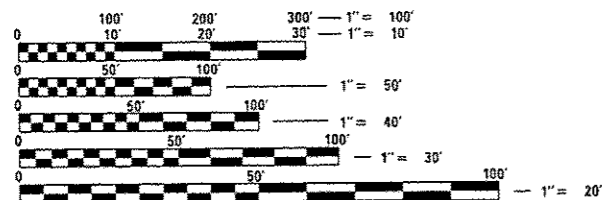

FULL SIZE PLANS HAVE BEEN PREPARED USING STANDARD ENGINEERING SCALES. REDUCED SIZED PLANS WILL NOT CONFORM TO STANDARD SCALES. IN MAKING MEASUREMENTS ON REDUCED PLANS, THE ABOVE SCALES MAY BE USED.

J.U.L.I.E.  
JOINT UTILITY LOCATION INFORMATION FOR EXCAVATION  
1-800-892-0123  
OR 811

SENIOR TEAM ENGINEER: MARK DUST (217) 785-0597  
TEAM LEADER: FRANK SHIMKUS (217) 785-9102

CONTRACT NO. 72F96

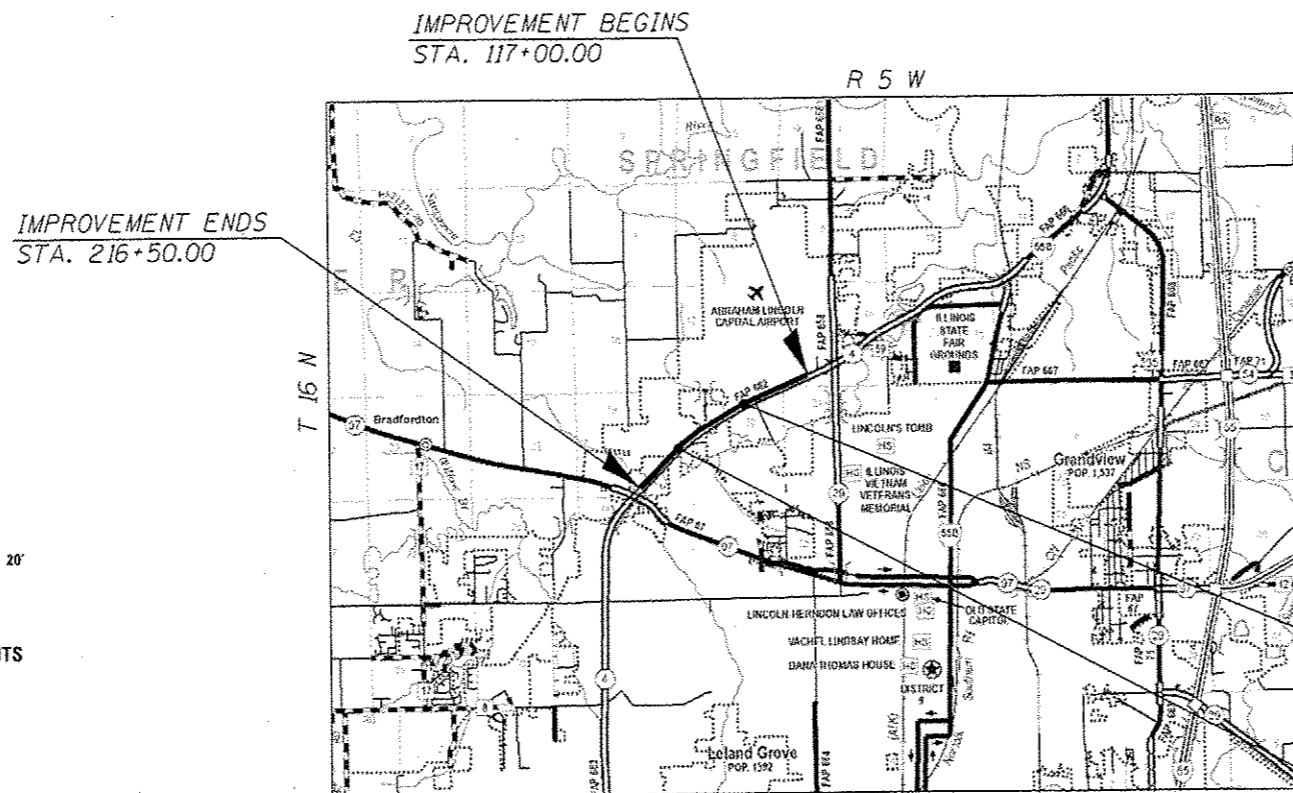

GROSS LENGTH = 9930.35 FT. = 1.88 MILE  
NET LENGTH = 9930.35 FT. = 1.88 MILE



STA E0:  
STA 154+43.19 BK=  
STA 154+05.70 AH

STA E0:  
STA 198+70.93 BK=  
STA 198+88.77 AH

STATE OF ILLINOIS  
DEPARTMENT OF TRANSPORTATION  
DIVISION OF HIGHWAYS

SUBMITTED July 14 2014  
Roger J. Quiskoll, JEN  
DEPUTY DIRECTOR OF HIGHWAYS, REGION ENGINEER

Aug 15 2014  
John D. Baranzelli, P.E.  
ENGINEER OF DESIGN AND ENVIRONMENT

Aug 15 2014  
Omer Osman, P.E.  
DIRECTOR OF HIGHWAYS, CHIEF ENGINEER

**PRINTED BY THE AUTHORITY**  
**OF THE STATE OF ILLINOIS**