

STATE OF ILLINOIS
DEPARTMENT OF PUBLIC WORKS & BUILDINGS
DIVISION OF HIGHWAYS

DATE	SECTION	COUNTY	TOTAL SHEETS	SHEET NO.
11-2-60	148-B-2	MACON	27	7
11-2-60	148-B-2	MACON	11	3

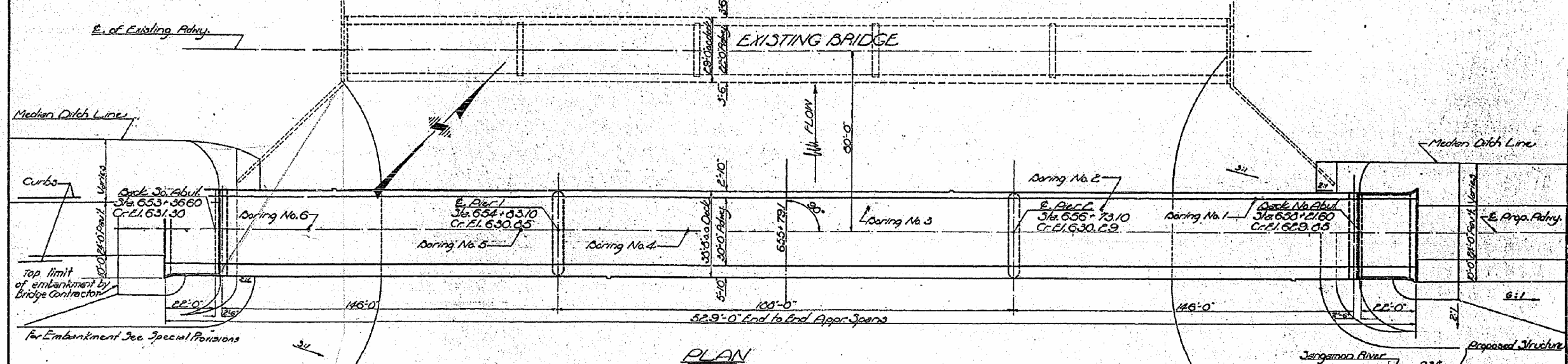

STATION 655+79.1
BUILT 196. 134
STATE OF ILLINOIS
S.B.I.R.T. 2-SEC. 48X-B-2
F.A.P. PROJ. U-576(19)
LOADING H20-316
NAME PLATE

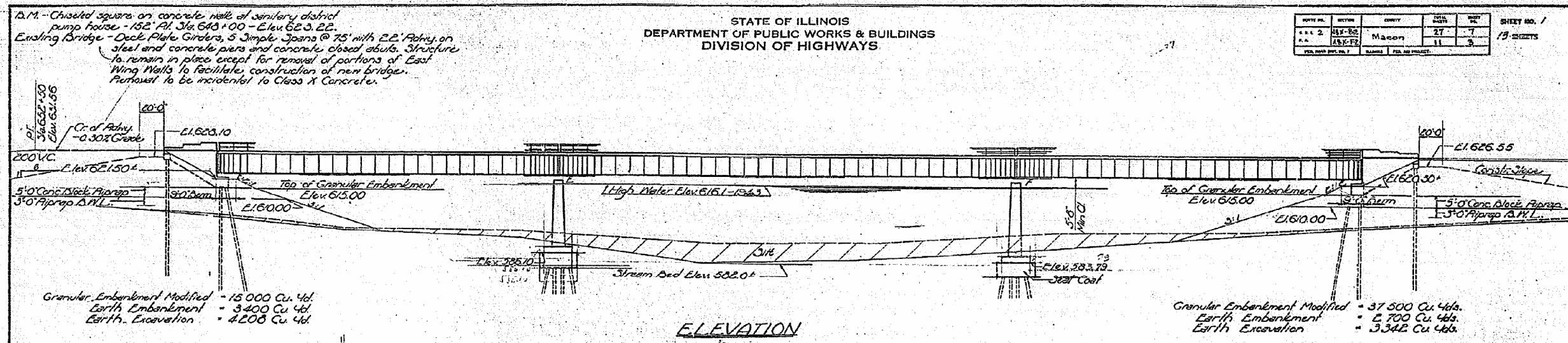
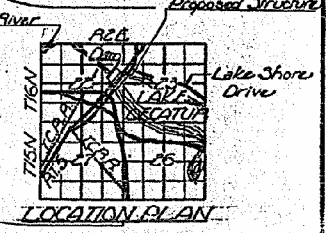

DESIGNED	W. S. P. [Signature]	EXAMINED	W. S. P. [Signature]
CHECKED	A. D. [Signature]	PASSED	[Signature]
DRAWN	M. L. [Signature]	APPROVED	R. B. [Signature]
CHECKED	[Signature]		

July 29 1960

WATERWAY INFORMATION

Drainage Area 573.840 Acres
 Character Level, Rolling & Cultivated
 Required Opening (50 Yr. Flood) 9,000 Sq. Ft.
 Present Opening 9,570 Sq. Ft.*
 Proposed Opening (New Structure) 10,000 Sq. Ft.*
 Ordinary Water Elev. 4612.0
 Low Water Elev. [blank]
 *Includes Area of Piers

DESIGN STRESSES

1c = 1400 psi Super
 1s = 20,000 psi Reinft.
 1p = 18,000 psi Struct.
 1v = 75 psi. Piers & Abut. Flgs.
 n = 10
 LOADING H20-316-44

GENERAL PLAN & ELEVATION
 PROJ. U-576(19)
 S.B.I.R.T. 2-SEC. 48X-B-2 & F2
 MACON COUNTY
 STA. 655+79.1

Revised: Barron Encon 4000 Cu Yds. to Earth Encon 4200 Cu Yds. & Barron Encon 2240 Cu Yds. to Earth Encon 3342 Cu Yds.
 Revised: Elev. 534.14 to 536.70 & Elev. 533.03 to 533.79 to 531.60 G.R.

BLANK, WESSELINK, COOK & ASSOCIATES

DECATUR, ILLINOIS ENGINEERS - CONSULTANTS DESIGN FIRM NO. 184000894

FILE NAME =	
USER NAME =	DESIGNED PBB
	CHECKED MCB
PLOT SCALE =	DRAWN MLO
PLOT DATE =	CHECKED PBB/MCB

REVISION	REVISION	REVISION
REVISOR	REVISOR	REVISOR
DATE	DATE	DATE

STATE OF ILLINOIS
DEPARTMENT OF TRANSPORTATION

EXISTING BRIDGE PLANS

SHEET NO. 26 OF 34 SHEETS

F.A.P. RTE.	SECTION	COUNTY	TOTAL SHEETS	SHEET NO.
710	(48X-B-2)BR & (48BR)BR	MACON	144	103
CONTRACT NO. 74438				

ILLINOIS FED. AID PROJECT