

SEE STAGE CONSTRUCTION
DETAILS FOR PROPOSED
WORK NEAR UNDERPASS

407+63.21 FAI RTE. 70 =
14+55.32 ILL RTE 143

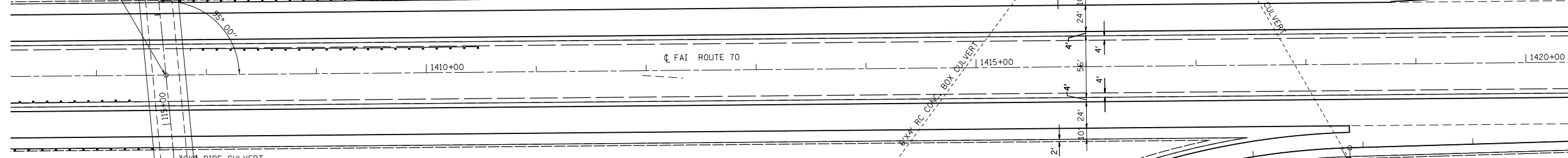

MATCHLINE STA. 14+00

PROPOSED HMA SHOULDERS 2 1/4"

PROPOSED HMA SHOULDERS 2 1/4"

PROPOSED AGGREGATE WEDGE SHOULDER, TYPE B

PROPOSED POLYMERIZED HMA
SURFACE COURSE, SMA, N80, 4"

EXIST. CURVE 160R3C8
PI STA. = 9+51.32
 $\Delta = 41^\circ 09' 18''$ (RT)
D = 8° 18' 13"
R = 690.00'
T = 259.05'
L = 495.62'
E = 47.02'
e = -----
T.R. = -----
S.E. RUN = -----
P.C. STA. = 6+92.27
P.T. STA. = 11+87.89

EXIST. CURVE 160R3C7
PI STA. = 2+76.47
 $\Delta = 22^\circ 18' 04''$ (LT)
D = 8° 08' 19"
R = 704.00'
T = 138.76'
L = 274.02'
E = 13.55'
e = -----
T.R. = -----
S.E. RUN = -----
P.C. STA. = 1+37.71
P.T. STA. = 4+11.72

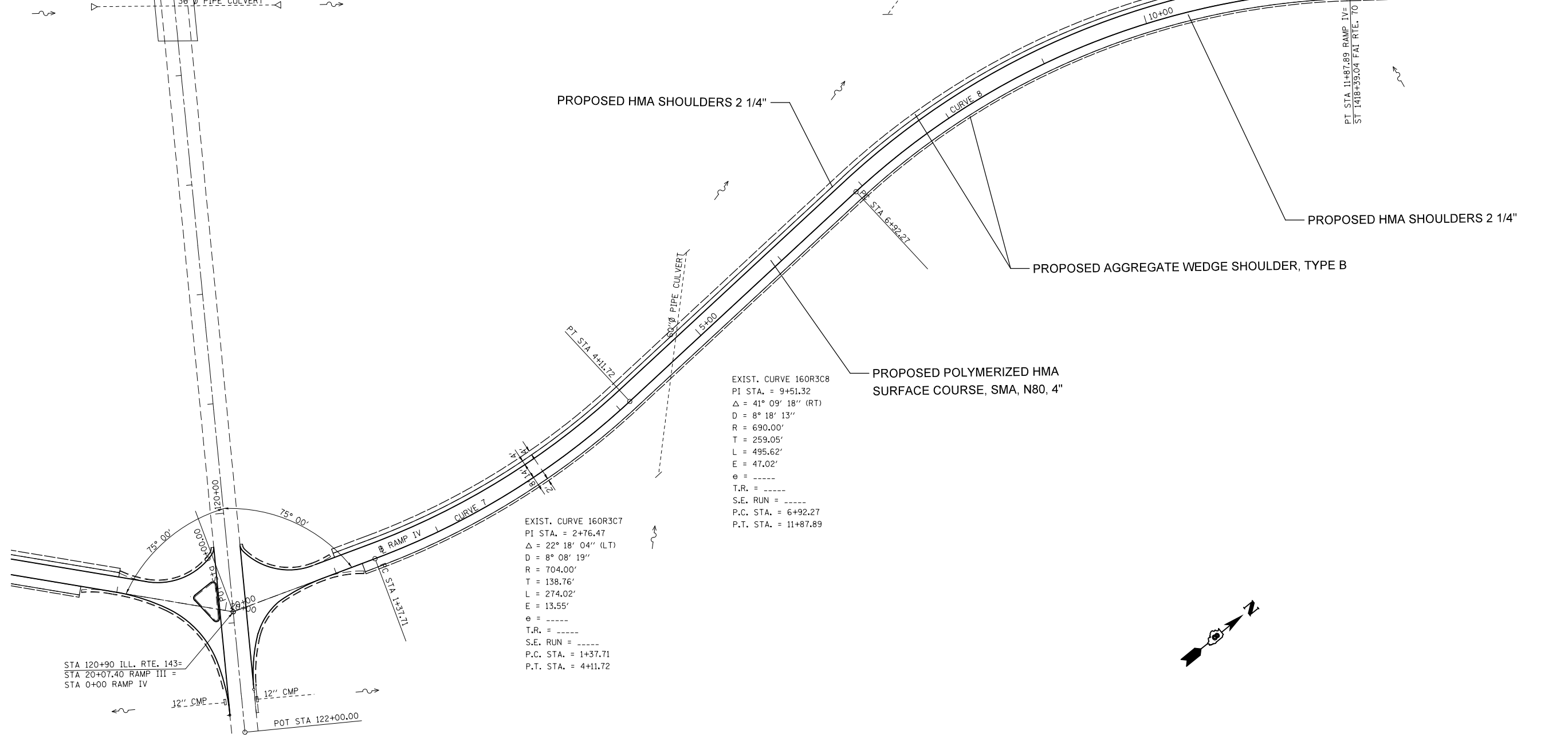

STA 120+90 ILL. RTE. 143=
STA 20+07.40 RAMP III =
STA 0+00 RAMP IV

12" CMP
12" CMP
POT STA 122+00.00

FILE NAME =	USER NAME = milleraj	DESIGNED -	REVISED -
et:\pw\work\p\midot\milleraj\20279918\2014\13-sht-plan.dgn		DRAWN -	REVISED -
PLOT SCALE = 100.0000' / in.		CHECKED -	REVISED -
PLOT DATE = 6/27/2014		DATE -	REVISED -

**STATE OF ILLINOIS
DEPARTMENT OF TRANSPORTATION**

IL 143 RAMP IV DETAILS

SCALE: 20 SHEET NO. 40 OF 49 SHEETS STA. TO STA.

F.A.I. RTE.	SECTION	COUNTY	TOTAL SHEETS	SHEET NO.
70	60-(11,12)RS-3	MADISON	242	78
CONTRACT NO. 76F13				
FED. ROAD DIST. NO. ILLINOIS FED. AID PROJECT				