

LEGEND	
	WORK AREA
	IMPACT ATTENUATOR, TEMPORARY (NON-REDIRECTIVE) TEST LEVEL 3
	DIRECTION OF TRAVEL/LANE MAINTAINED
	BARRICADES OR DRUMS
	VERTICAL PANELS
	TEMPORARY CONCRETE BARRIER
	TEMPORARY PAVEMENT MARKING

- NOTES:**
1. REFER TO STANDARD 701400 FOR SIGNING AND MARKING OF APPROACH TO LANE CLOSURE
  2. REFER TO STANDARD 701402 FOR SIGNING AND MARKING OF LANE CLOSURE
  3. REFER TO SPECIAL PROVISIONS FOR WORK INCLUDED IN THIS STAGE

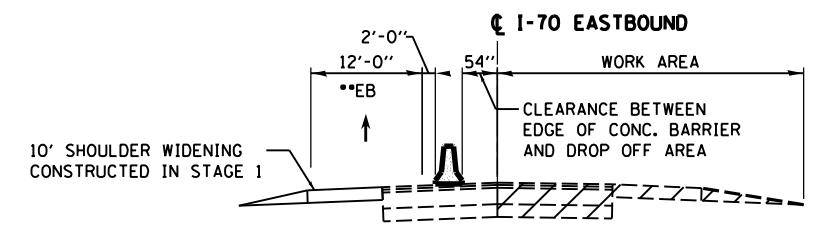
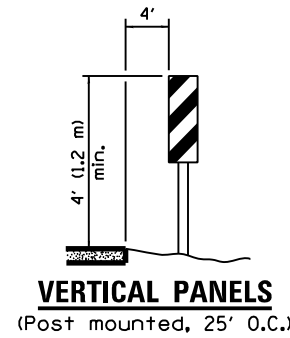

•• LANES SHIFTED AS SHOWN IN STAGING PLANS

**SECTION - I-70 EASTBOUND**  
SECTION APPLIES TO I-70 WESTBOUND

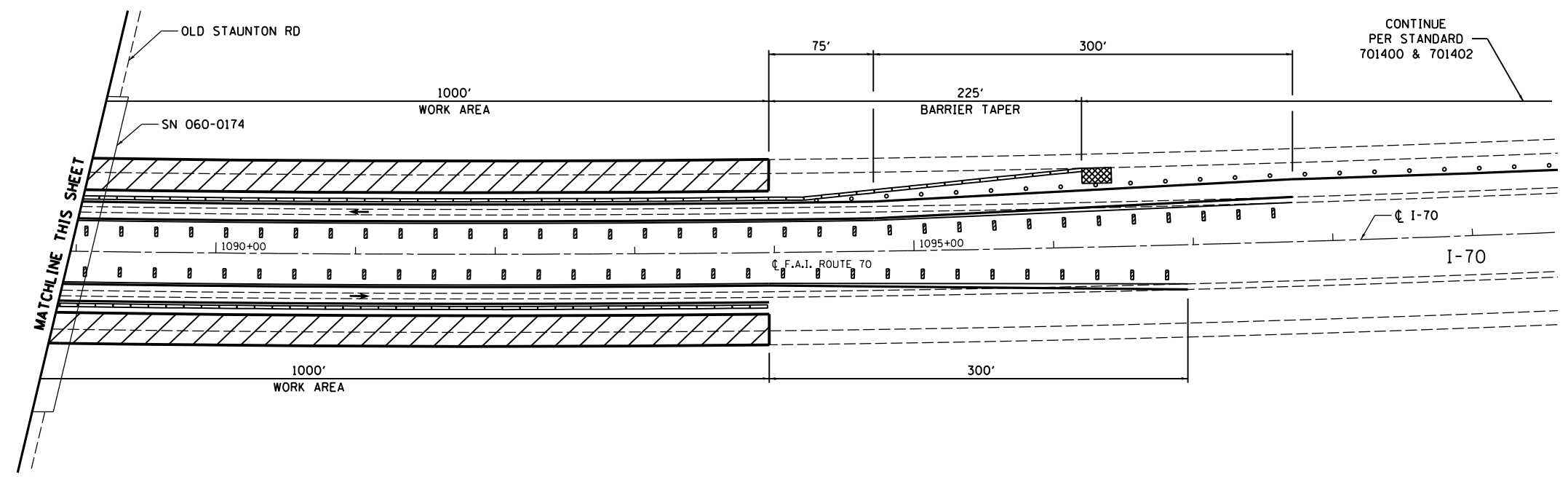
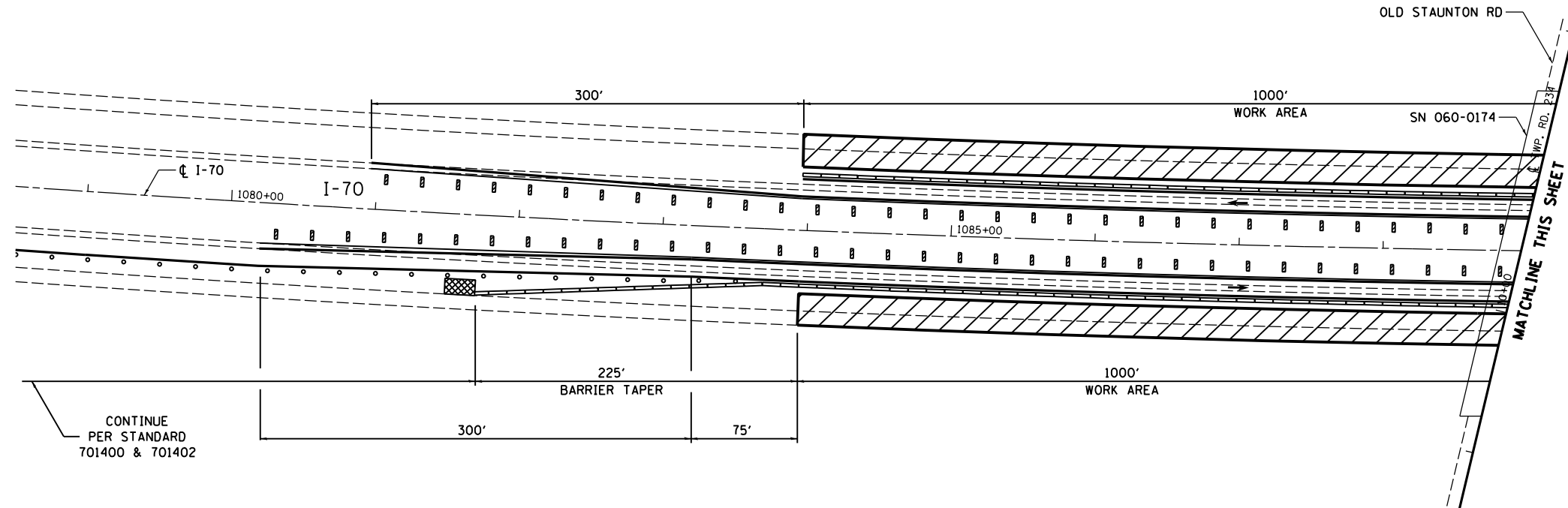

FILE NAME =	USER NAME = hoffmanj	DESIGNED - TN	REVISED -	<b>STATE OF ILLINOIS DEPARTMENT OF TRANSPORTATION</b>	<b>TRAFFIC CONTROL AND PROTECTION SPECIAL I-70 UNDER OLD STAUNTON ROAD - STAGE 2</b>	F.A.I. RTE.	SECTION	COUNTY	TOTAL SHEETS	SHEET NO.
CH2MHILL	60-(11,12) RS-3	MADISON	242			95				
PLOT SCALE = 100.0000' / in.	CHECKED - GL	REVISED -	<b>DRAWING NO. CONTRACT NO. 76F13</b>							
PLOT DATE = 6/27/2014	DATE - 4/18/2014	REVISED -	ILLINOIS FED. AID PROJECT							
					SCALE:	SHEET NO. 2 OF 24 SHEETS	STA.	TO STA.		