

LEGEND	
	WORK AREA
	IMPACT ATTENUATOR, TEMPORARY (NON-REDIRECTIVE) TEST LEVEL 3
	DIRECTION OF TRAVEL/LANE MAINTAINED
	BARRICADES OR DRUMS
	VERTICAL PANELS
	TEMPORARY CONCRETE BARRIER
	TEMPORARY PAVEMENT MARKING

- NOTES:**
1. REFER TO STANDARD 701400 FOR SIGNING AND MARKING OF APPROACH TO LANE CLOSURE
 2. REFER TO STANDARD 701402 FOR SIGNING AND MARKING OF LANE CLOSURE
 3. REFER TO SPECIAL PROVISIONS FOR WORK INCLUDED IN THIS STAGE

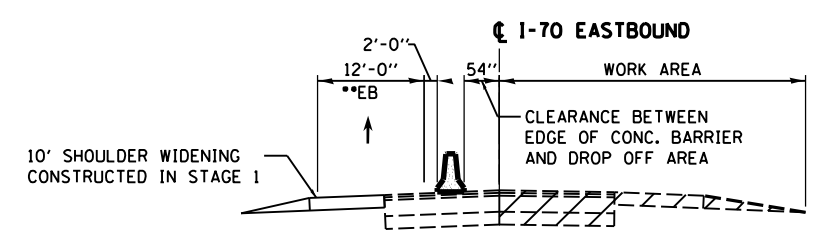

•• LANES SHIFTED AS SHOWN IN STAGING PLANS

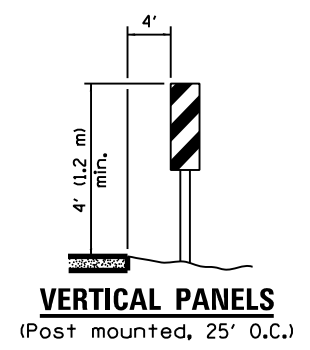
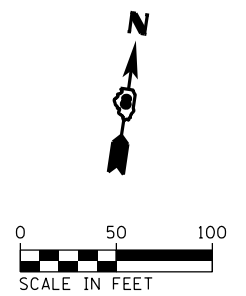
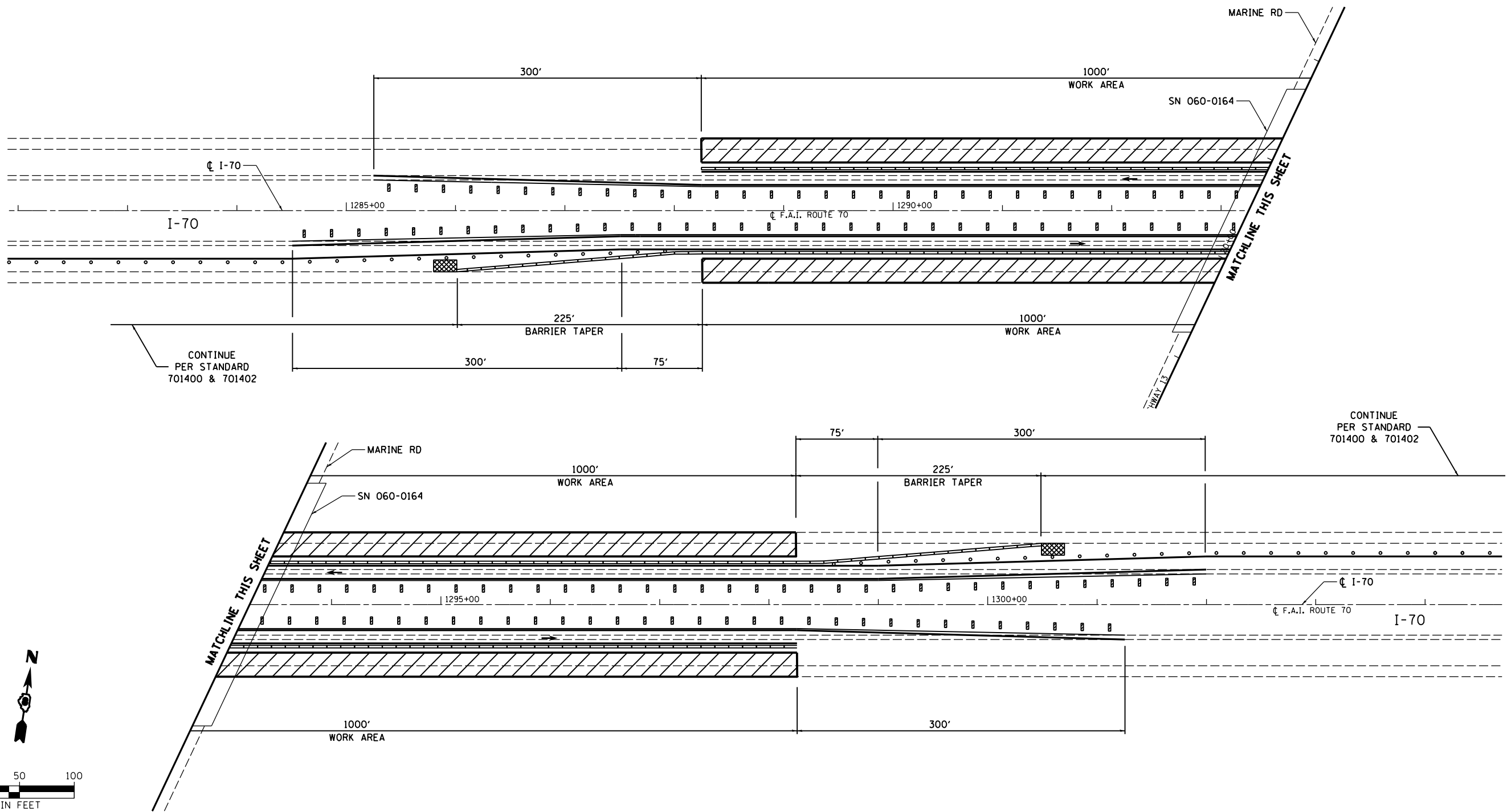

FILE NAME = c:\pwwork\pwwork\hoffmanj\20279918\2014\76f13-sht-staging-10.dgn CH2MHILL	USER NAME = hoffmanj PLOT SCALE = 100.0000' / 1"	DESIGNED - TN DRAWN - JH CHECKED - GL DATE - 4/18/2014	REVISED - REVISED - REVISED - REVISED -	STATE OF ILLINOIS DEPARTMENT OF TRANSPORTATION	TRAFFIC CONTROL AND PROTECTION SPECIAL I-70 UNDER MARINE RD - STAGE 2	F.A.I. RTE. = 70 SECTION = 60-(11,12) RS-3 COUNTY = MADISON TOTAL SHEETS = 242 SHEET NO. = 103	DRAWING NO. CONTRACT NO. 76F13	ILLINOIS FED. AID PROJECT
	PLOT DATE = 6/27/2014	DATE - 4/18/2014	SCALE: SHEET NO. 10 OF 24 SHEETS STA. TO STA.			ILLINOIS FED. AID PROJECT		