

P.T. STA. = 1199+77

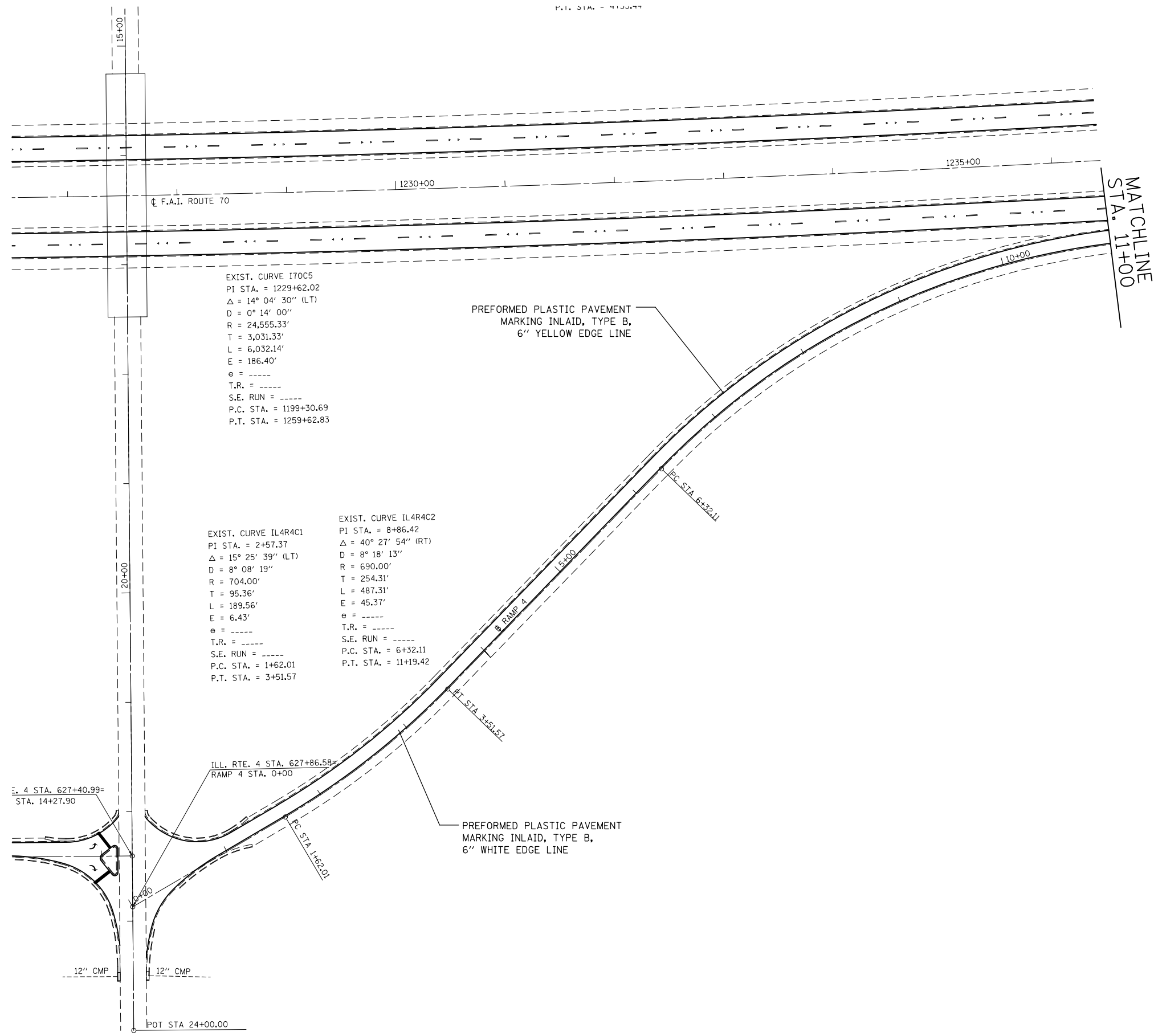

EXIST. CURVE I70C5  
 PI STA. = 1229+62.02  
 $\Delta = 14^\circ 04' 30''$  (LT)  
 $D = 0^\circ 14' 00''$   
 $R = 24,555.33'$   
 $T = 3,031.33'$   
 $L = 6,032.14'$   
 $E = 186.40'$   
 $e = \text{-----}$   
 $T.R. = \text{-----}$   
 $S.E. RUN = \text{-----}$   
 $P.C. STA. = 1199+30.69$   
 $P.T. STA. = 1259+62.83$

EXIST. CURVE IL4R4C1  
 PI STA. = 2+57.37  
 $\Delta = 15^\circ 25' 39''$  (LT)  
 $D = 8^\circ 08' 19''$   
 $R = 704.00'$   
 $T = 95.36'$   
 $L = 189.56'$   
 $E = 6.43'$   
 $e = \text{-----}$   
 $T.R. = \text{-----}$   
 $S.E. RUN = \text{-----}$   
 $P.C. STA. = 1+62.01$   
 $P.T. STA. = 3+51.57$

EXIST. CURVE IL4R4C2  
 PI STA. = 8+86.42  
 $\Delta = 40^\circ 27' 54''$  (RT)  
 $D = 8^\circ 18' 13''$   
 $R = 690.00'$   
 $T = 254.31'$   
 $L = 487.31'$   
 $E = 45.37'$   
 $e = \text{-----}$   
 $T.R. = \text{-----}$   
 $S.E. RUN = \text{-----}$   
 $P.C. STA. = 6+32.11$   
 $P.T. STA. = 11+19.42$

MATCHLINE  
 STA. 11+00

PREFORMED PLASTIC PAVEMENT  
 MARKING INLAID, TYPE B,  
 6" YELLOW EDGE LINE

PREFORMED PLASTIC PAVEMENT  
 MARKING INLAID, TYPE B,  
 6" WHITE EDGE LINE

ILL. RTE. 4 STA. 627+40.99 =  
 STA. 14+27.90

ILL. RTE. 4 STA. 627+86.58 =  
 RAMP 4 STA. 0+00

12" CMP

12" CMP

POT STA 24+00.00

FILE NAME =	USER NAME = milleraj	DESIGNED -	REVISED -
et:\pwork\pwork\milleraj\20279918\187613-sht-pmk.dgn		DRAWN -	REVISED -
PLOT SCALE = 100.0000' / in.		CHECKED -	REVISED -
PLOT DATE = 6/27/2014		DATE -	REVISED -

STATE OF ILLINOIS  
 DEPARTMENT OF TRANSPORTATION

IL 4 RAMP IV PAVEMENT MARKING PLAN

SCALE: 20 SHEET NO. 46 OF 49 SHEETS STA. TO STA.

F.A.I. RTE.	SECTION	COUNTY	TOTAL SHEETS	SHEET NO.
70	60-(11,12)RS-3	MADISON	242	170
CONTRACT NO. 76F13				
FED. ROAD DIST. NO. ILLINOIS FED. AID PROJECT				