

|                     |          |                   |              |           |
|---------------------|----------|-------------------|--------------|-----------|
| F.A.P. RTE.         | SECTION  | COUNTY            | TOTAL SHEETS | SHEET NO. |
| 335                 | 119R-2   | LAKE              | 439          | 53        |
| STA. 432+83.12      |          | TO STA. 470+56.84 |              |           |
| FED. ROAD DIST. NO. | ILLINOIS | FED. AID PROJECT  |              |           |

60B01

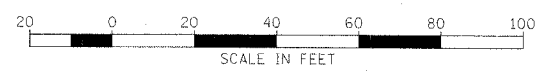
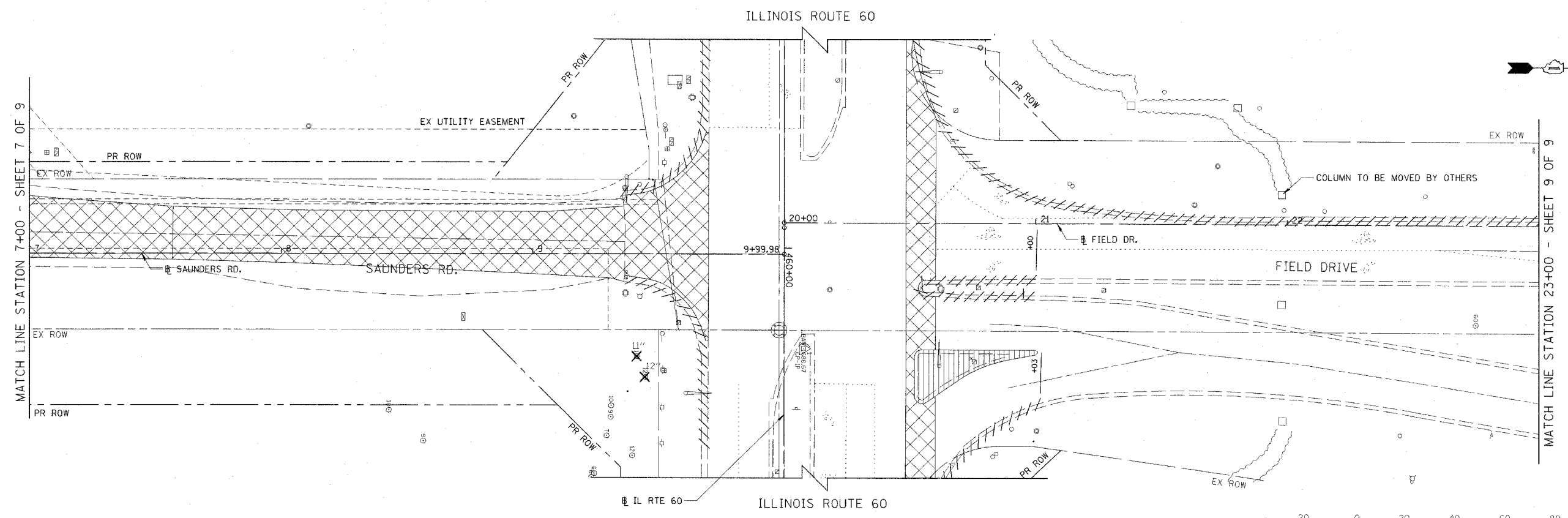

- LEGEND:
- CONC CURB & GUTTER REMOVAL
  - PAVEMENT REMOVAL
  - ISLAND REMOVAL
  - RELOCATE EXISTING ROADSIDE FEATURE
  - TREE REMOVAL
  - REMOVAL

**CHRISTOPHER B. BURKE ENGINEERING LTD.**  
 9575 West Higgins Road, Suite 100  
 Rosemont, Illinois 60018  
 (847) 822-0000

| REVISIONS |      |
|-----------|------|
| NAME      | DATE |
|           |      |
|           |      |
|           |      |
|           |      |
|           |      |
|           |      |
|           |      |
|           |      |
|           |      |
|           |      |

ILLINOIS DEPARTMENT OF TRANSPORTATION  
 ILLINOIS RTE 60 OVER I-94  
 SAUNDERS ROAD/FIELD DRIVE  
 EXISTING CONDITIONS AND REMOVAL  
 STA. 7+00.00 TO STA. 23+00  
 SHEET 8 OF 9

SCALE: 1"=20'  
 DATE: MAY 8, 2007  
 DRAWN BY: GT  
 CHECKED BY: MCW

M:\LakeForest\03992\CH0392\_S\IND-62.PEM 5/2/2007 9:37:27 AM