

F.A.P. RTE.	SECTION	COUNTY	TOTAL SHEETS	SHEET NO.
335	119R-2	LAKE	439	174
STA. 432+83.12		TO STA. 470+56.84		
FED. ROAD DIST. NO.		ILLINOIS FED. AID PROJECT		

60B01

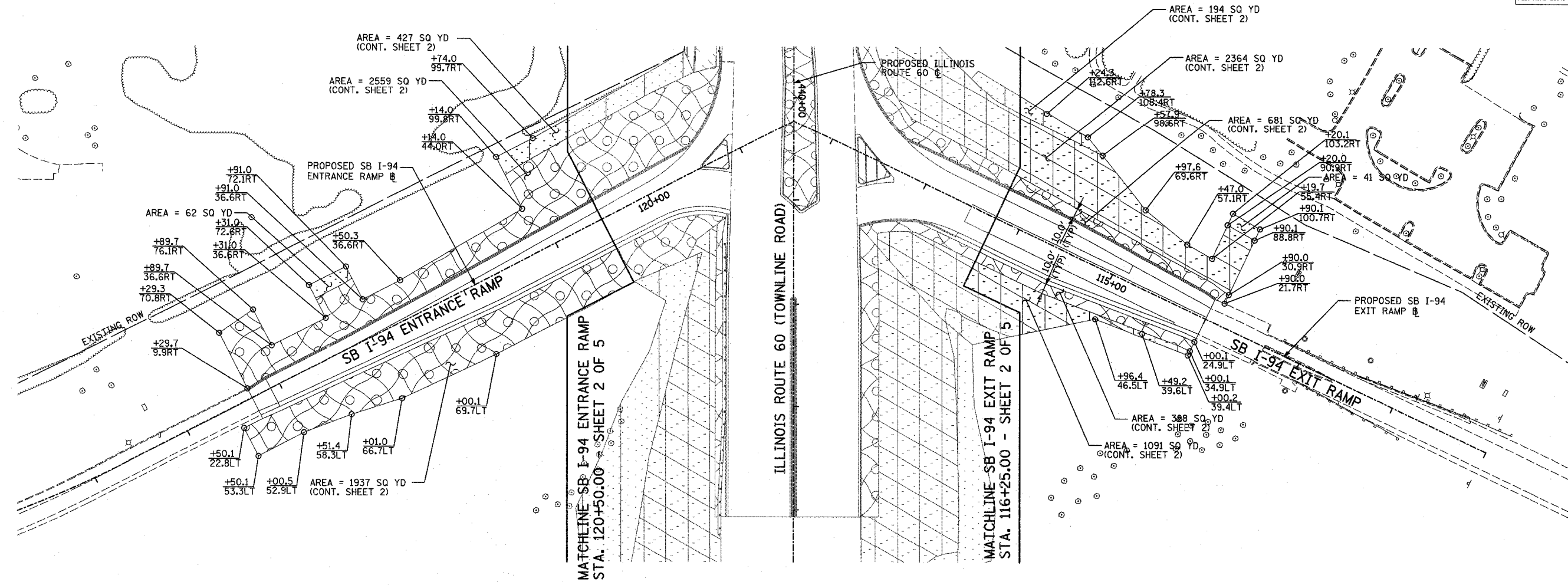

- LEGEND:**
- SEEDING CLASS 2A, 4" TOPSOIL AND NUTRIENTS WITH EROSION CONTROL BLANKET
  - SEEDING CLASS 3, 4" TOPSOIL AND NUTRIENTS WITH EROSION CONTROL BLANKET
  - SEEDING CLASS 4A, 4" TOPSOIL AND NUTRIENTS WITH EROSION CONTROL BLANKET
  - SODDING, 4" TOPSOIL AND NUTRIENTS

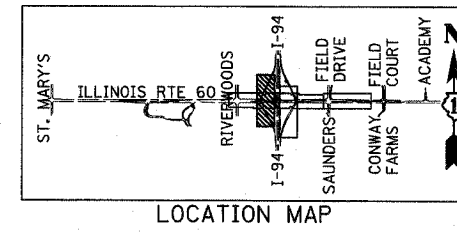
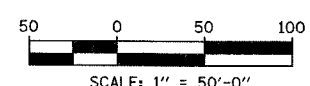

REVISIONS	
NAME	DATE

ILLINOIS DEPARTMENT OF TRANSPORTATION  
 ILLINOIS RTE 60 OVER I-94  
 LANDSCAPING PLANS  
 SOUTHBOUND INTERSTATE 94 RAMPS  
 SHEET 4 OF 5

SCALE: 1"=50'-0" DRAWN BY: CBS  
 DATE: MAY 8, 2007 CHECKED BY: MPG

TYLIN INTERNATIONAL

05/07/2007 12:42:00 PM