

F.A.P. RTE.	SECTION	COUNTY	TOTAL SHEETS	SHEET NO.
335	119R-2	LAKE	439	179
STA. 432+83.12		TO STA. 470+56.84		
FED. ROAD DIST. NO.		ILLINOIS FED. AID PROJECT		

60B01



**SIGNING LEGEND:**

- - - EXISTING GROUND MOUNTED SIGN
- - - PROPOSED GROUND MOUNTED SIGN
- R1-1 - SEE PROPOSED SIGNING LEGEND AND SCHEDULE
- PROPOSED LARGE SIGN PANEL (SEE SIGN PANEL DETAILS AND SCHEDULE)

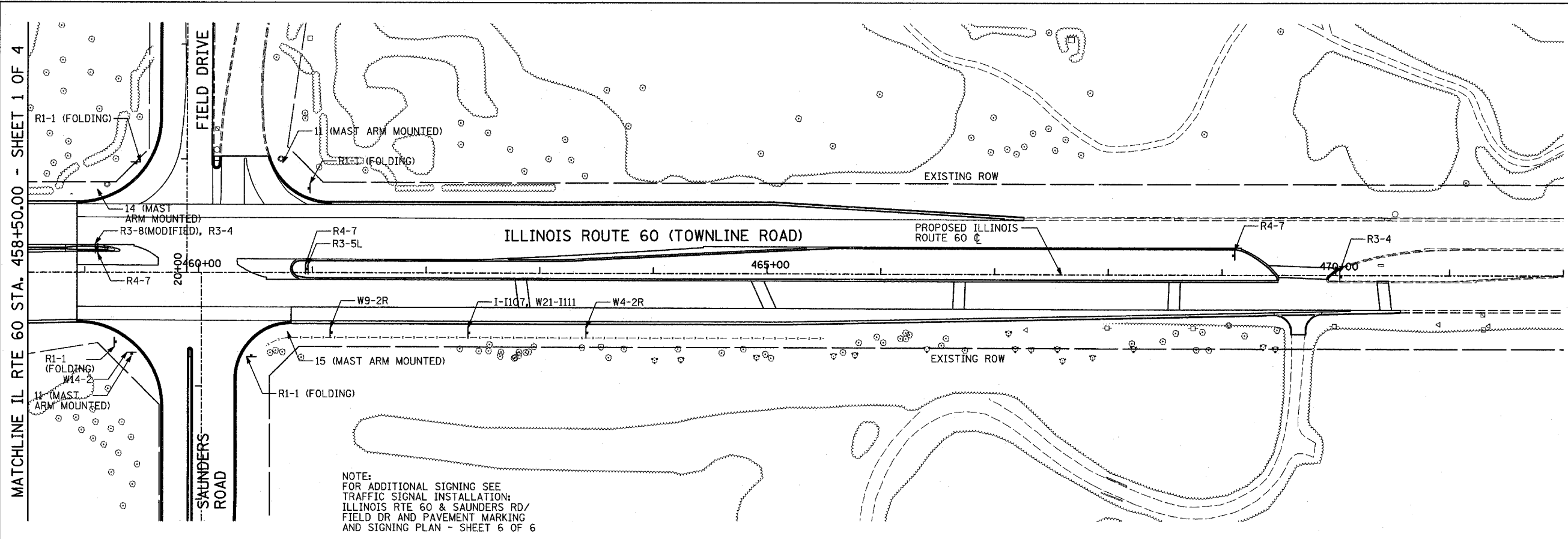

MATCHLINE IL RTE 60 STA. 458+50.00 - SHEET 1 OF 4

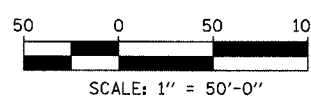
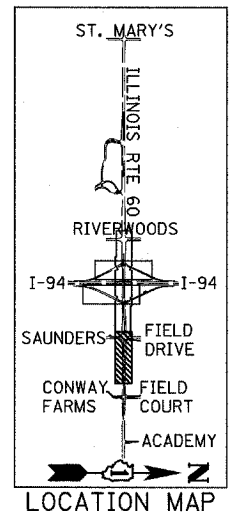

REVISIONS	
NAME	DATE

ILLINOIS DEPARTMENT OF TRANSPORTATION  
ILLINOIS RTE 60 OVER I-94  
  
PROPOSED SIGNING PLAN  
IL RTE 60 STA. 458+50.00 TO 470+56.84  
SHEET 2 OF 4

SCALE: 1"=50'-0"  
DATE: MAY 8, 2007  
DRAWN BY: AMB  
CHECKED BY: MPF

**TYLIN** INTERNATIONAL