

F.A.P. RTE.	SECTION	COUNTY	TOTAL SHEETS	SHEET NO.
335	119R-2	LAKE	439	226
STA.	TO STA.			
FED. ROAD DIST. NO.	ILLINOIS	FED. AID PROJECT		

60B01

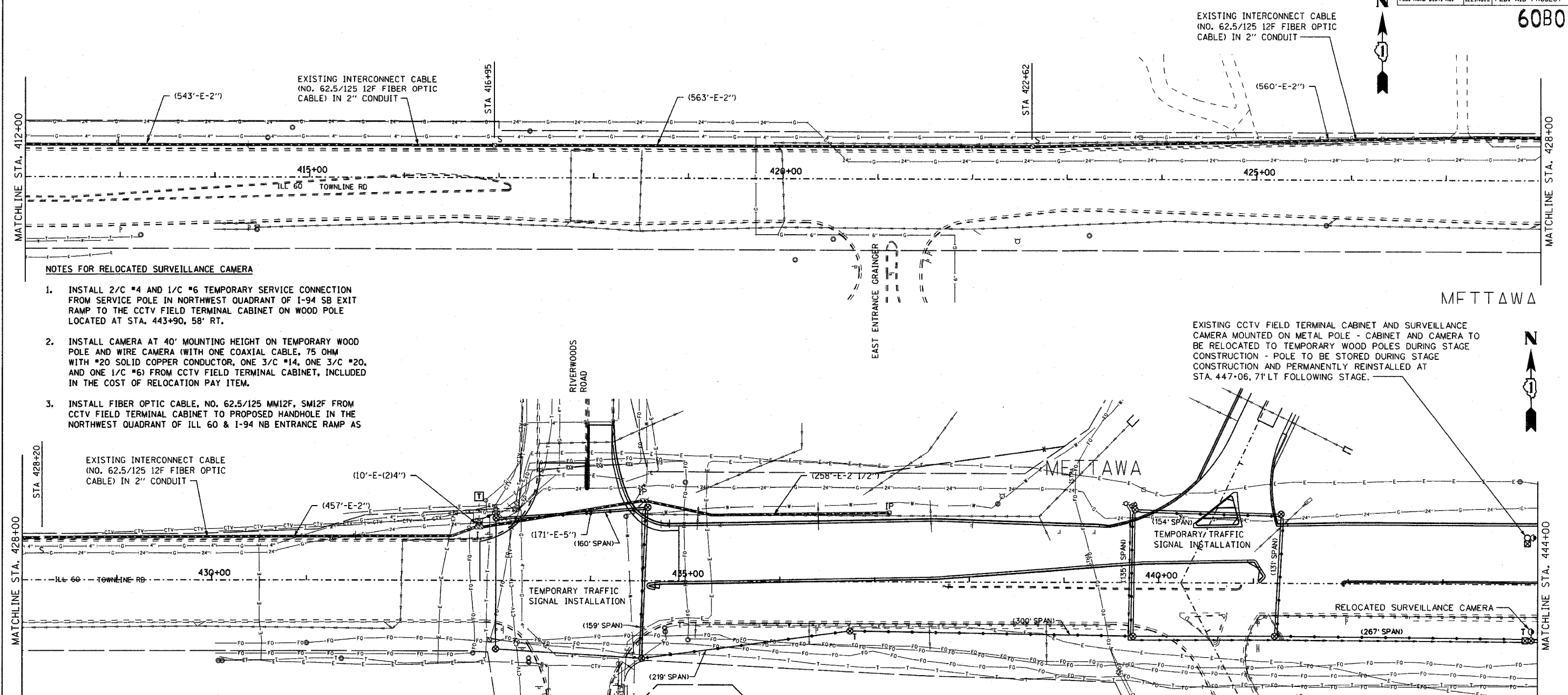

NOTES FOR RELOCATED SURVEILLANCE CAMERA

1. INSTALL 2/C #4 AND 1/C #6 TEMPORARY SERVICE CONNECTION FROM SERVICE POLE IN NORTHWEST QUADRANT OF I-94 SB EXIT RAMP TO THE CCTV FIELD TERMINAL CABINET ON WOOD POLE LOCATED AT STA. 443+90, 58' RT.
2. INSTALL CAMERA AT 40' MOUNTING HEIGHT ON TEMPORARY WOOD POLE AND WIRE CAMERA (WITH ONE COAXIAL CABLE, 75 OHM WITH #20 SOLID COPPER CONDUCTOR, ONE 3/C #14, ONE 3/C #20, AND ONE 1/C #6) FROM CCTV FIELD TERMINAL CABINET, INCLUDED IN THE COST OF RELOCATION PAY ITEM.
3. INSTALL FIBER OPTIC CABLE, NO. 62.5/125 MM12F, SM12F FROM CCTV FIELD TERMINAL CABINET TO PROPOSED HANDHOLE IN THE NORTHWEST QUADRANT OF ILL 60 & I-94 NB ENTRANCE RAMP AS

EXISTING CCTV FIELD TERMINAL CABINET AND SURVEILLANCE CAMERA MOUNTED ON METAL POLE - CABINET AND CAMERA TO BE RELOCATED TO TEMPORARY WOOD POLES DURING STAGE CONSTRUCTION - POLE TO BE STORED DURING STAGE CONSTRUCTION AND PERMANENTLY REINSTALLED AT STA. 447+06, 71' LT FOLLOWING STAGE.

4. SHOWN ON THE PLANS VIA TEMPORARY INTERCONNECT AND TEMPORARY TRAFFIC SIGNAL WOOD POLES. TEMPORARY CONNECT TO EXISTING FIBER OPTIC CABLE VIDEO FEED IN HANDHOLE.
5. CONNECT TEMPORARY FIBER OPTIC CABLE TO EXISTING 24 FIBER OPTIC CABLE IN PROPOSED HANDHOLE WHICH GOES TO TOLLWAY PLAZA BOOTH ON NORTHBOUND ENTRANCE RAMP.
6. ALL TEMPORARY AERIAL SERVICE AND FIBER OPTIC CABLE SHALL BE SUPPORTED BY TETHER WIRE, INCLUDED IN THE COST OF THE TEMPORARY TRAFFIC SIGNAL PAY ITEM.
7. ALL TEMPORARY CABLE TO BE INCLUDED IN THE COST OF RELOCATE EXISTING SURVEILLANCE CAMERA, CABINET, AND POLE.

8. FOLLOWING COMPLETION OF STAGE CONSTRUCTION, THE EXISTING FIBER OPTIC 24F CABLE FROM TEMPORARY LOCATED SURVEILLANCE CAMERA TO TOLLWAY PLAZA BOOTH SHALL BE REMOVED TO FACILITATE REPLACEMENT WITH A NEW FIBER OPTIC CABLE TO TOLLWAY PLAZA BOOTH.
9. USE EXISTING FIBER OPTIC 12F CABLE FOR TEMPORARY INTERCONNECT - FROM ST. MARY'S ROAD CONTROLLER CABINET TO RIVERWOODS ROAD CONTROLLER CABINET, ALL STAGES.

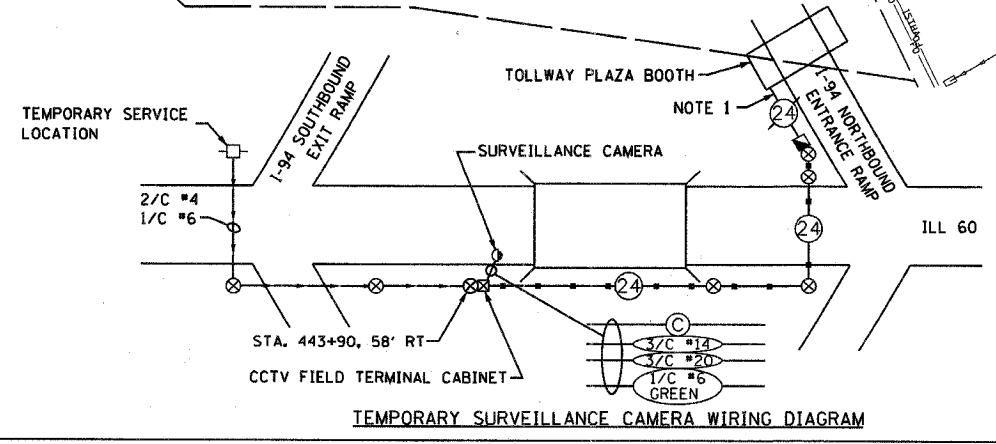

- Ⓢ COAXIAL CABLE, 75 OHM WITH #20 AWG SOLID COPPER CONDUCTOR
- Ⓣ FIBER OPTIC CABLE, NO. 65.2/125, MM12F, SM12F, AND TRACER NO. 14 1/C

REVISIONS	
NAME	DATE

ILLINOIS DEPARTMENT OF TRANSPORTATION
 TEMPORARY INTERCONNECT PLAN
 TEMP. SURVEILLANCE CAMERA INSTALL.
 ILL ROUTE 60
 ST. MARY'S ROAD TO ACADEMY DRIVE
 STAGES 1, 1A, 2

S.N. DESIGNED BY: JM
 SCALE: 1" = 50'-0" DRAWN BY: PK
 DATE: MAY 8, 2007 CHECKED BY: GR