

F.A.P. RTE.	SECTION	COUNTY	TOTAL SHEETS	SHEET NO.
335	119R-2	LAKE	439	232
STA.		TO STA.		
FED. ROAD DIST. NO.	ILLINOIS	FED. AID PROJECT		

60B01

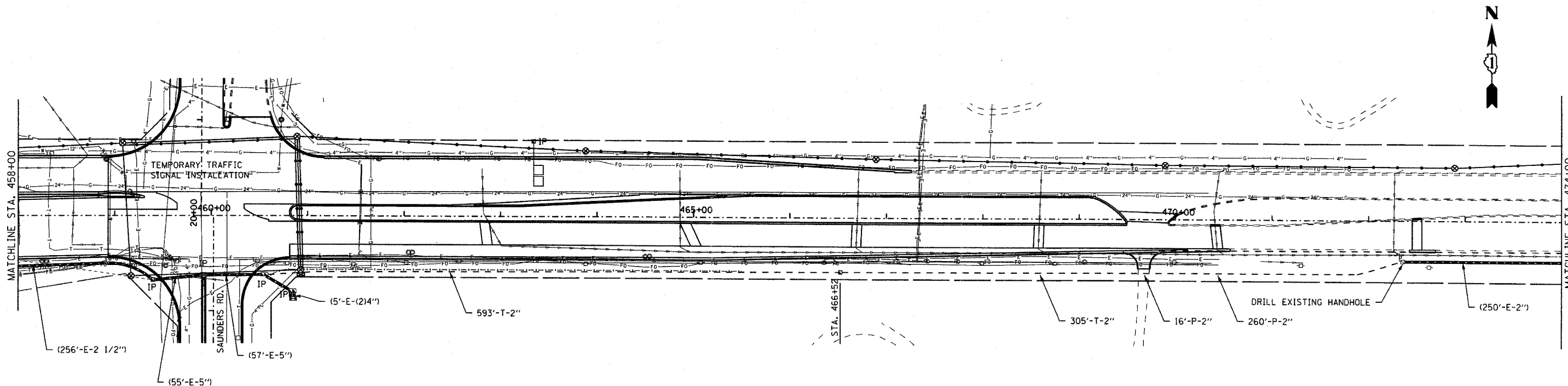
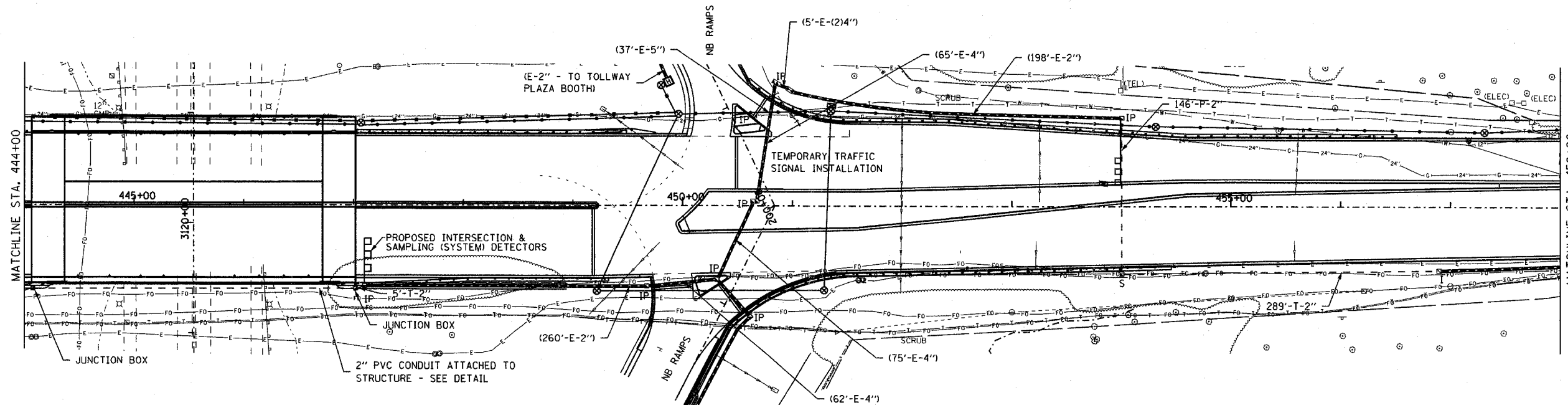

EJM **EJM ENGINEERING, INC.**
 411 South Wells Street Suite 800
 Chicago, Illinois 60607

REVISIONS	
NAME	DATE

ILLINOIS DEPARTMENT OF TRANSPORTATION
TEMPORARY INTERCONNECT PLAN
 STAGES 3, 3, 4, 5
TEMP. SURVEILLANCE CAMERA INSTALLATION
 STAGES 3, 3A, 4, 5
ST. MARY'S ROAD TO ACADEMY DRIVE
 S.N. DESIGNED BY: JM
 SCALE: 1" = 50'-0" DRAWN BY: PK
 DATE: MAY 8, 2007 CHECKED BY: CK