

F.A.P. RTE.	SECTION	COUNTY	TOTAL SHEETS	SHEET NO.
335	119R-2	LAKE	439	371
STA. 432+83.12		TO STA. 470+56.84		
FED. ROAD DIST. NO.	ILLINOIS	FED. AID PROJECT		
		120	130	140

NOTE: PRE-STAGE EARTHWORK ADDITIONS/SUBTRACTIONS ARE NOT INCLUDED IN THE EARTHWORK QUANTITIES FOR EACH CROSS SECTION (SEE EARTHWORK SCHEDULE FOR BREAKDOWN OF QUANTITIES BY STAGE).

EARTHWORK QUANTITIES (SF)	
EXCAVATION	= 70.9
UNSUITABLE	= 0.0
EMBANKMENT	= 27.0
EXC.(SPECIAL)	= 0.0

EARTHWORK QUANTITIES (SF)	
EXCAVATION	= 79.1
UNSUITABLE	= 81.5
EMBANKMENT	= 324.9
EXC.(SPECIAL)	= 41.9

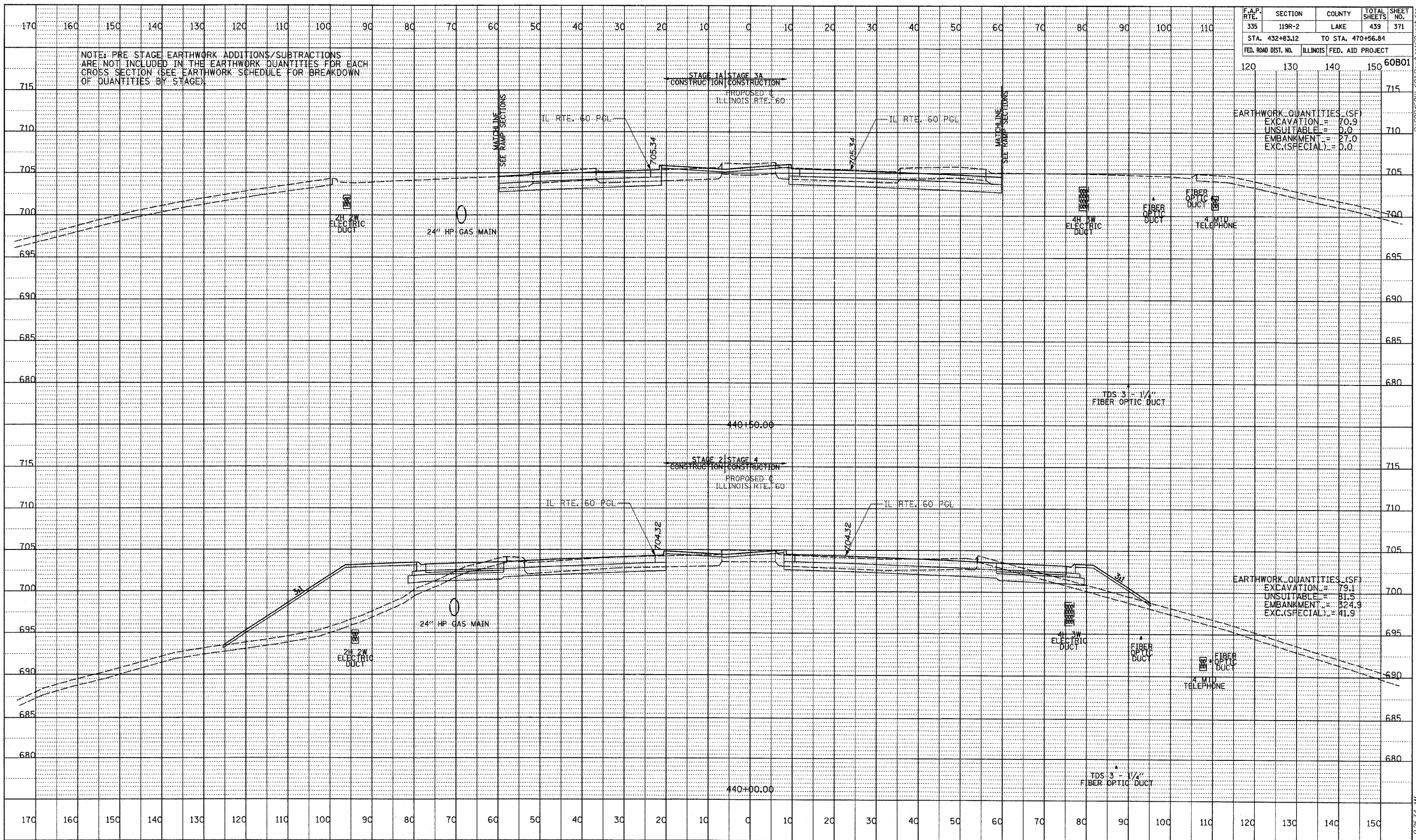

PROFILE	DATE
REVISION	BY
PLANNED	
CHECKED	
STRUCTURE	
NOTATION	
NO.	

TYLIN INTERNATIONAL

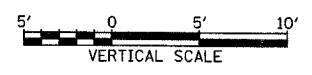
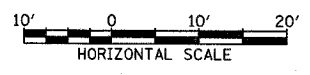

ILLINOIS RTE. 60 (TOWNLIN RD)
STA. 440+00 TO STA. 440+50

P:\60245811\601\Road\60R60\60R60.dwg 5/7/2007 9:25:34 AM