

F.A.P. RTE.	SECTION	COUNTY	TOTAL SHEETS	SHEET NO.
335	119R-2	LAKE	439	373
STA. 432+63.12		TO STA. 470+56.84		
FED. ROAD DIST. NO.	ILLINOIS FED. AID PROJECT		120 130 140 150 60B01	

NOTE: PRE STAGE EARTHWORK ADDITIONS/SUBTRACTIONS ARE NOT INCLUDED IN THE EARTHWORK QUANTITIES FOR EACH CROSS SECTION (SEE EARTHWORK SCHEDULE FOR BREAKDOWN OF QUANTITIES BY STAGE)

EARTHWORK QUANTITIES (SF)  
 EXCAVATION = 58.7  
 UNSUITABLE = 147.8  
 EMBANKMENT = 367.6  
 EXC.(SPECIAL) = 117.8

EARTHWORK QUANTITIES (SF)  
 EXCAVATION = 62.8  
 UNSUITABLE = 136.4  
 EMBANKMENT = 1216.8  
 EXC.(SPECIAL) = 55.3

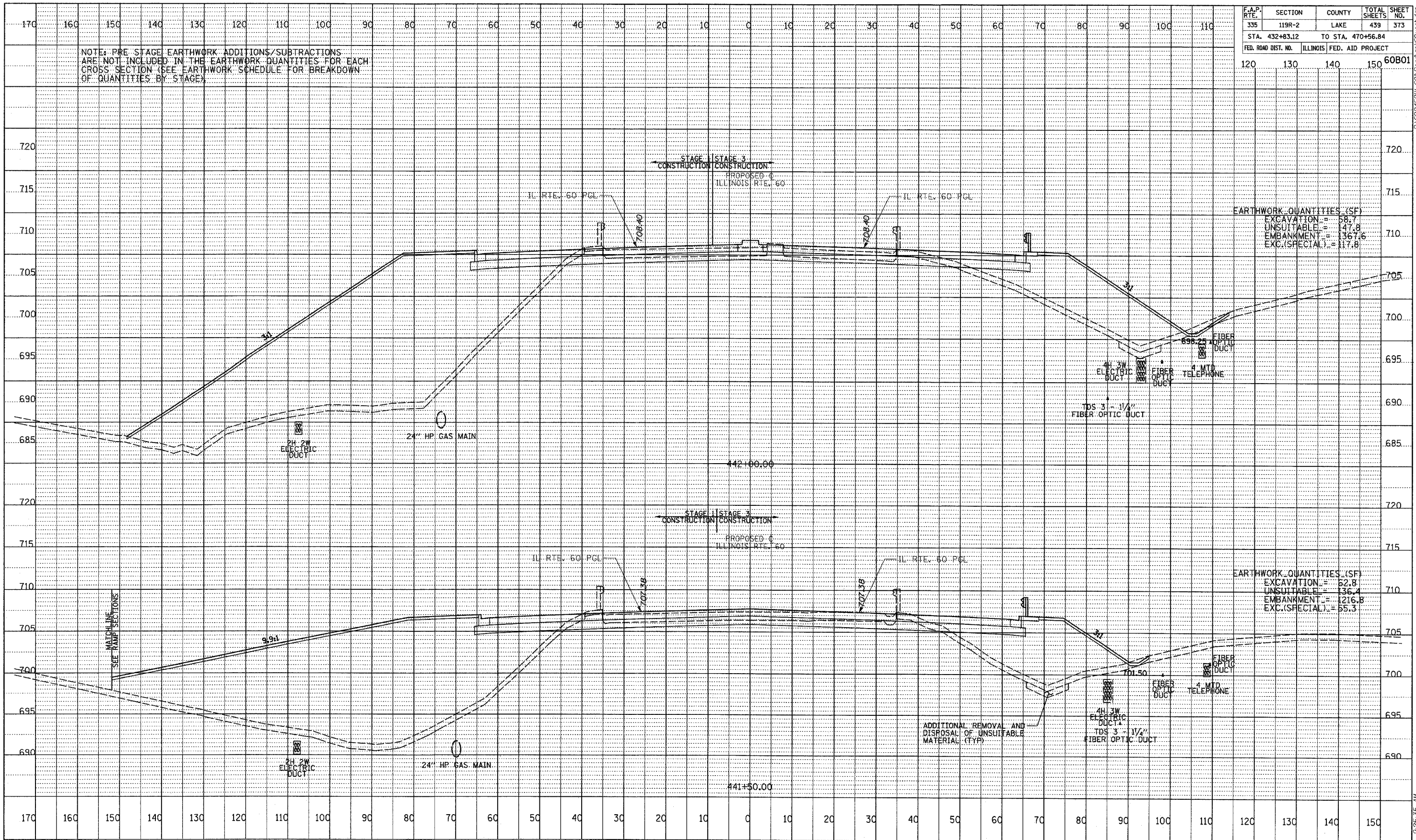

PROFILE	DATE
REVISION	
GRADES CHECKED	
STRUCTURE NOTATIONS CHECKED	
NO.	

TYLIN INTERNATIONAL

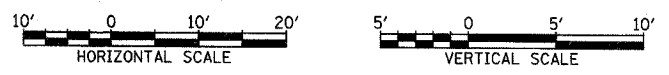

ILLINOIS RTE. 60 (TOWNLIN RD)  
 STA. 441+50 TO STA. 442+00

P:\6024581\450V\road\ap60x373.dwg 5/7/2007 9:25:35 AM