

F.A.P. RTE.	SECTION	COUNTY	TOTAL SHEETS	SHEET NO.
335	119R-2	LAKE	439	382
STA. 432+83.12		TO STA. 470+56.84		
FED. ROAD DIST. NO.		ILLINOIS	FED. AID PROJECT	
120	130	140	150	60B01

NOTE: PRE-STAGE EARTHWORK ADDITIONS/SUBTRACTIONS ARE NOT INCLUDED IN THE EARTHWORK QUANTITIES FOR EACH CROSS SECTION (SEE EARTHWORK SCHEDULE FOR BREAKDOWN OF QUANTITIES BY STAGE)

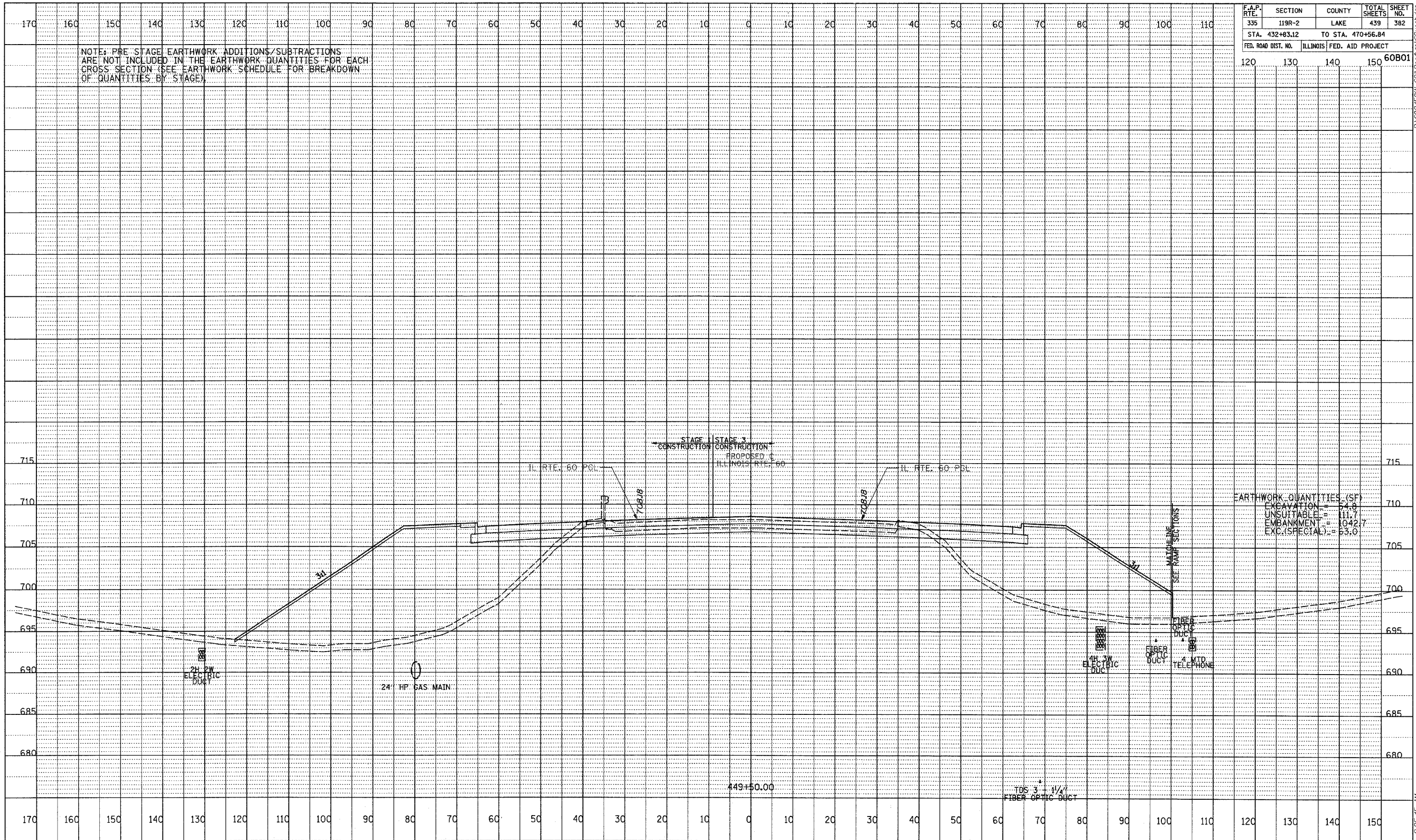

EARTHWORK QUANTITIES (SF)

EXCAVATION	= 54.8
UNSUITABLE	= 111.7
EMBANKMENT	= 1042.7
EXC. (SPECIAL)	= 53.0

DATE	
BY	
REVISION	
NO.	
DESCRIPTION	

TYLIN INTERNATIONAL

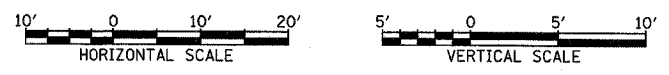

ILLINOIS RTE. 60 (TOWNLIN RD)
STA. 449+50

5/7/2007 9:25:45 AM