

F.A.P. RTE.	SECTION	COUNTY	TOTAL SHEETS	SHEET NO.
335	119R-2	LAKE	439	401
STA. 432+83.12		TO STA. 470+56.84		
FED. ROAD DIST. NO.		ILLINOIS	FED. AID PROJECT	
			120	130
			140	150
			60B01	

EARTHWORK QUANTITIES (SF)	
EXCAVATION	= 35.5
UNSUITABLE	= 44.2
EMBANKMENT	= 29.9
EXC.(SPECIAL)	= 0.0

EARTHWORK QUANTITIES (SF)	
EXCAVATION	= 37.7
UNSUITABLE	= 44.6
EMBANKMENT	= 28.4
EXC.(SPECIAL)	= 0.0

EARTHWORK QUANTITIES (SF)	
EXCAVATION	= 42.4
UNSUITABLE	= 44.0
EMBANKMENT	= 19.8
EXC.(SPECIAL)	= 0.0

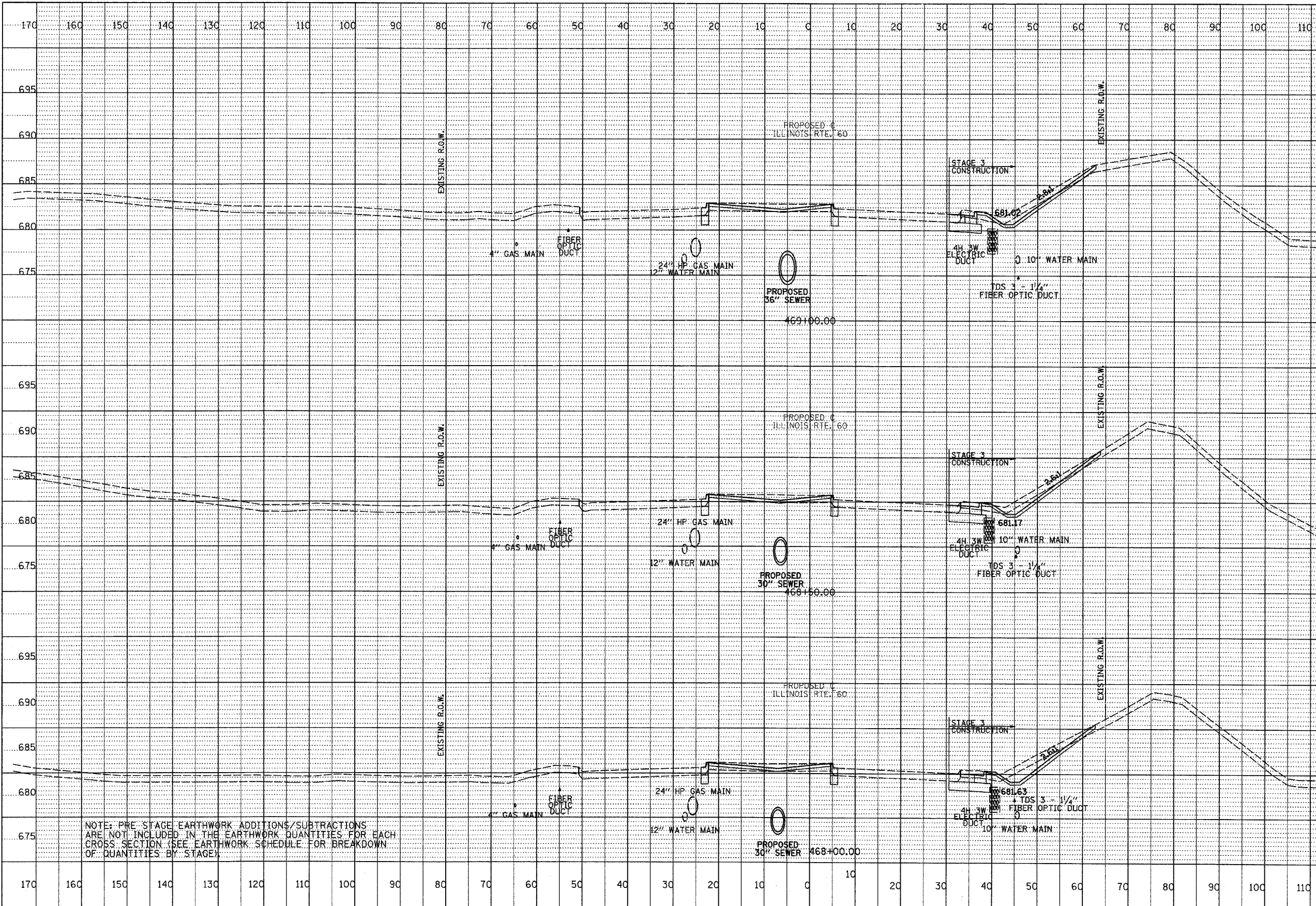

NOTE: PRE STAGE EARTHWORK ADDITIONS/SUBTRACTIONS ARE NOT INCLUDED IN THE EARTHWORK QUANTITIES FOR EACH CROSS SECTION (SEE EARTHWORK SCHEDULE FOR BREAKDOWN OF QUANTITIES BY STAGE)

PROFILE	DATE
REVISIONS	BY
REVISED	
DATE	
NO.	
STRUCTURE NOTATION: CPKD	

TYLIN INTERNATIONAL

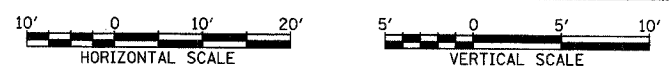

ILLINOIS RTE. 60 (TOWNLIN RD)
STA. 468+00 TO STA. 469+00

5/7/2007 9:25:56 AM