

PROFILE
 DRAWN BY: _____ BY: _____ DATE: _____
 CHECKED BY: _____
 GRADES CHECKED BY: _____
 STRUCTURE NOTATIONS CHECKED BY: _____

F.A.P. RTE.	SECTION	COUNTY	TOTAL SHEETS	SHEET NO.
335	119R-2	LAKE	439	407
STA. 432+83.12		TO STA. 470+56.84		
FED. ROAD DIST. NO.		ILLINOIS FED. AID PROJECT		60B01

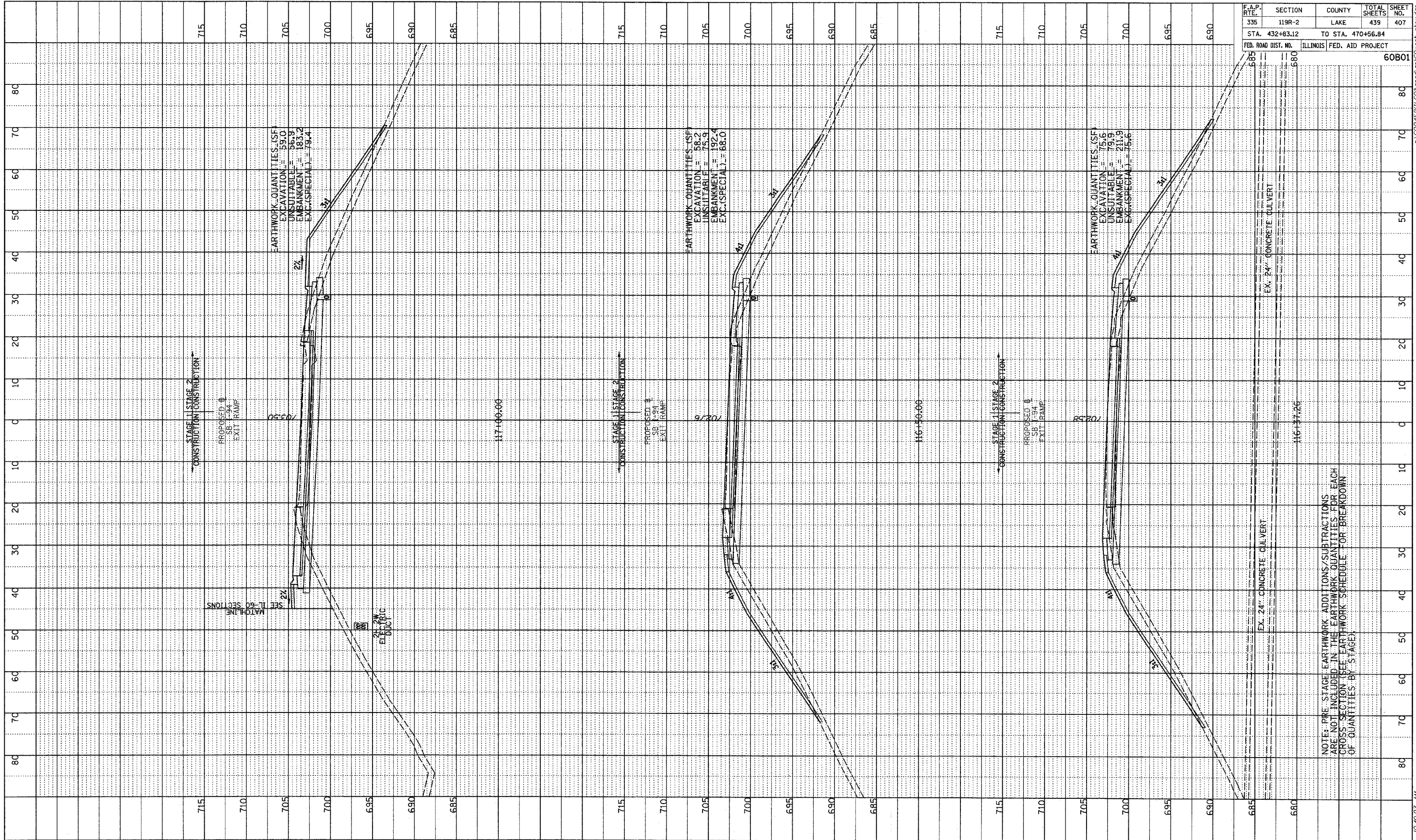

TYLIN INTERNATIONAL

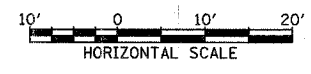

SB I-94 EXIT RAMP
 STA. 116+37.26 TO STA. 117+00

5/7/2007 10:40:23 AM P:\60245811-60\read\gmk\60\ssn-sbox.dgn