

PROFILE SHEET
 DRAWN BY: _____ DATE: _____
 CHECKED BY: _____ DATE: _____
 NOTE BOOK NO. _____
 STRUCTURE NO. _____

| F.A.P. RTE. | SECTION | COUNTY | TOTAL SHEETS | SHEET NO. |
|---------------------|---------|---------------------------|--------------|-----------|
| 335 | 119R-2 | LAKE | 439 | 408 |
| STA. 432+83.12 | | TO STA. 470+56.84 | | |
| FED. ROAD DIST. NO. | | ILLINOIS FED. AID PROJECT | | 60B01 |

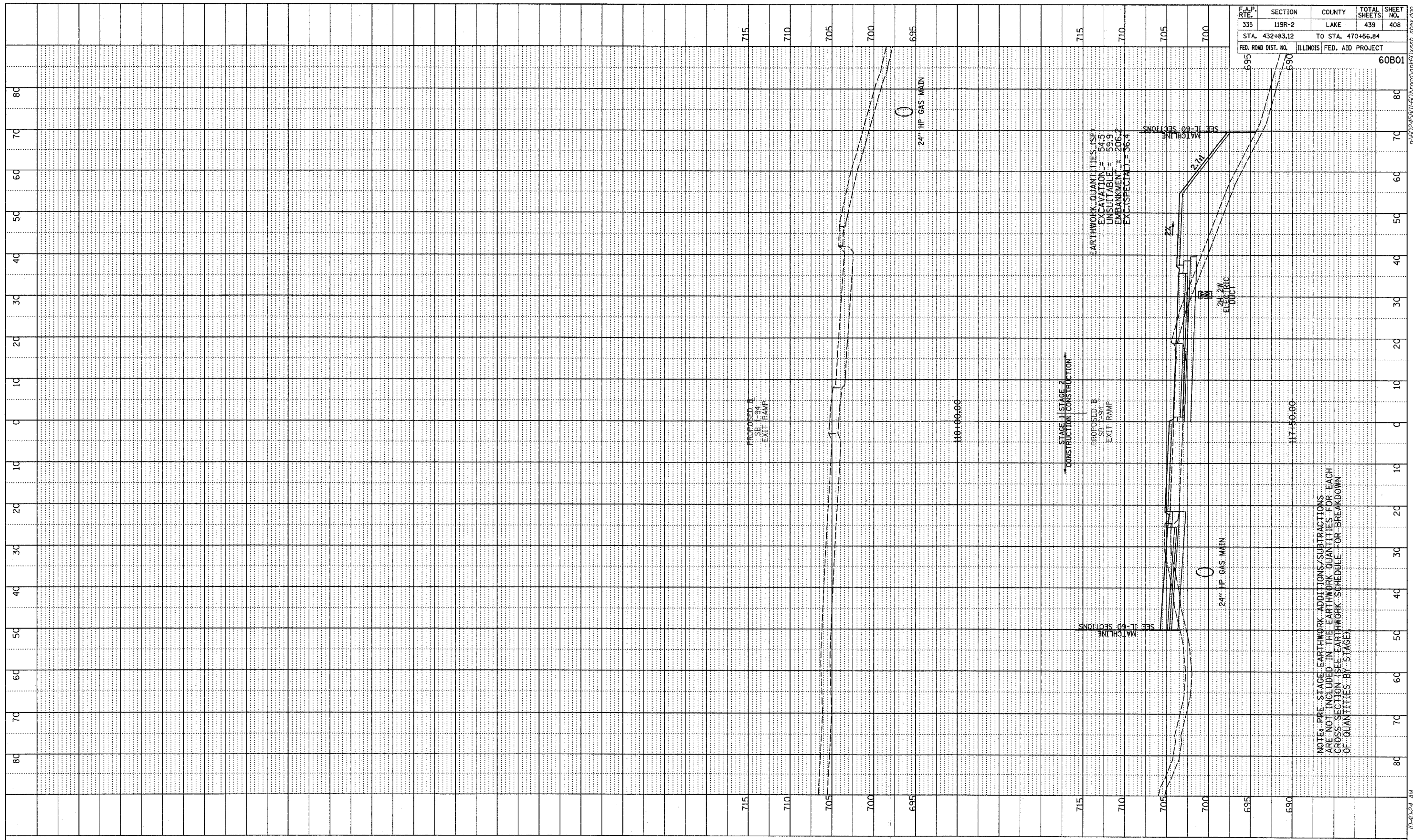

EARTHWORK QUANTITIES (SF)
 EXCAVATION = 54.5
 UNSUITABLE = 59.9
 EMBANKMENT = 206.2
 EXC. (SPECTAL) = 36.4

NOTES: PRE-STAGE EARTHWORK ADDITIONS/SUBTRACTIONS ARE NOT INCLUDED IN THE EARTHWORK QUANTITIES FOR EACH CROSS SECTION (SEE EARTHWORK SCHEDULE FOR BREAKDOWN OF QUANTITIES BY STAGE)

TYLIN INTERNATIONAL

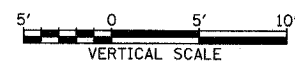
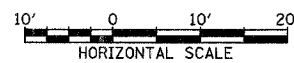

SB I-94 EXIT RAMP
 STA. 117+50 TO STA. 118+00

P:\60245811-60\Drawings\60B01\sheet_408.dgn 5/7/2007 10:40:24 AM