

PROFILE (SWERVED) DRAWN BY DATE  
 PLOTTED (CHECKED) BY  
 NOTE BOOK (S.A. NOTED) BY  
 INC. (STRUCTURE NOTATIONS) (P) (P)

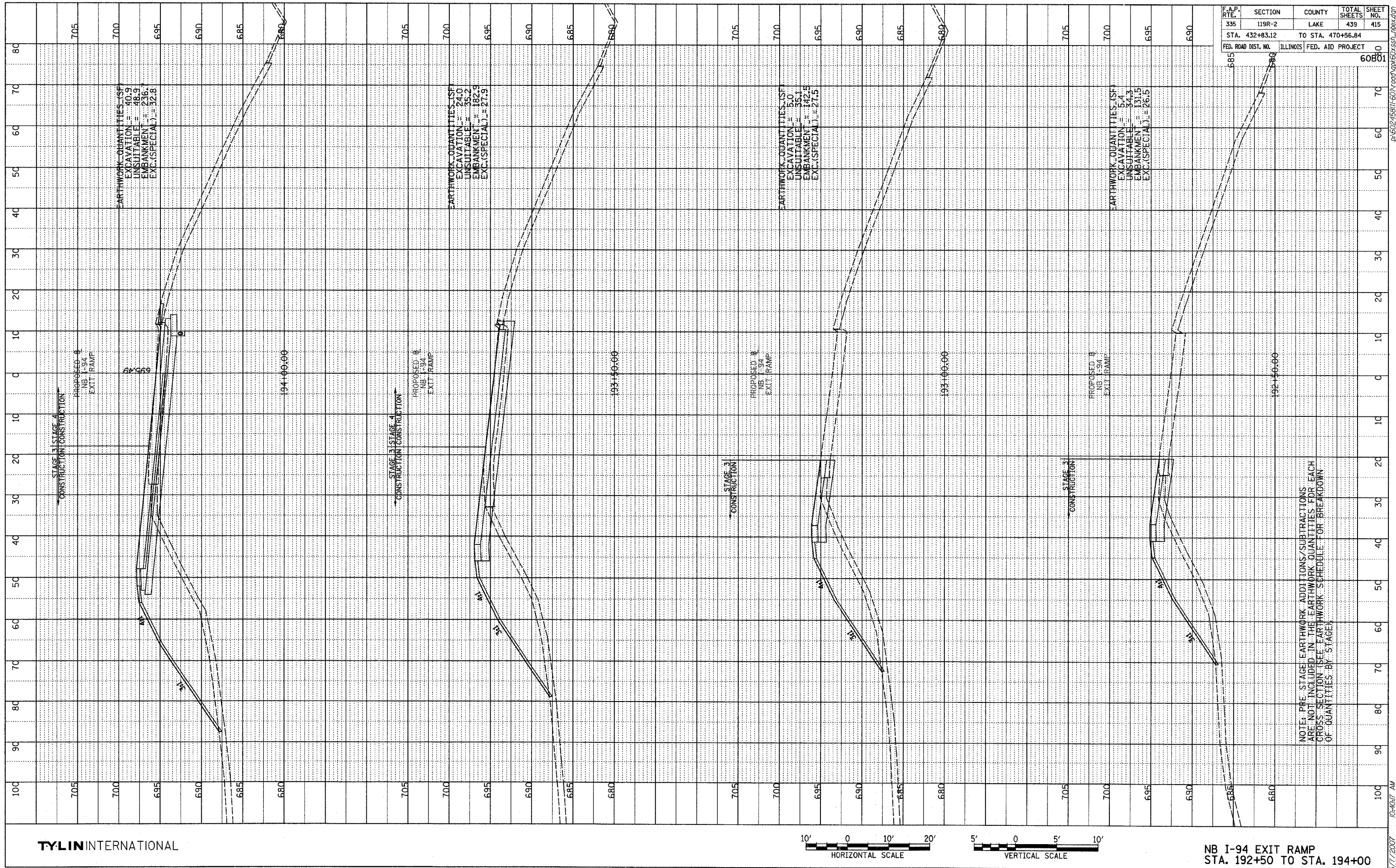

F.A.P. RTE.	SECTION	COUNTY	TOTAL SHEETS	SHEET NO.
335	119R-2	LAKE	439	415
STA. 432+83.12		TO STA. 470+56.84		
FED. ROAD DIST. NO.		ILLINOIS FED. AID PROJECT		
				60B01

TYLIN INTERNATIONAL

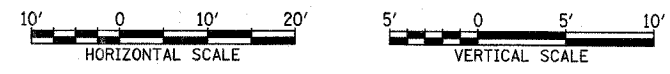

NB I-94 EXIT RAMP  
 STA. 192+50 TO STA. 194+00

NOTE: PRE-STAGE EARTHWORK ADDITIONS/SUBTRACTIONS ARE NOT INCLUDED IN THE EARTHWORK QUANTITIES FOR EACH CROSS SECTION (SEE EARTHWORK SCHEDULE FOR BREAKDOWN OF QUANTITIES BY STAGE).

5/7/2007 10:40:17 AM P:\50245811\601\080\080\601\601.dwg