

ALL DIMENSIONS IN METERS EXCEPT PAY ITEMS AND UNLESS NOTED OTHERWISE

F.A.I. RTE.	SECTION	COUNTY	TOTAL SHEETS	SHEET NO.
80/94	2007-03ILS	COOK	51	28
STA.	TO STA.			
FED. ROAD DIST. NO.	ILLINOIS FED. AID PROJECT			
CONTRACT NO. 60D14				

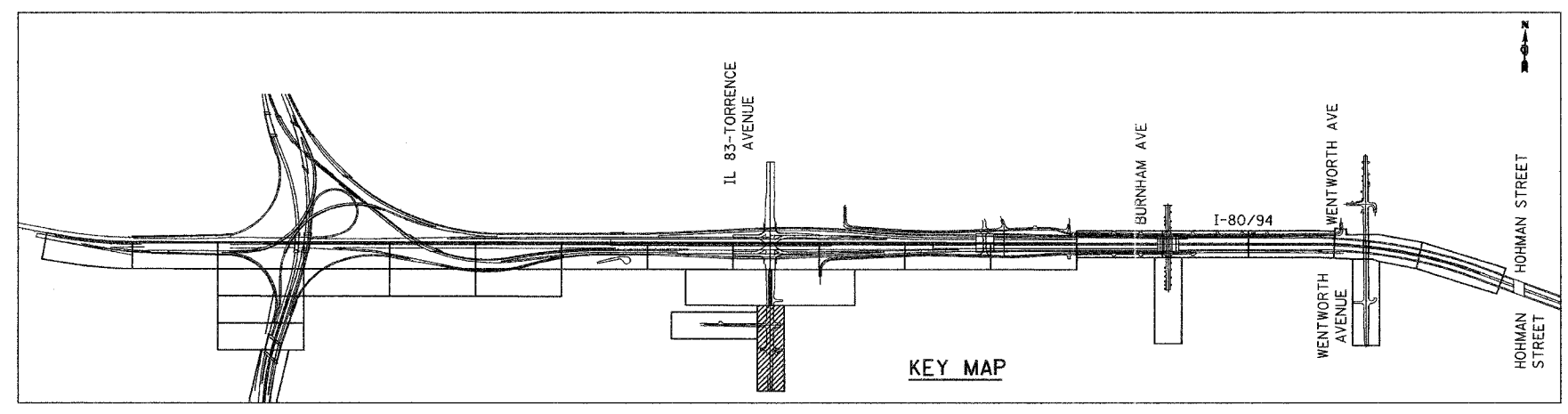
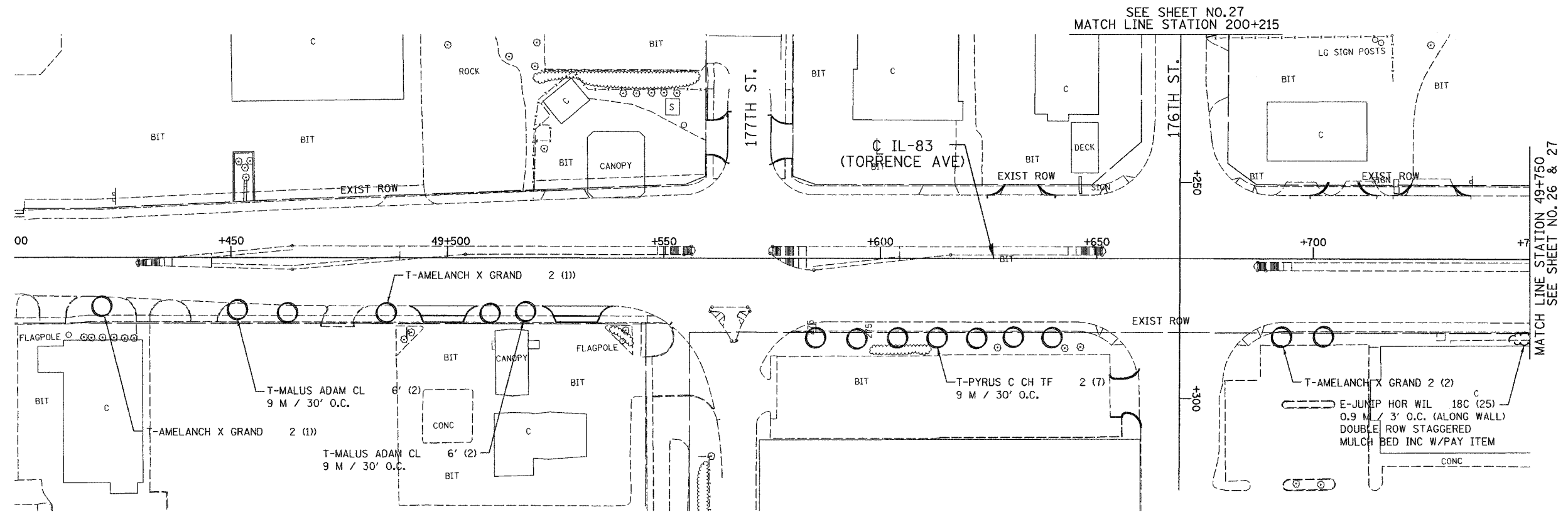
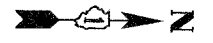

LS83 - 20

REVISIONS	
NAME	DATE

ILLINOIS DEPARTMENT OF TRANSPORTATION
 I-80/94/US 6
 KINGERY-BORMAN EXPRESSWAY
 BURNHAM ROAD TO US 41
LANDSCAPING PLAN
IL 83 - TORRENCE AVE

SCALE 1:500
 DATE 06/07

DRAWN BY ACE/CAD
 CHECKED BY TJW

06/26/2007
 10:55:34 AM
 g:\Project\2074480\CADD\Contract\EB\LS_20.rvt