

F.A.I. RTE.	SECTION	COUNTY	TOTAL SHEETS	SHEET NO.
80/94	2007-03ILS	COOK	51	48
STA.	TO STA.			
FED. ROAD DIST. NO.	ILLINOIS	FED. AID PROJECT		
CONTRACT NO. 60D14				

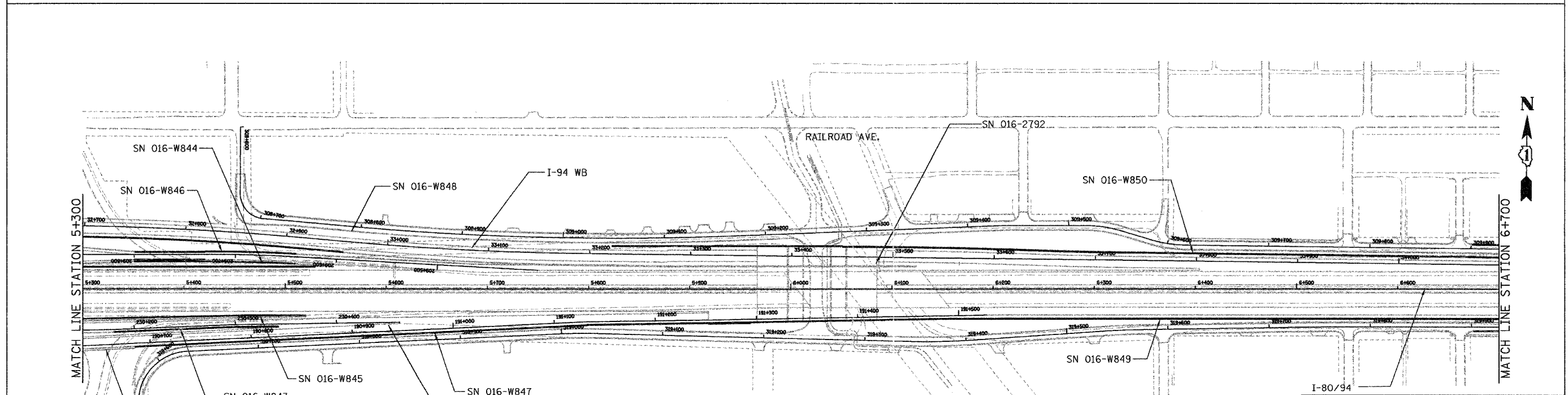
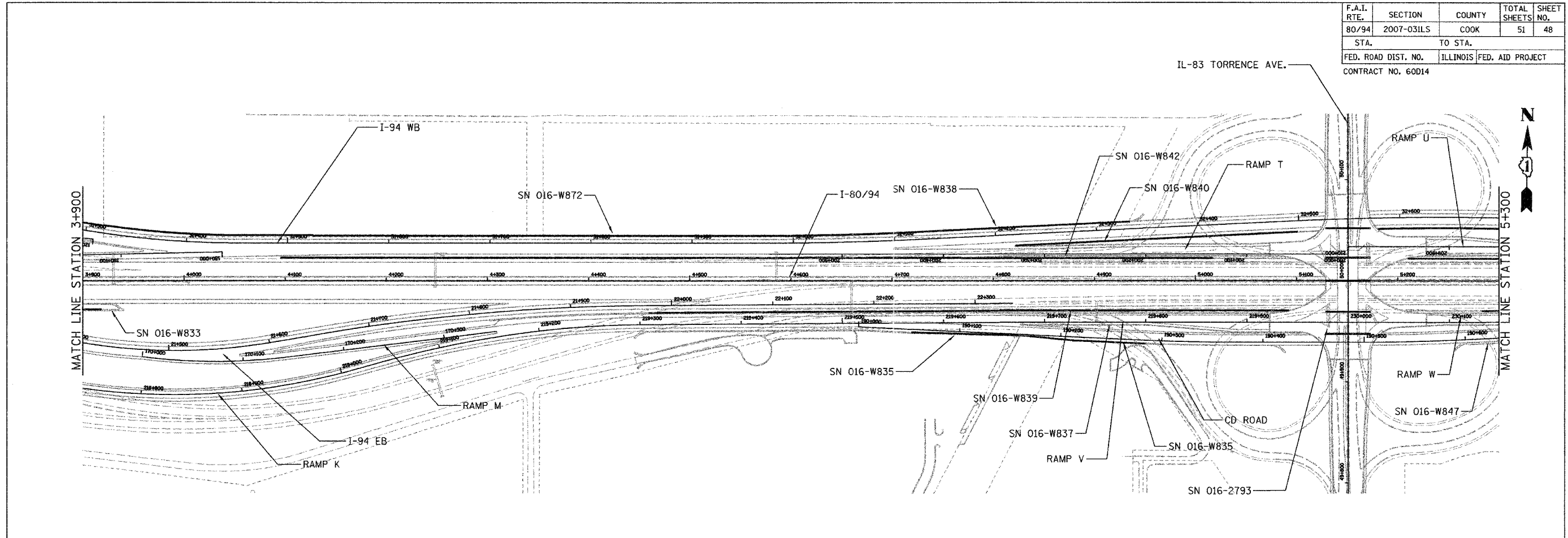

FOR INFORMATION ONLY

REVISIONS	
NAME	DATE

ILLINOIS DEPARTMENT OF TRANSPORTATION  
 I-80/94/US 6 (KINGERY EXPRESSWAY)  
 ROADWAY LIGHTING  
 AND TRAFFIC SURVEILLANCE

**STRUCTURE LOCATION PLAN**  
 STA. 3+900 TO STA. 6+700

SCALE 1:2000 DRAWN BY ACE/CAD  
 DATE 05/08/07 CHECKED BY TJW

**AMERICAN**  
 CONSULTING ENGINEERS