

ROUTE NO.	SECTION	COUNTY	DATE SHEETS	SHEET NO.	SHEET NO. 12 OF 17 SHEETS
533	11 R-1-I-1	McHenry	19	14	
FED. ROAD DIST. XXXX		ILLINOIS		FED. AID PROJECT	

Contract #60D29

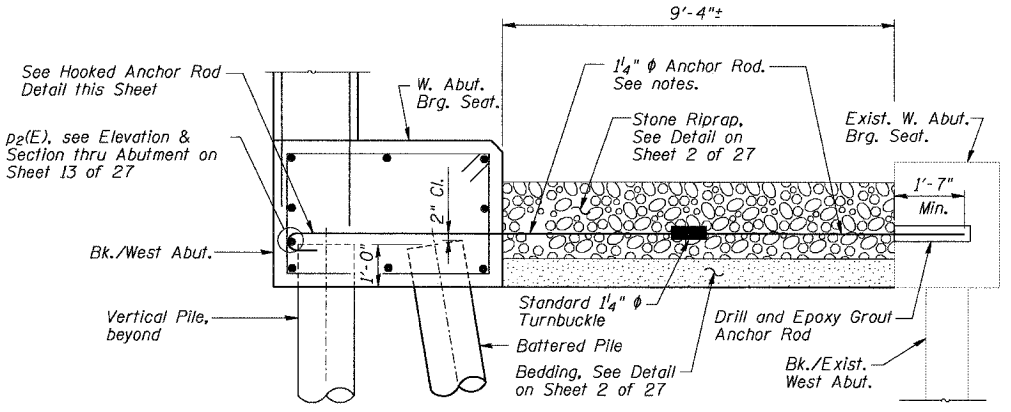
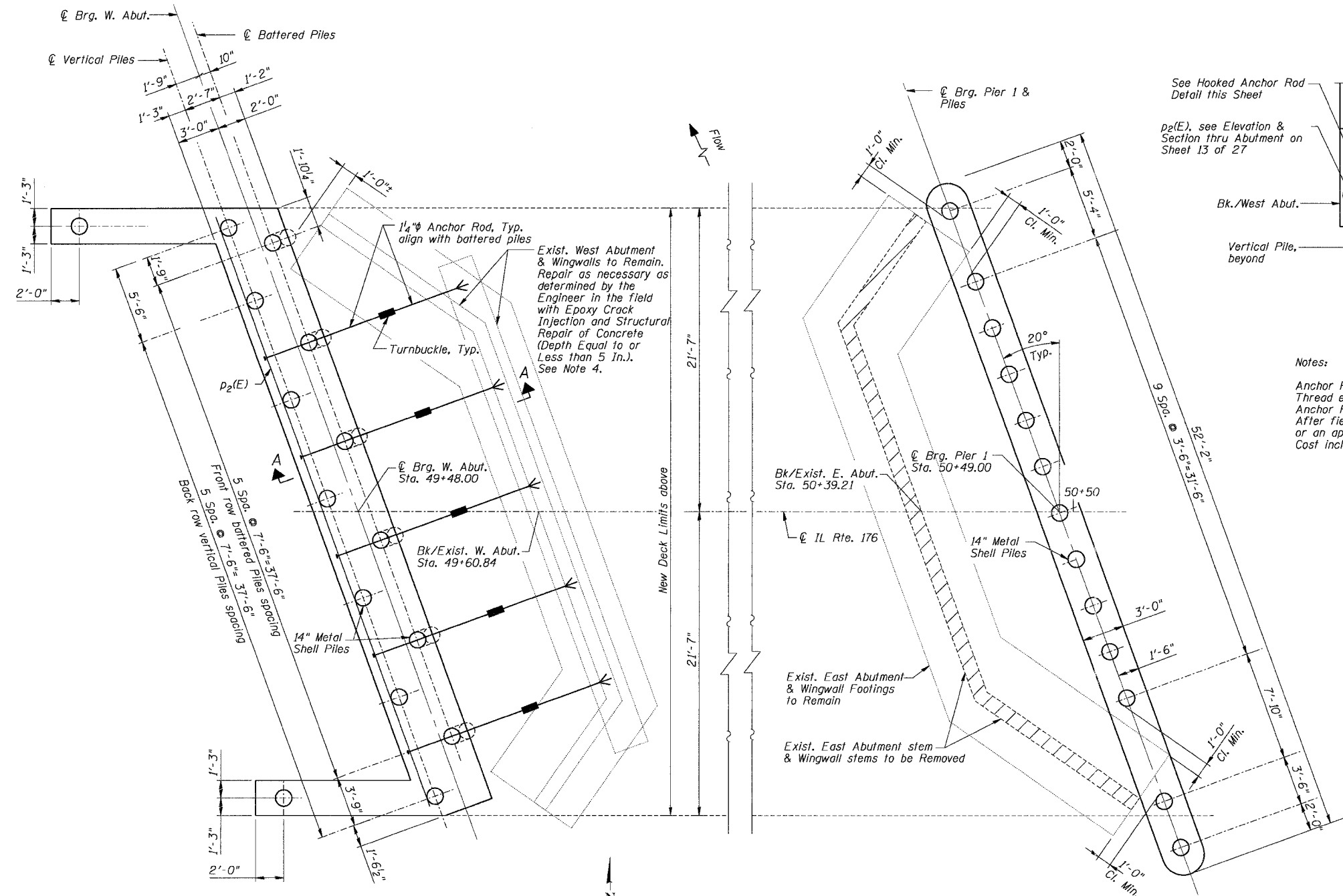

SECTION A-A

Notes:

Anchor Rods shall conform to the requirements of AASHTO M 270, Grade 36. Thread end of Anchor Rod at Turnbuckle min. 9". Anchor Rods and Turnbuckle shall be given one shop coat of Inorganic Zinc Rich Primer. After field installation, tied Anchor Rods and Turnbuckle shall be wrapped with "Tapecoat-CT" or an approved equal in accordance with the manufacturer's recommendations. Cost included in payment for Pay Item "Furnishing and Installing Tied Anchor Rod Assembly".

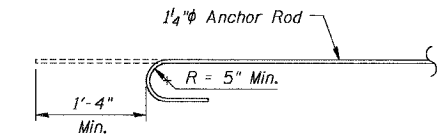

HOOKED ANCHOR ROD DETAIL

BILL OF MATERIAL

Item	Unit	Total
Epoxy Crack Injection	Foot	20
Structural Repair of Concrete (Depth Equal to or Less than 5 In.)	Sq. Ft.	20
Furnishing and Installing Tied Anchor Rod Assembly	Each	5

FOR INFORMATION ONLY

WEST ABUTMENT & PIER 1
PILE LAYOUT
IL Route 176 over
South Branch of the Kishwaukee River
F.A.P. RTE 533, SECTION 11 R-1-I-1
MCHENRY COUNTY
STATION 51+50.00
DATE: 06-29-07 S.N. 056-0071
GRAEF, ANHALT, SCHLOEMER & ASSOCIATES INC
CHICAGO ILLINOIS

LEGEND

DESIGNED	S.S.T.
CHECKED	S.D.H.
DRAWN	E.B.
CHECKED	S.S.T.

- Existing Structure to remain in place
- Existing Structure to be removed
- New Structures

Notes:

- Work this Sheet with Sheets 13 and 15 of 27.
- Plan dimensions and details relative to existing structure have been taken from existing plans and are subject to nominal construction variations. It shall be the Contractor's responsibility to verify such dimensions and details in the field and make necessary approved adjustments prior to construction or ordering of materials. Such variations shall not be cause for additional compensation for a change in the scope of the work, however, the Contractor will be paid for the quantity actually furnished at the unit price bid for the work.
- Top of exist. abutments are braced by exist. superstructure. Removal of existing superstructure shall not occur until top of Existing West Abutment has been secured to New West Abutment. See Section A-A this Sheet.
- Quantities for Epoxy Crack Injection and Structural Repair of Concrete (Depth Equal to or Less than 5 In.) have been estimated. Actual quantities will be determined by the Engineer in the field. Payment will be made for actual quantities furnished.

N:\Jobs\006\1010\1\South Branch Steel\176-Fig-A12.dgn
6/29/07 2:00 PM
3:01:05 PM