

F.A.U. RTE.	SECTION	COUNTY	TOTAL SHEETS	SHEET NO.
3528	2001-143 RS	COOK	19	6
STA. 115+00		TO STA. 145+00		
FED. ROAD DIST. NO.		ILLINOIS	FED. AID PROJECT	

CONTRACT NO. 62322

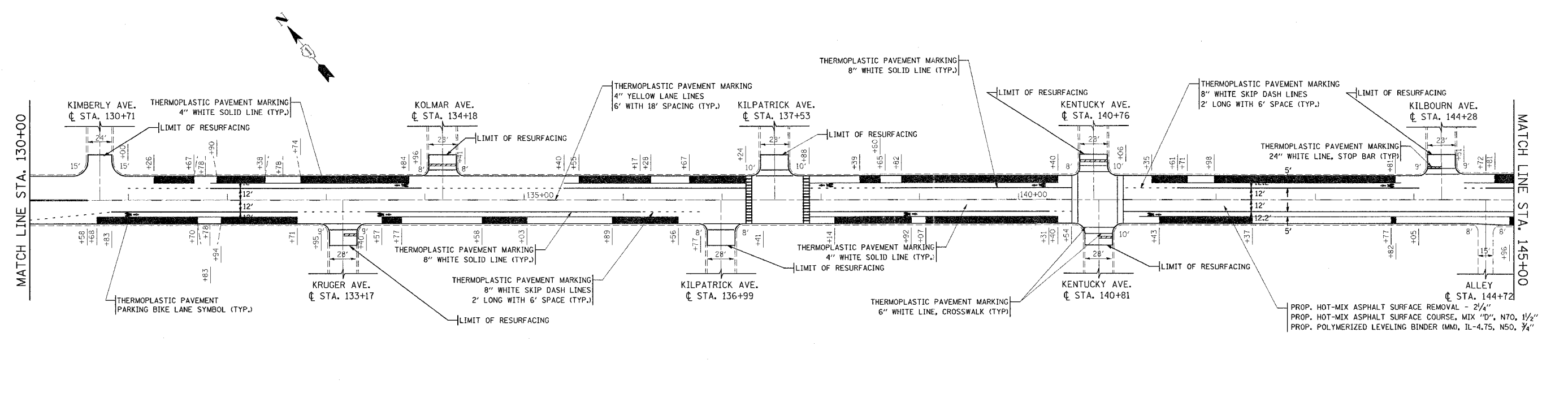
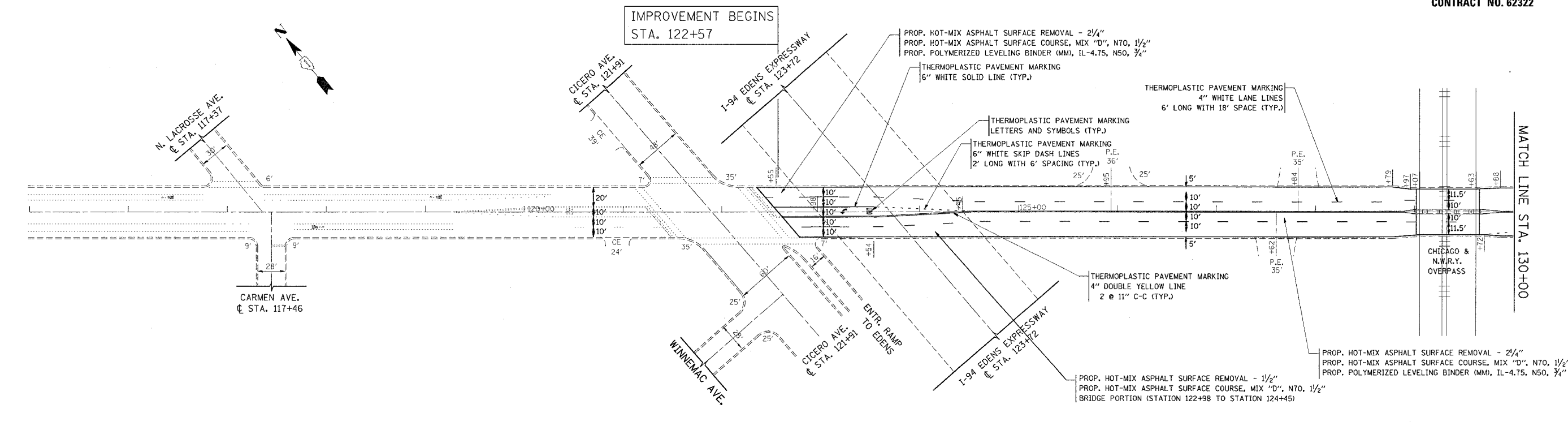

NOTES:

PERMANENT PAVEMENT MARKINGS OF THE BRIDGE PORTION SHALL BE THERMOPLASTIC (OF THE EXTRUDED TYPE) AND SHOULD BE PLACED IN ACCORDANCE WITH "CITY OF CHICAGO TYPICAL PAVEMENT MARKINGS" DETAIL (TC-24).

REVISIONS	
NAME	DATE

ILLINOIS DEPARTMENT OF TRANSPORTATION
 F.A.U. 3528 - ELSTON AVENUE
 ILL 50 TO LOWELL AVE.
 ROADWAY PLAN AND PAVEMENT
 MARKING PLAN

SCALE: VERT. 1"=50'
 HORIZ. 1"=50'

DATE _____ DRAWN BY _____
 CHECKED BY _____