

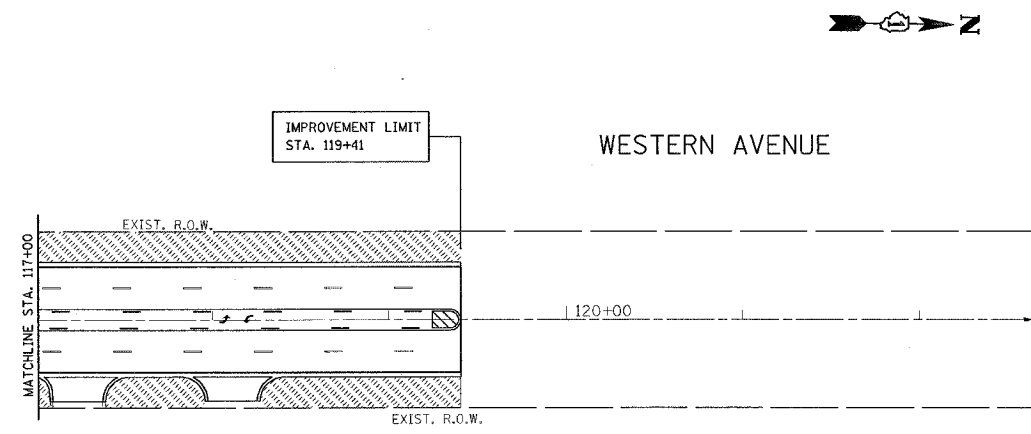

\*REF-pmk08  
\*REF-pmk09

CONTRACT NO. 62742

F.A. RTE.	SECTION	COUNTY	TOTAL SHEETS	SHEET NO.
2845	3152 WRS	COOK	195	78
STA. 102+00		TO STA. 119+41		
FED. ROAD DIST. NO.		ILLINOIS	FED. AID PROJECT	

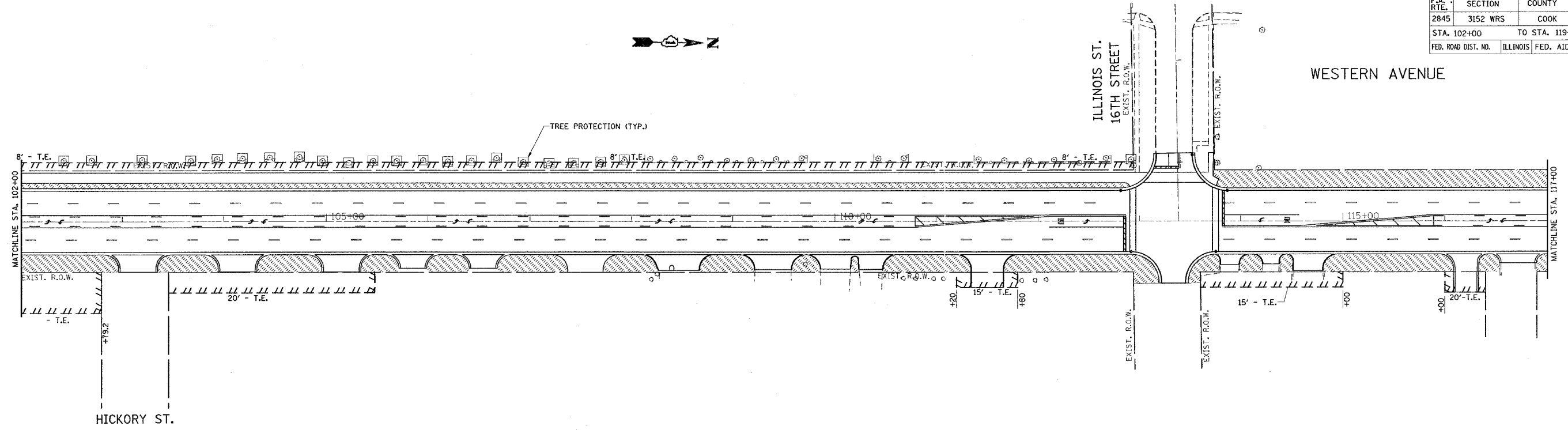

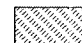
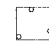
**LEGEND**

-  SODDING, SALT TOLERANT
-  TREE PROTECTION WITH TEMPORARY FENCE
-  PROPOSED TREE

REVISIONS	
NAME	DATE

ILLINOIS DEPARTMENT OF TRANSPORTATION

**WESTERN AVENUE  
PROPOSED LANDSCAPING  
PLAN**

SCALE: VERT. 1"=50'  
HORIZ. 1"=50'

DATE 6/28/2007

DRAWN BY  
CHECKED BY

PLOT DATE = 6/28/2007  
FILE NAME = c:\projects\144699\ah\landscape\p.dgn  
SCALE = 1/8" = 1'-0"  
REFERENCE = REF#8