

PREPARED BY:  
**CEMCON, L4**  
 Consulting Engineers, Land Surveyors & Planners  
 2280 White Oak Circle, Suite 100  
 Aurora, Illinois 60504-9575  
 E-Mail: info@cemcon.com Website: www.cemcon.com

F.A.U. RTE.	SECTION	COUNTY	TOTAL SHEETS	SHEET NO.
2845	3152WRS	COOK	195	129
STA.	TO STA.			
FED. ROAD DIST. NO.	ILLINOIS	FED. AID PROJECT		
			CONTRACT NO.	62742



**TRAFFIC SIGNAL LEGEND**

- |   |                 |
|---|-----------------|
| <b>PROPOSED</b>   | <b>EXISTING</b> |
| CONTROLLER  | [Symbol]        |
| SERVICE INSTALLATION  | [Symbol]        |
| SIGNAL HEAD   | [Symbol]        |
| SIGNAL HEAD WITH BACKPLATE                                  | [Symbol]        |
| SIGNAL HEAD, PEDESTRIAN                                     | [Symbol]        |
| SIGNAL POST   | [Symbol]        |
| STEEL MAST ARM ASSEMBLY AND POLE                            | [Symbol]        |
| MAST ARM ASSEMBLY AND POLE, ALUMINUM                        | [Symbol]        |
| STEEL COMBINATION MAST ARM ASSEMBLY AND POLE WITH LUMINAIRE | [Symbol]        |
| UNIT DUCT   | [Symbol]        |
| COMMON TRENCH   | [Symbol]        |
| HANDHOLE  | [Symbol]        |
| HEAVY DUTY HANDHOLE   | [Symbol]        |
| DOUBLE HANDHOLE   | [Symbol]        |
| G.S. CONDUIT IN TRENCH (T) OR PUSHED (P)                    | [Symbol]        |
| PEDESTRIAN PUSH-BUTTON DETECTOR                             | [Symbol]        |
| DETECTOR LOOP, TYPE I                                       | [Symbol]        |
| CAST IRON JUNCTION BOX                                      | [Symbol]        |
| EMERGENCY VEHICLE SYSTEM DETECTOR                           | [Symbol]        |
| CONFIRMATION BEACON   | [Symbol]        |
| SIGNAL HEAD OPTICALLY PROGRAMMED                            | [Symbol]        |
| CONDUIT SPLICE  | [Symbol]        |
| WOOD POLE   | [Symbol]        |
| RACEWAY FOR MAGNETIC DETECTOR, TYPE I OR TYPE II            | [Symbol]        |
| VEHICLE DETECTOR, NON COMPENSATED MAGNETIC TYPE             | [Symbol]        |
| RAILROAD CONTROL CABINET                                    | [Symbol]        |
| TELEPHONE CONNECTION  | [Symbol]        |
| ILLUMINATED SIGN "NO LEFT TURN"                             | [Symbol]        |
| ILLUMINATED SIGN "NO RIGHT TURN"                            | [Symbol]        |

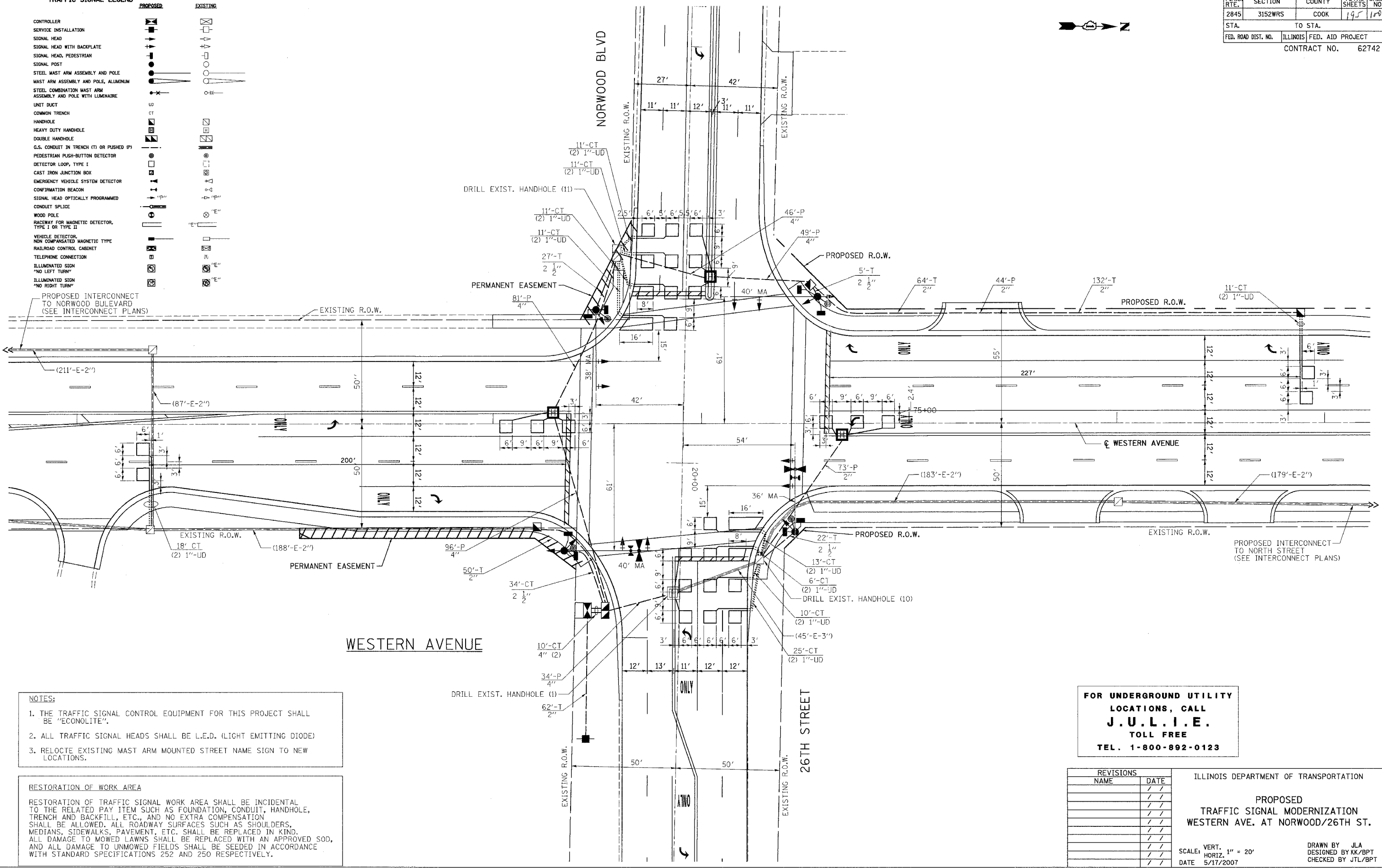

**NOTES:**

1. THE TRAFFIC SIGNAL CONTROL EQUIPMENT FOR THIS PROJECT SHALL BE "ECONOLITE".
2. ALL TRAFFIC SIGNAL HEADS SHALL BE L.E.D. (LIGHT EMITTING DIODE)
3. RELOCATE EXISTING MAST ARM MOUNTED STREET NAME SIGN TO NEW LOCATIONS.

**RESTORATION OF WORK AREA**

RESTORATION OF TRAFFIC SIGNAL WORK AREA SHALL BE INCIDENTAL TO THE RELATED PAY ITEM SUCH AS FOUNDATION, CONDUIT, HANDHOLE, TRENCH AND BACKFILL, ETC., AND NO EXTRA COMPENSATION SHALL BE ALLOWED. ALL ROADWAY SURFACES SUCH AS SHOULDERS, MEDIANS, SIDEWALKS, PAVEMENT, ETC. SHALL BE REPLACED IN KIND. ALL DAMAGE TO MOWED LAWNS SHALL BE REPLACED WITH AN APPROVED SOD, AND ALL DAMAGE TO UNMOWED FIELDS SHALL BE SEED IN ACCORDANCE WITH STANDARD SPECIFICATIONS 252 AND 250 RESPECTIVELY.

**FOR UNDERGROUND UTILITY LOCATIONS, CALL J.U.L.I.E. TOLL FREE TEL. 1-800-892-0123**

REVISIONS	
NAME	DATE

ILLINOIS DEPARTMENT OF TRANSPORTATION

**PROPOSED TRAFFIC SIGNAL MODERNIZATION WESTERN AVE. AT NORWOOD/26TH ST.**

SCALE: VERT. 1" = 20'  
 HORIZ. 1" = 20'  
 DATE 5/17/2007

DRAWN BY JLA  
 DESIGNED BY KK/BPT  
 CHECKED BY JTL/BPT

PLOT DATE = 5/18/2007  
 FILE NAME = J:\projects\322005\adgn\h4\14\_s\_Nor26b.dgn  
 USER NAME = JLA