

PREPARED BY:  
**CEMCON Ltd.**  
 Consulting Engineers, Surveyors & Planners  
 2280 White Oak Circle, Suite 100  
 Aurora, Illinois 60504-9675  
 Phone: 630-595-9100  
 Fax: 630-595-9101  
 E-Mail: info@cemcon.com Web: www.cemcon.com

F.A.U. RTE.	SECTION	COUNTY	TOTAL SHEETS	SHEET NO.
2845	3152WRS	COOK	195	118
STA.		TO STA.		
FED. ROAD DIST. NO.		ILLINOIS FED. AID PROJECT		
		CONTRACT NO. 62742		

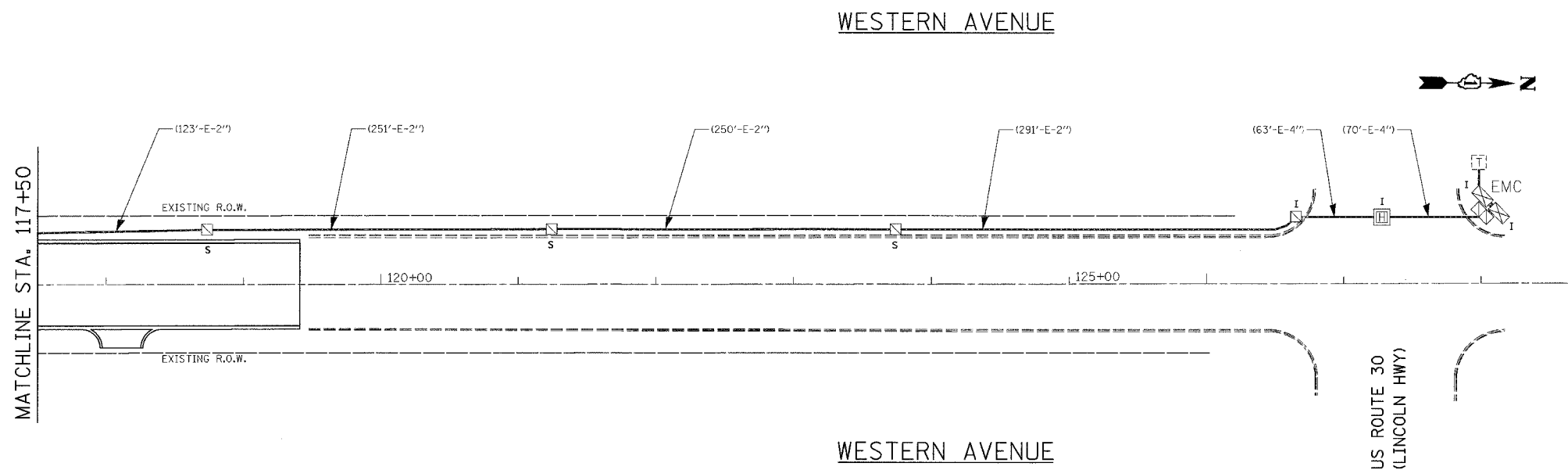
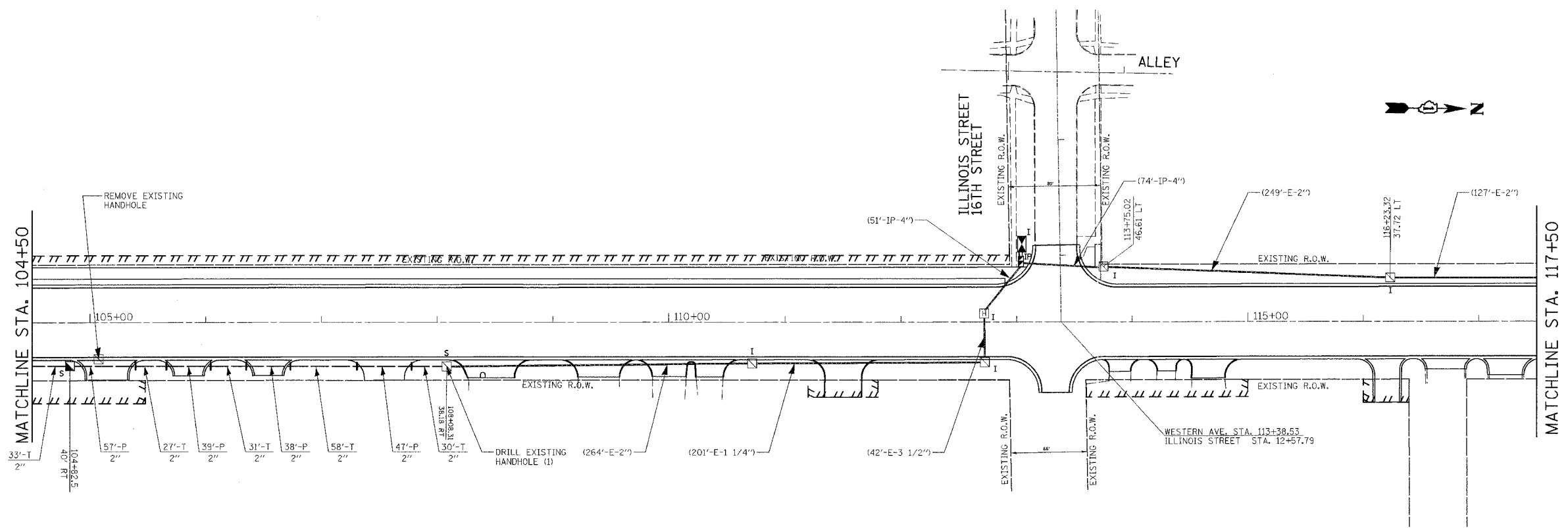

**INTERCONNECT PLAN LEGEND**

	PROPOSED	EXISTING
CONTROLLER CABINET		
SERVICE INSTALLATION, (P) POLE OR (G) GROUND MOUNT		
TELEPHONE CONNECTION		
HANDHOLE		
HEAVY DUTY HANDHOLE		
DOUBLE HANDHOLE		
G.S. CONDUIT IN TRENCH OR PUSHED		
SYSTEM	S	S
INTERSECTION	IP	I
UNIT DUCT	UD	
COMMON TRENCH	CT	
DETECTOR LOOP, TYPE I		
PERFORMED DETECTOR LOOP		

**RESTORATION OF WORK AREA**  
 RESTORATION OF TRAFFIC SIGNAL WORK AREA SHALL BE INCIDENTAL TO THE RELATED PAY ITEM SUCH AS FOUNDATION, CONDUIT, HANDHOLE, TRENCH AND BACKFILL, ETC., AND NO EXTRA COMPENSATION SHALL BE ALLOWED. ALL ROADWAY SURFACES SUCH AS SHOULDERS, MEDIANS, SIDEWALK, PAVEMENT, ETC. SHALL BE REPLACED IN KIND. ALL DAMAGE TO MOWED LAWNS SHALL BE REPLACED WITH AN APPROVED SOO, AND ALL DAMAGE TO UNMOWED FIELDS SHALL BE SEEDED IN ACCORDANCE WITH STANDARD SPECIFICATIONS 252 AND 250 RESPECTIVELY.

**REVISIONS**

NAME	DATE

ILLINOIS DEPARTMENT OF TRANSPORTATION  
**INTERCONNECT PLAN**  
**WESTERN AVENUE**  
**STA. 104+50 TO US ROUTE 30**  
**(LINCOLN HWY)**  
 SCALE: VERT. 1" = 50'  
 HORIZ. 1" = 50'  
 DATE: 5/17/2007  
 DRAWN BY: JLA  
 DESIGNED BY: KK/BPT  
 CHECKED BY: JTL/BPT

**FOR UNDERGROUND UTILITY LOCATIONS, CALL J.U.L.I.E. TOLL FREE TEL. 1-800-892-0123**

PLOT DATE = 5/18/2007  
 FILE NAME = J:\nrcross\3022805\1\ugr\hwh\132\_1\interc5.dgn  
 USER NAME = JLA