

F.A. RTE.	SECTION	COUNTY	TOTAL SHEETS	SHEET NO.
2845	3152 WRS	COOK	129	129
STA. 51+00		TO STA. 66+00		
FED. ROAD DIST. NO. 1 ILLINOIS FED. AID PROJECT				

LEGEND:

- EXISTING LIGHTING CONTROLLER, SINGLE DOOR
- EXISTING LIGHTING CONTROLLER AND CONCRETE PAD, TO BE REMOVED
- EXISTING ELECTRIC UTILITY POLE
- EXISTING LIGHTING UNIT TO BE REMOVED
- TEMPORARY SINGLE ARM LIGHTING UNIT 50' WOOD POLE, 15' MAST ARM, 400W LUMINAIRE, 12" BACK OF CURB SETBACK UNLESS OTHERWISE NOTED
- TEMPORARY AERIAL CABLE, 3-1/4 NO. 4 WITH MESSENGER WIRE, UNLESS OTHERWISE NOTED
- UNDERGROUND ELECTRICAL TYPE AND SIZE AS NOTED
- PROPOSED LIGHTING CONTROLLER, SINGLE DOOR
- 40' WOOD POLE
- CONTROLLER DESIGNATION
- CIRCUIT DESIGNATION
- FIXTURE SEQUENCE DESIGNATION

SERVICE INSTALLATION NOTES:

- CONTRACTOR TO VERIFY ACTUAL COMED SERVICE DROP LOCATIONS PRIOR TO STARTING WORK.
- LOCATION OF CONTROLLER IS SHOWN GRAPHICALLY, FINAL LOCATIONS SHALL BE ACCORDING TO COMED SERVICE DROP AND OTHER UTILITY LOCATIONS. CONTRACTOR TO VERIFY LOCATION WITH ENGINEER PRIOR TO STARTING WORK.

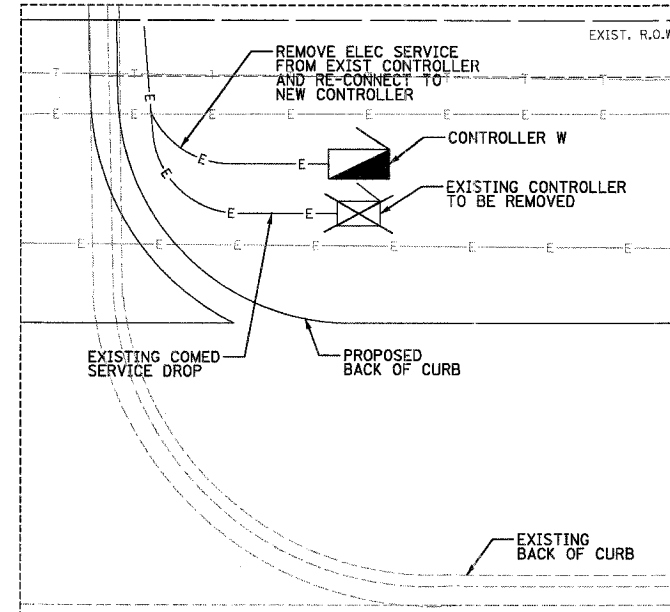

CONTROLLER W SERVICE INSTALLATION N.T.S.

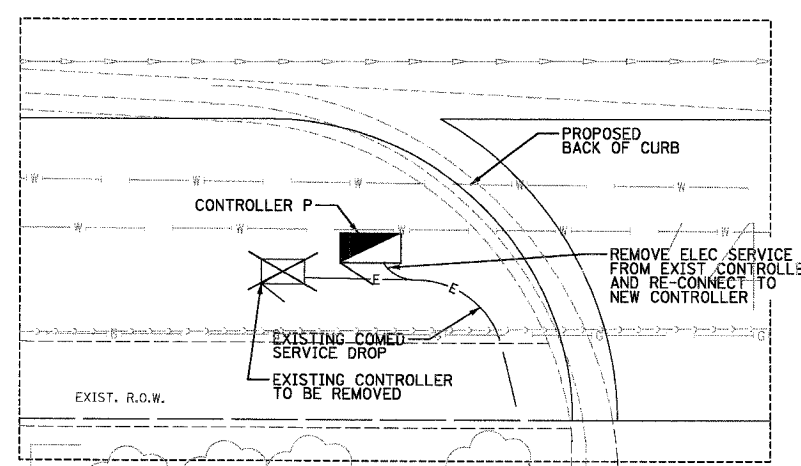

CONTROLLER P SERVICE INSTALLATION N.T.S.

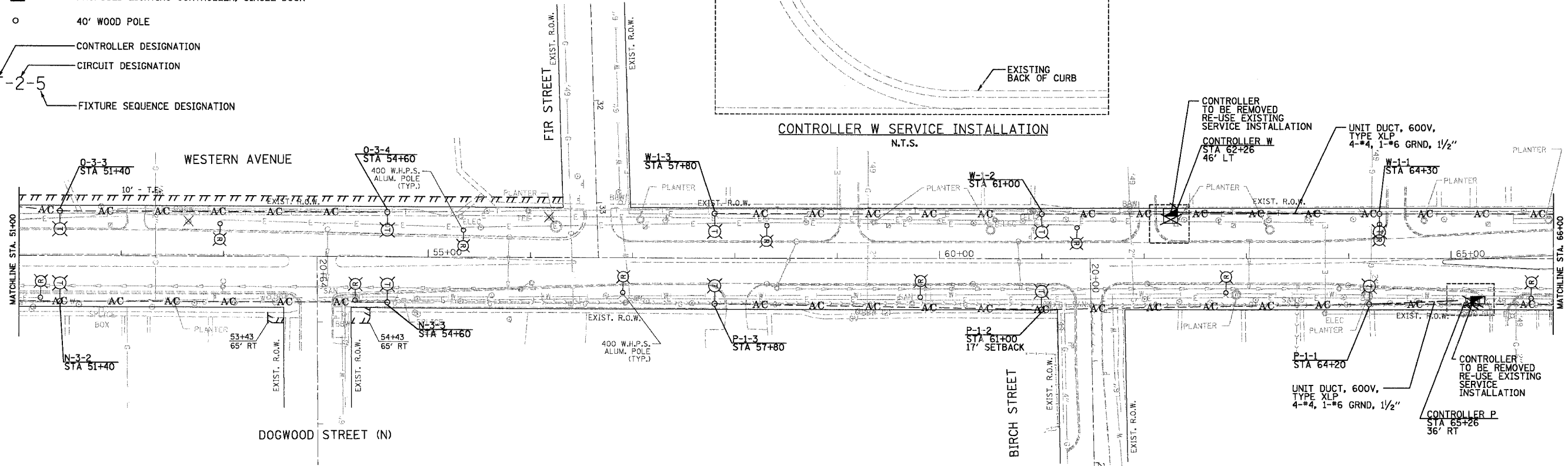

CONTROLLER TO BE REMOVED RE-USE EXISTING SERVICE INSTALLATION
 CONTROLLER W STA 62+26 46' LT
 UNIT DUCT, 600V, TYPE XLP 4-#4, 1-#6 GRND, 1/2"

CONTROLLER TO BE REMOVED RE-USE EXISTING SERVICE INSTALLATION
 CONTROLLER P STA 65+26 36' RT
 UNIT DUCT, 600V, TYPE XLP 4-#4, 1-#6 GRND, 1/2"

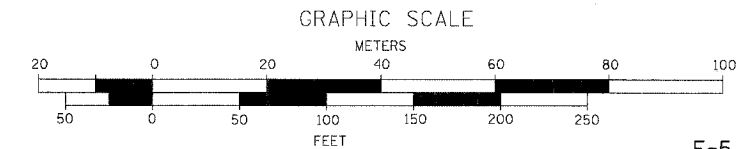

REVISIONS	
NAME	DATE

ILLINOIS DEPARTMENT OF TRANSPORTATION

WESTERN AVE. DEMOLITION, TEMPORARY LIGHTING AND ELECTRICAL SERVICE PLAN

SCALE: 1" = 50'
DATE: 1/7/07

DRAWN BY: A.P.
CHECKED BY: G.A.O.

EPSTEIN

A. EPSTEIN AND SONS INTERNATIONAL, INC.
 400 WEST FULTON STREET CHICAGO, ILLINOIS 60661-1199
 T: 312-484-9500 F: 312-484-1217 WWW.EPSTEIN-ESI.COM
 CHICAGO LOS ANGELES TEL AVIV WARSAW BUCHAREST

PLOT DATE = 5/18/2007
 FILE NAME = FILEL0
 PLOT SCALE = NSCALE0
 USER NAME = MUSER0