



PLAN	DRAWN	DATE
	CHECKED	
	BY	
	NO. OF PAGES	
	FILE NAME	
	NO.	

PROFILE	DRAWN	DATE
	CHECKED	
	BY	
	NO. OF PAGES	
	FILE NAME	
	NO.	

CONTRACT NO. 74166

FAP RTE	SECTION	COUNTY	TOTAL SHEETS	SHEET NO.
716	(130BR-1)B-1	MACON	95	12
STA. 126+50		TO STA. 132+50		
FED. ROAD DIST. NO.		ILLINOIS FED. AID PROJECT		

SEC. 4, T16N, R2E, 3RD P.M.

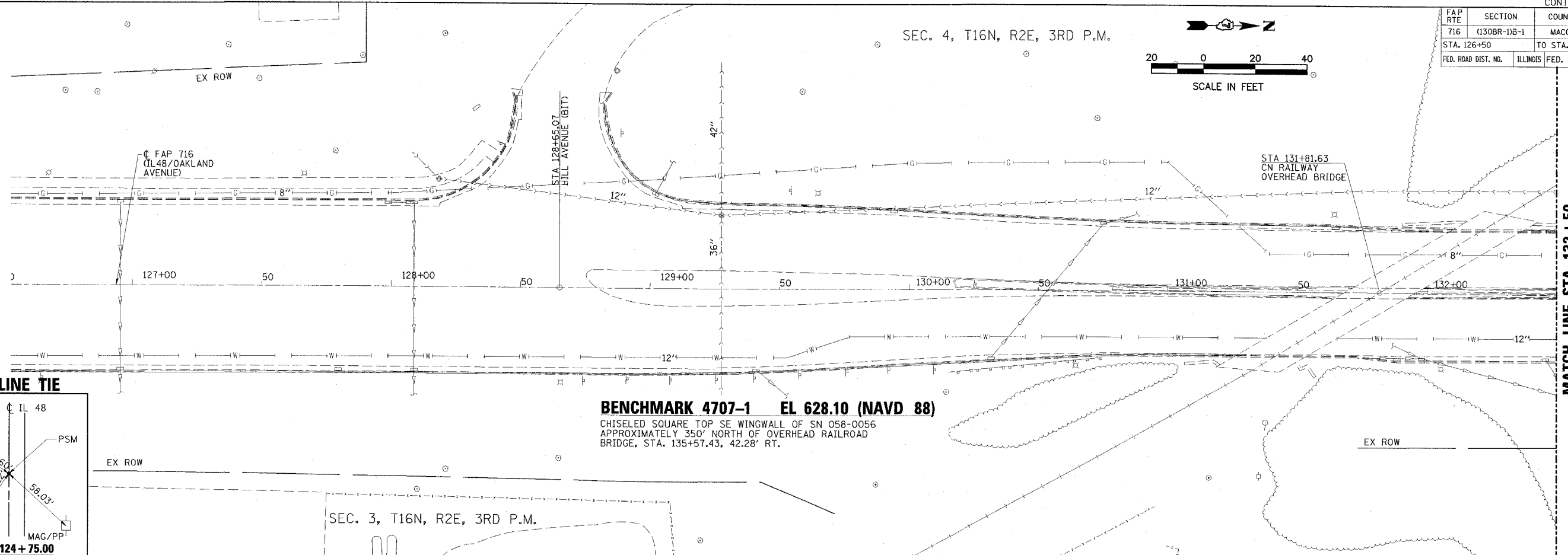
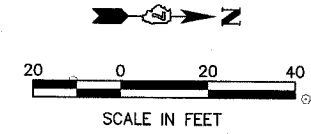

CENTERLINE TIE

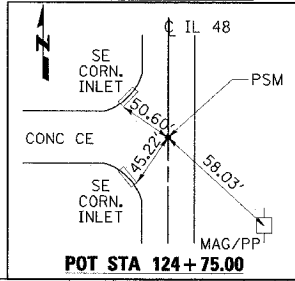

BENCHMARK 4707-1 EL 628.10 (NAVD 88)

CHISELED SQUARE TOP SE WINGWALL OF SN 058-0056 APPROXIMATELY 350' NORTH OF OVERHEAD RAILROAD BRIDGE, STA. 135+57.43, 42.28' RT.

MATCH LINE STA 132+50
SEE SHT. 13 FOR CONT.

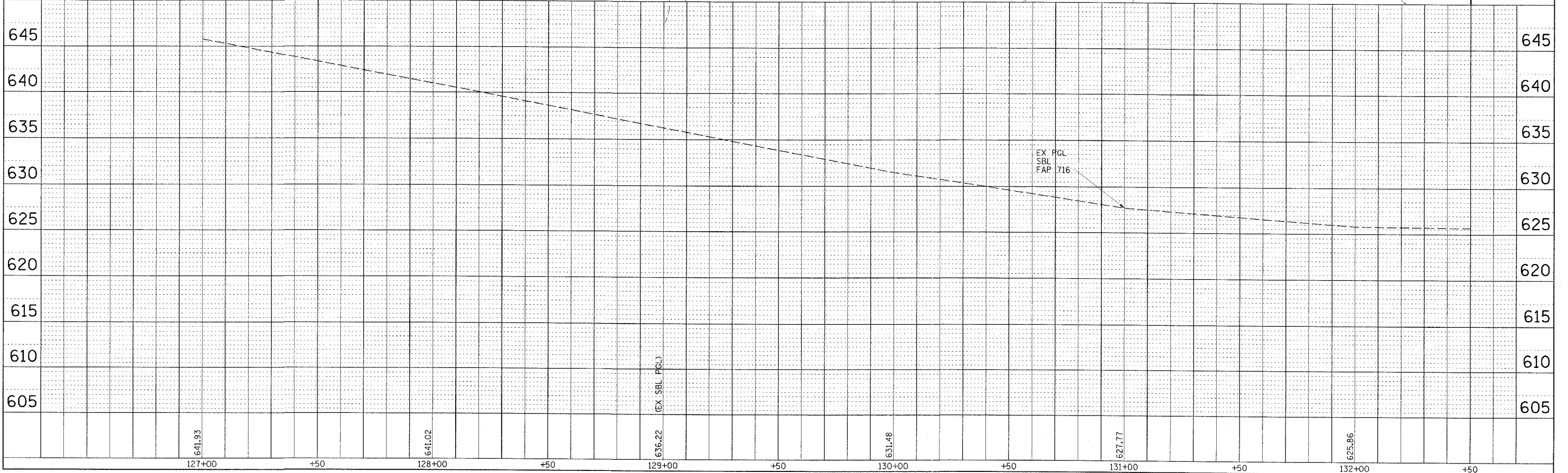

FAP 716 (ILLINOIS 48) PLAN AND PROFILE

STA 126+50 TO STA 132+50