

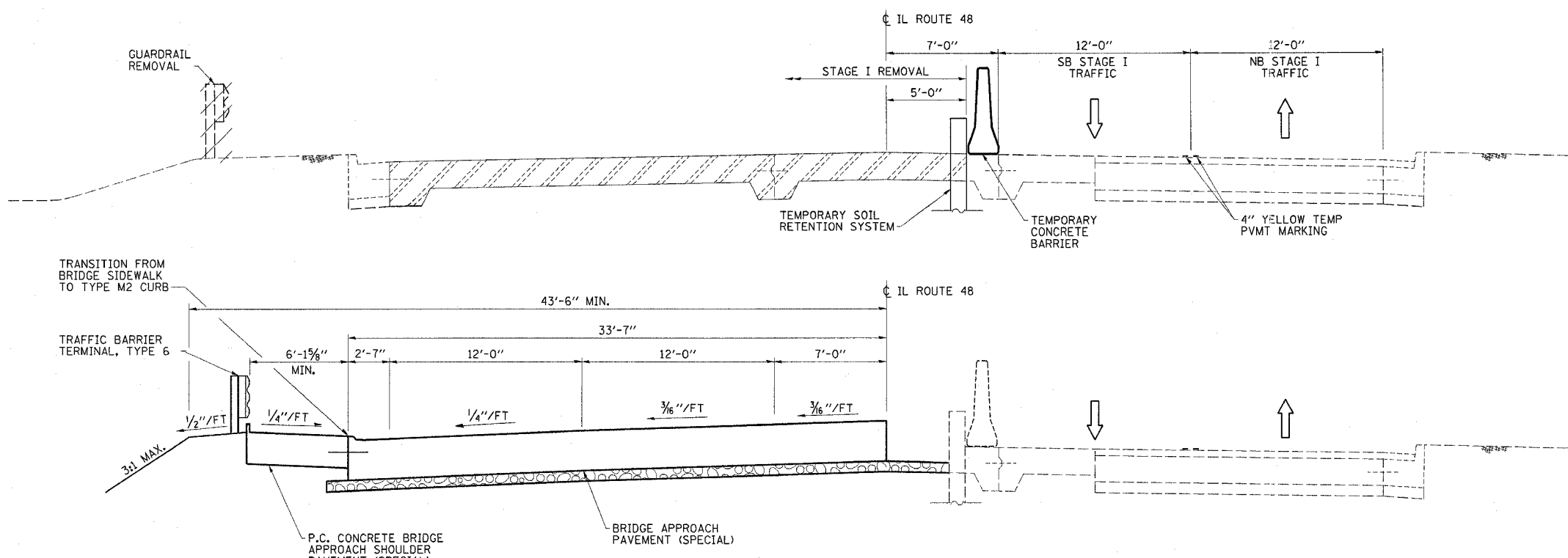

CONTRACT NO. 74166

FAP RTE	SECTION	COUNTY	TOTAL SHEETS	SHEET NO.
716	(130BR-1)B-1	MACON	95	21
STA.		TO STA.		
FED. ROAD DIST. NO.	ILLINOIS	FED. AID PROJECT		



SECTION A-A
(LOOKING NORTH)

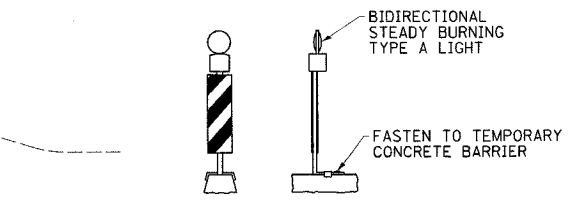

NOTE: STEADY BURNING LIGHTS AND DOUBLE VERTICAL PANELS ON 25' CENTERS ON TAPERED PORTION OF BARRIER ONLY.

VERTICAL PANELS

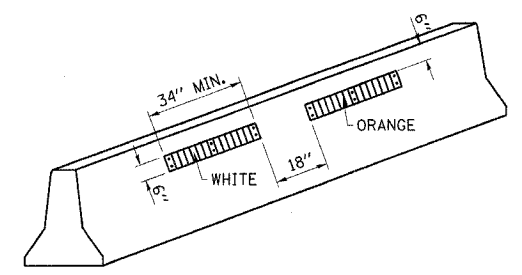

LINEAR DELINEATION PANELS

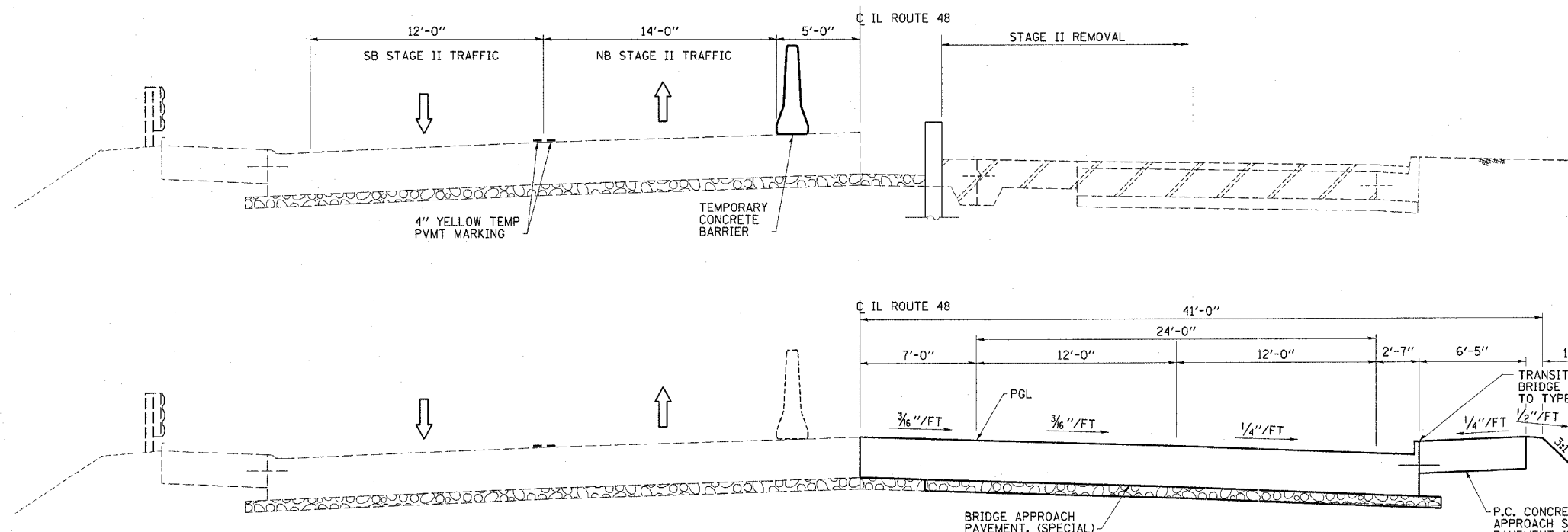

SECTION C-C
(LOOKING NORTH)

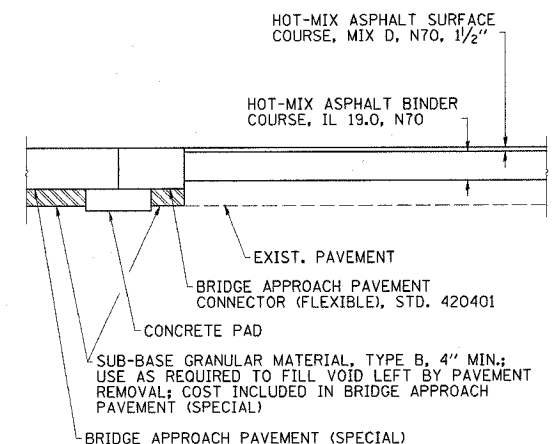

SECTION B

ESCA
CONSULTANTS, INC.

DESIGNED BY:	ELH	05/07
DRAWN BY:	HAG	05/07
CHECKED BY:	ELH	06/07
APPROVED BY:	RDP	06/07

STAGE CONSTRUCTION DETAILS
FAP ROUTE 716 (IL 48)
OAKLAND AVENUE
SECTION (130BR-1)B-1
MACON COUNTY