

CONTRACT NO. 74166

FAP RTE	SECTION	COUNTY	TOTAL SHEETS	SHEET NO.
716	(130BR-1)B-1	MACON	95	23
STA. 132+50		TO STA. 141+00		
FED. ROAD DIST. NO.	ILLINOIS	FED. AID PROJECT		

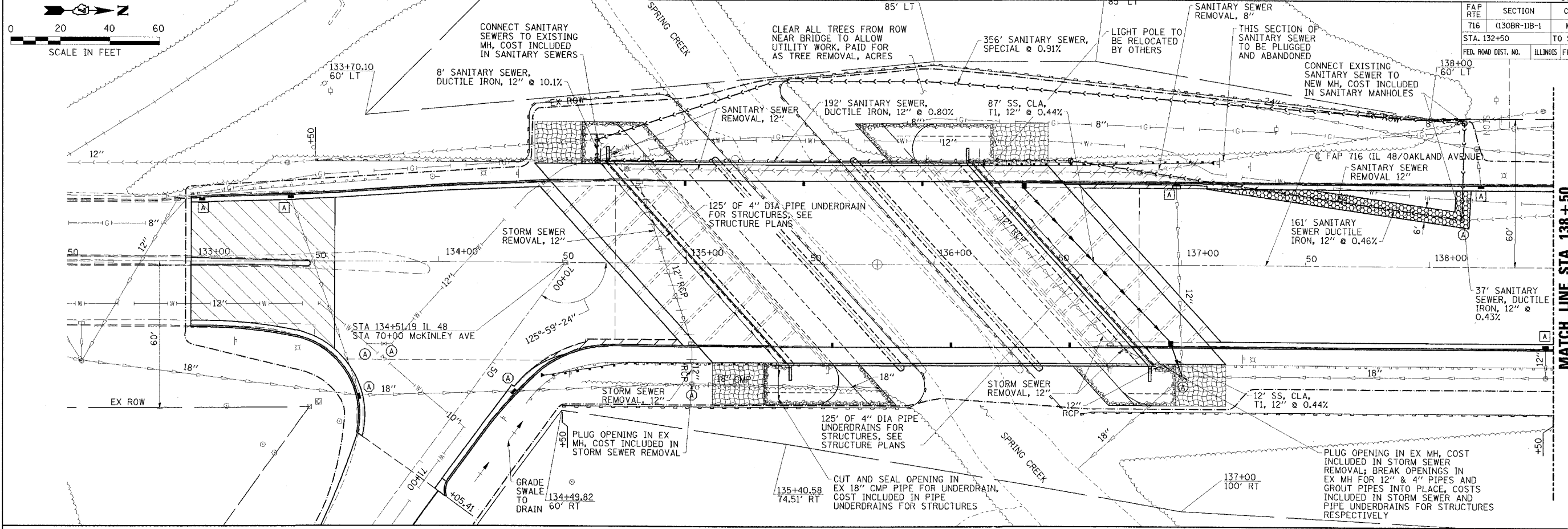

MATCH LINE STA 138 + 50

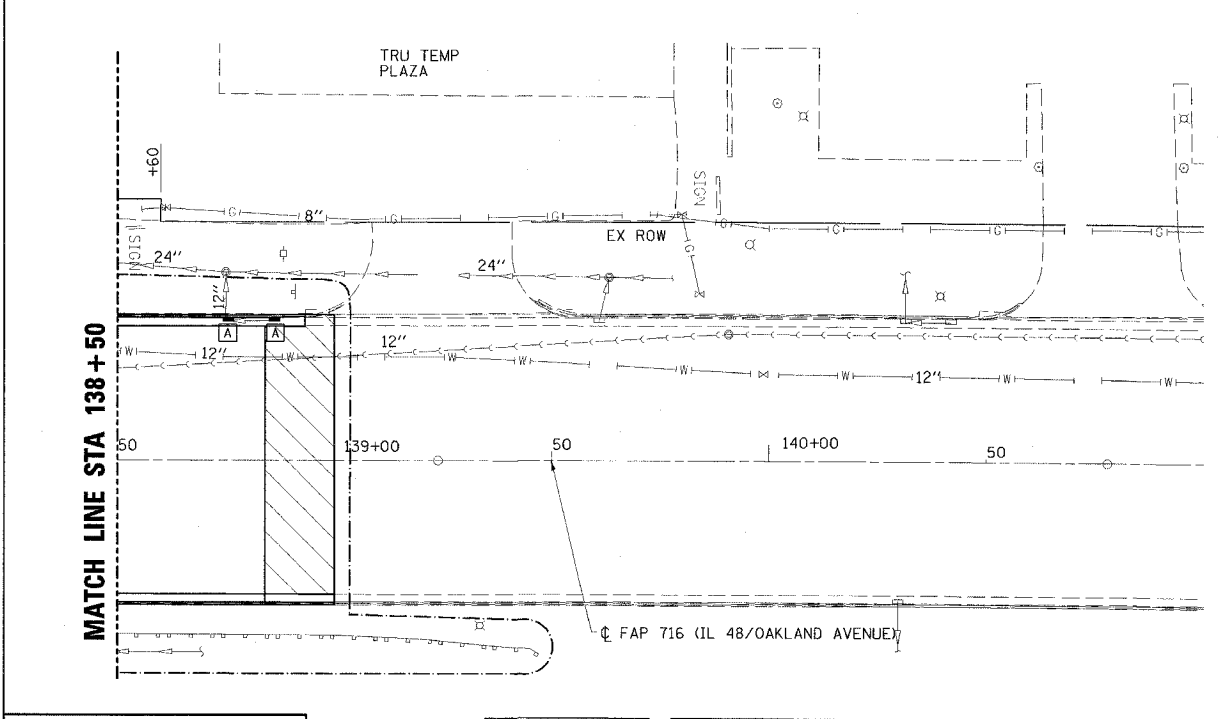

MATCH LINE STA 138 + 50

UTILITY STRUCTURE SCHEDULE

STA 133+04, 25.64' LT NEW T11V F&G P&G (SPL) EL 625.37	STA 136+13, 32' LT CB TO BE REMOVED EX EL 627.28 INV. 624.11 EX 12" SS (OUT) E	STA 138+14, 20' LT SAN MH TO BE REMOVED SAN MH 4' DIA. TIF CLID RIM EL 631.28 INV. 628.50 EX 12" SAN (IN) N INV. 627.60 12" SAN (IN) W INV. 627.60 12" SAN (OUT) S
STA 133+40, 26.72' LT CB TO BE ADJUSTED WITH NEW T11V F&G EL 625.64	STA 136+36.26, 32.17' LT TB INLET BOX, STD 609006 (SPL) EL 628.78 INV. 626.20 12" SS (OUT) E	STA 138+14, 57' LT SAN MH 4' DIA. TIF CLID RIM EL 633.90 INV. 627.76 EX 8" SAN (IN) N INV. 627.76 12" SAN (OUT) E
STA 133+68, 54.2' RT MH TO BE ADJUSTED WITH F&G (SPL) EL 625.65	STA 136+55, 42' LT SAN MH 4' DIA. TIF CLID RIM EL 629.30 INV. 626.86 12" SAN (IN) N INV. 626.86 12" SAN (OUT) S	STA 138+21, 32.76' LT CB TO BE ADJUSTED WITH NEW T11V F&G EL 631.30
STA 133+81, 40' RT VALVE BOX TO BE ADJUSTED	STA 136+72, 32' RT CB TO BE REMOVED EX EL 628.03 INV. 623.53 EX 12" SS (IN) W INV. 623.45 EX 12" SS (OUT) NE	STA 138+47, 32.76' RT CB TO BE ADJUSTED WITH NEW T11V F&G EL 631.96
STA 133+81, 28' RT VALVE BOX TO BE ADJUSTED	STA 136+83, 37' LT SAN MH TO BE REMOVED	STA 138+75, 32.76' LT CB TO BE ADJUSTED WITH NEW T11V F&G EL 632.76
STA 134+30, 51.3' RT MH TO BE ADJUSTED WITH F&G (SPL) EL 626.16	STA 136+95.69, 31.92' RT TB INLET BOX, STD 609006 (SPL) EL 629.66 INV. 625.80 12" SS (IN) W INV. 625.74 12" SS (OUT) E	STA 138+86, 32.76' LT CB TO BE ADJUSTED WITH NEW T11V F&G EL 633.09
STA 134+60, 42' LT SAN MH 4' DIA. TIF CLID RIM EL 627.85 INV. 625.40 12" SAN (IN) N INV. 625.40 12" SAN (OUT) W	STA 136+96, 32.56' LT CB TO BE ADJUSTED WITH NEW T9 F&G EL 629.28	
STA 134+76, 38' LT SAN MH TO BE REMOVED	STA 137+00, 45' RT MH TO BE ADJUSTED RIM EL 626.90 INV. 621.93 EX 12" SS (IN) W INV. 625.68 12" SS (IN) W INV. 621.53 EX 18" SS (IN) N INV. 621.00 4" PU (IN) SW INV. 619.33 EX 18" SS (OUT) SE	
STA 134+81, 32' LT CB TO BE REMOVED EX EL 626.42 INV. 623.34 EX 12" SS (OUT) E		
STA 135+02, 32' RT CB TO BE REMOVED EX EL 626.43 INV. 622.68 EX 12" SS (IN) W INV. 622.51 EX 12" SS (OUT) E		
STA 135+02, 49' RT MH TO BE ADJUSTED RIM EL 625.90		

LEGEND

- PERIMETER EROSION BARRIER
- EROSION CONTROL BLANKET
- CONSTRUCTION LIMITS
- STONE RIPRAP CLASS A4
- CATCH BASIN TO BE ADJUSTED
- MANHOLE TO BE ADJUSTED
- VALVE BOX TO BE ADJUSTED

NOTES

1. LAYOUT OF THE EROSION CONTROL ITEMS MAY BE VARIED IN THE FIELD TO SUIT CONDITIONS AS DIRECTED BY THE ENGINEER.
2. SEE SHEET 24 FOR ADDITIONAL DETAILS OF TEMPORARY AND PERMANENT SANITARY SEWER.

ESCA
CONSULTANTS, INC.

DESIGNED BY:	ELH	05/07
DRAWN BY:	HAG	05/07
CHECKED BY:	ELH	06/07
APPROVED BY:	RDP	06/07

**EROSION CONTROL, UTILITY,
AND DRAINAGE PLAN
FAP ROUTE 716 (IL 48)
OAKLAND AVENUE
SECTION (130BR-1)B-1
MACON COUNTY**