

STATE OF ILLINOIS
DEPARTMENT OF TRANSPORTATION

ROUTE NO.	SECTION	COUNTY	STATION	SHEET NO.	SHEET NO. 6 28 SHEETS
FAP 716	#	MACON	95	40	
FED. ROAD DIST. NO.		CYLINDER	PROJ. AND PROJECT		CONTRACT NO. 74166 * (130BR-1)B-1

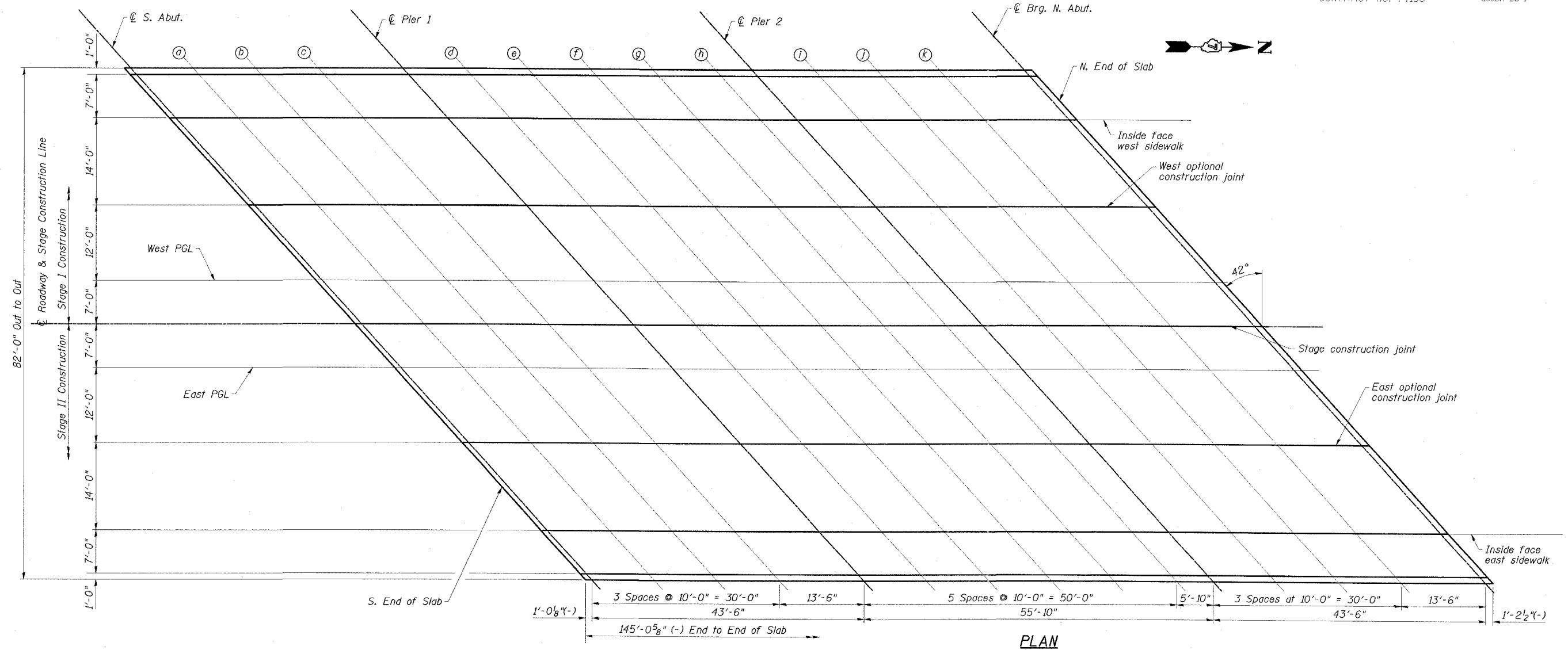

PLAN

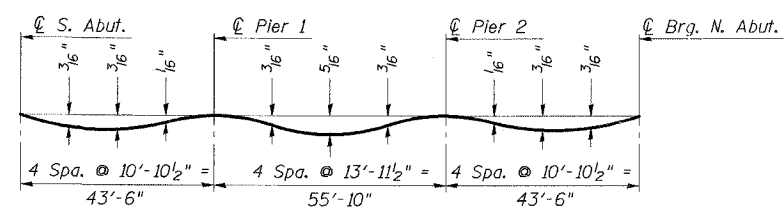

Note:
The above deflections are not to be used in the field if the Engineer is working from the grade elevations adjusted for dead load deflections as shown on Dwg. No. 7 of 28.

DEAD LOAD DEFLECTION DIAGRAM
(Includes weight of concrete only.)

TOP OF SLAB ELEVATIONS
IL ROUTE 48
OVER SPRING CREEK
FAP ROUTE 716-SECTION (130BR-1)B-1
MACON COUNTY
STATION 135+77.11
STRUCTURE NO. 058-0135

ESCA
CONSULTANTS, INC.

DESIGNED BY:	ELH	03/07
DRAWN BY:	HAS	03/07
CHECKED BY:	ELH	03/07
APPROVED BY:	RDP	03/07