

FINAL SURVEY	DATE
BY	
UNREVISED	
PLOTTED	
NOTE BOOK	
TEMPLATE	
AREAS CHECKED	

ORIGINAL SURVEY	DATE
BY	
UNREVISED	
PLOTTED	
NOTE BOOK	
TEMPLATE	
AREAS CHECKED	

FAP RTE	SECTION	COUNTY	TOTAL SHEETS	CONTRACT NO.
716	(130BR-1)B-1	MACON	95	74166
STA. 138+50.00		TO STA. 140+00.00		
FED. ROAD DIST. NO.	ILLINOIS	FED. AID PROJECT		

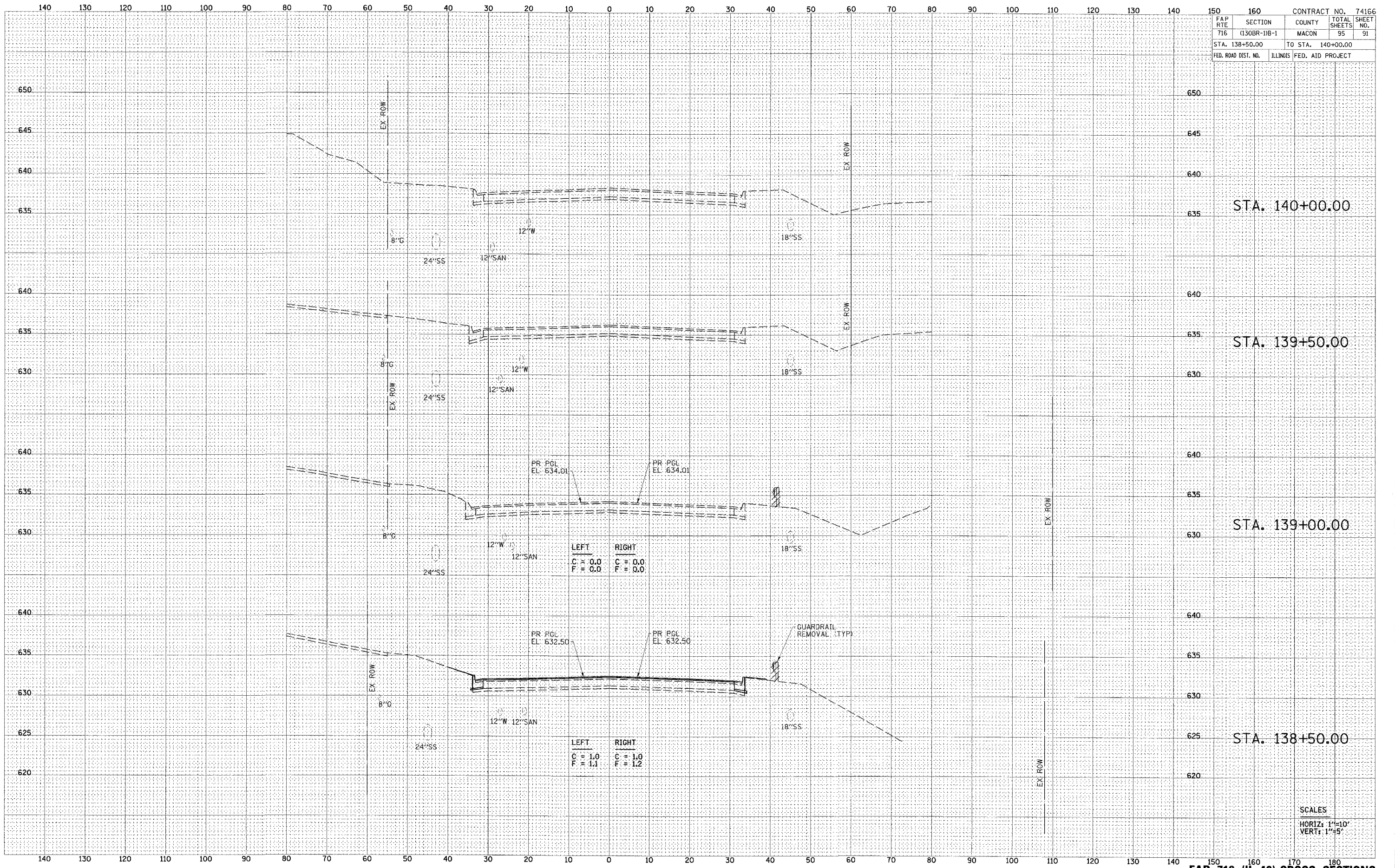

LEFT	RIGHT
C = 0.0	C = 0.0
F = 0.0	F = 0.0

LEFT	RIGHT
C = 1.0	C = 1.0
F = 1.1	F = 1.2

SCALES  
HORIZ: 1"=10'  
VERT: 1"=5'